

OKLAHOMA DEPARTMENT OF TRANSPORTATION
SURVEY DIVISION

FLOOD INFORMATION FORM

Division #:	1 <input type="checkbox"/> 2 <input type="checkbox"/> 3 <input type="checkbox"/> 4 <input type="checkbox"/> 5 <input type="checkbox"/> 6 <input checked="" type="checkbox"/> 7 <input type="checkbox"/> 8 <input type="checkbox"/>
County:	Woodward
Date Highwater occurred:	6/ 18 / 07
Highway Number:	U.S. 270
Name of Stream:	None
Direction and distance from nearest town, or highway junction	1.4 Miles S.E. of Mutual Road
Section, Township, Range:	SECTION 32 T-21-N, R-18-W
Description of Location:	Approximately 1.5' below the S. Hdwl.
Highwater Elevation:	1812.9
Level Datum & Source:	F.A.P. No. NRH 282 Sec. C US270 plans 1932
Method used:	LEVEL
Date Elevation Obtained:	6 / 21 / 07
Apparent Magnitude:	Normal <input type="checkbox"/> Medium <input checked="" type="checkbox"/> Extreme <input type="checkbox"/> Don't Know <input type="checkbox"/>
Was Highwater Mark obtained from actual water, drift, local resident, or other source?	DRIFT AND WATER MARK
Explanatory Remarks:	Heavy rain over night.

Note: Show Vicinity Map on back of form

Name (signature) Daryl Williams
Name (Printed) Daryl Williams PLS 1444
Date: 6/24/07, 2007

MUTUAL QUADRANGLE

OKLAHOMA

7.5' QUOTE SERIES (TOPOGRAPHIC)

184 R. 19 W. R. 18 W.

10'

1 660 000 FEET

34 MI. TO JUNC. U.S. 183 & 270
WOODWARD 20 MI.

488

99°07'30"

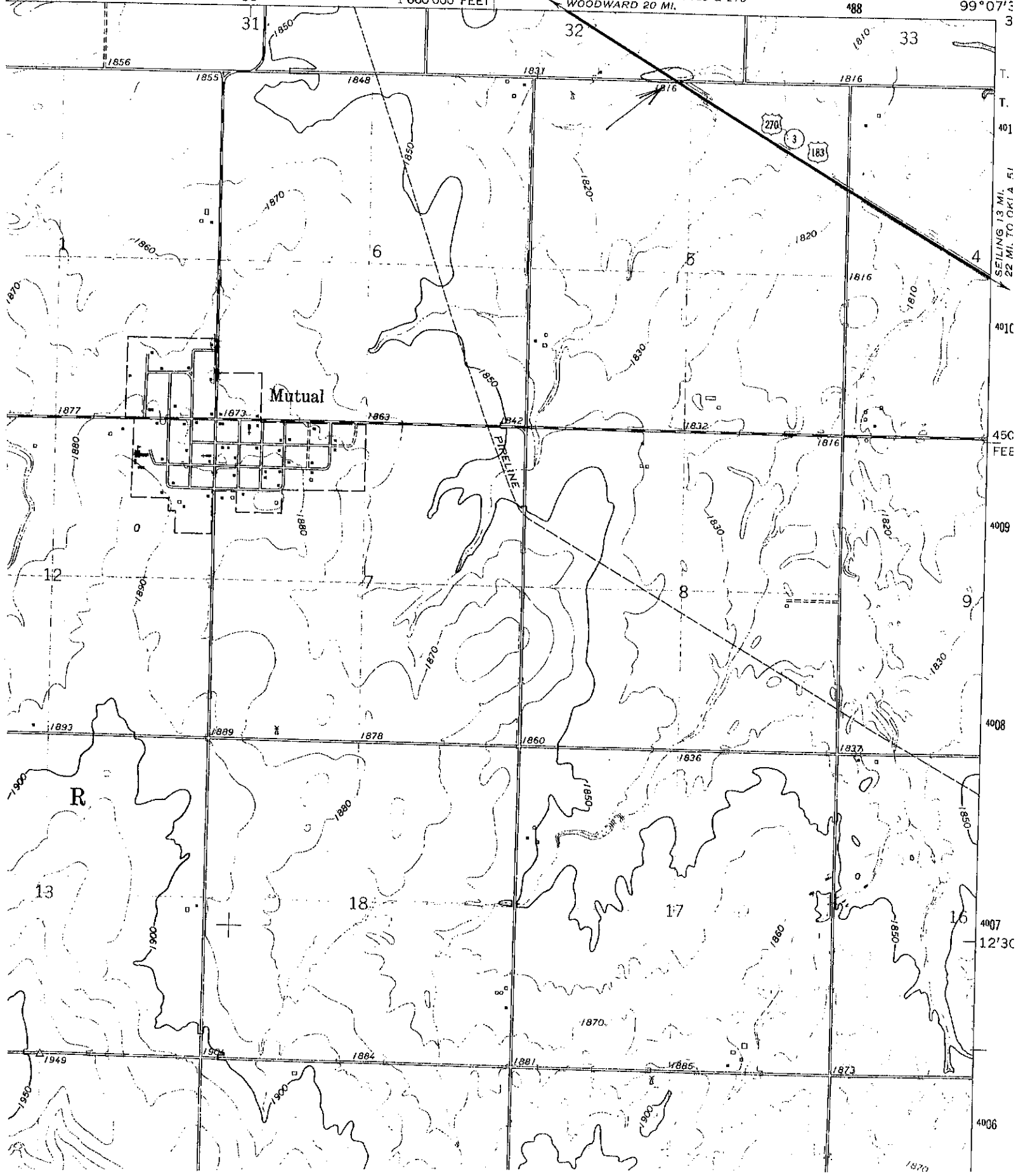

T. 401
T. 401C
450
4009
4008
4007
12'30"
4006

Mutual

ELKLINE

R

+