

RECEIVED

Plans & Survey Dept.
Form No. 16
Rev. July 10, 1947

STATE OF OKLAHOMA
DEPARTMENT OF HIGHWAYS
PLANS AND SURVEY DEPARTMENT

SURVEY DIVISION

FLOOD INFORMATION FORM

To be used in obtaining and transmitting flood water elevations for Plans & Survey office record files. This information to be obtained by all Chiefs of Party in their vicinity in times of unusual high water, or at any time available from a reliable source. The elevations can be recorded by level reading, by measurement from bridge floor, in relation to a house, above roadbed or any other dependable, clear manner that fits the situation, the highest order possible to be used. Separate report to be made on each crossing or place obtained.

County Washington Date highwater occurred May 7, 1961

Highway number SH 10 Name of stream Little Caney River

Direction and distance from nearest town, village or store approximately 2 miles west of Copan on present SH 10.

Section, Township and Range Sec. 19, T-28-N, R-13-E.

Description of Location At the present SH 10 timber floored bridge across Little Caney River approximately 2 miles west of Copan.

Method obtained Wye Level
3.6 below N.W. Conc.

Elevation Pier of Br. (BM) Source of levels BM = Top N.W. Conc Pier on pres. SH 10 bridge across Little Caney River 2 miles W. of Copan.

Was highwater mark obtained from actual water, drift, local resident, U. S. Engineers, etc? From water and silt marks on pav. etc after water has subsided some.

Personnel: A. W. Opela, Rodman - C. E. Miller, Rodman

Explanatory Remarks Traffic was not blocked however there was some damage to the bridge.

Location to be shown on back of this sheet as a check.

Field Note: To be sent to Engr. of Plans & Survey (1 copy).
Office Note: To be filed in Flood Information by Counties.

Russ DeS Morano
Chief of Party

May 26, 1961

Date

Note
No Plans or survey on this Bridge
WPK

PART of CANEY RESERVOIR
NO LONGER THERE?
LOCATION NO. 3

WASHINGTON

CO.

R-12-E

R-13-E

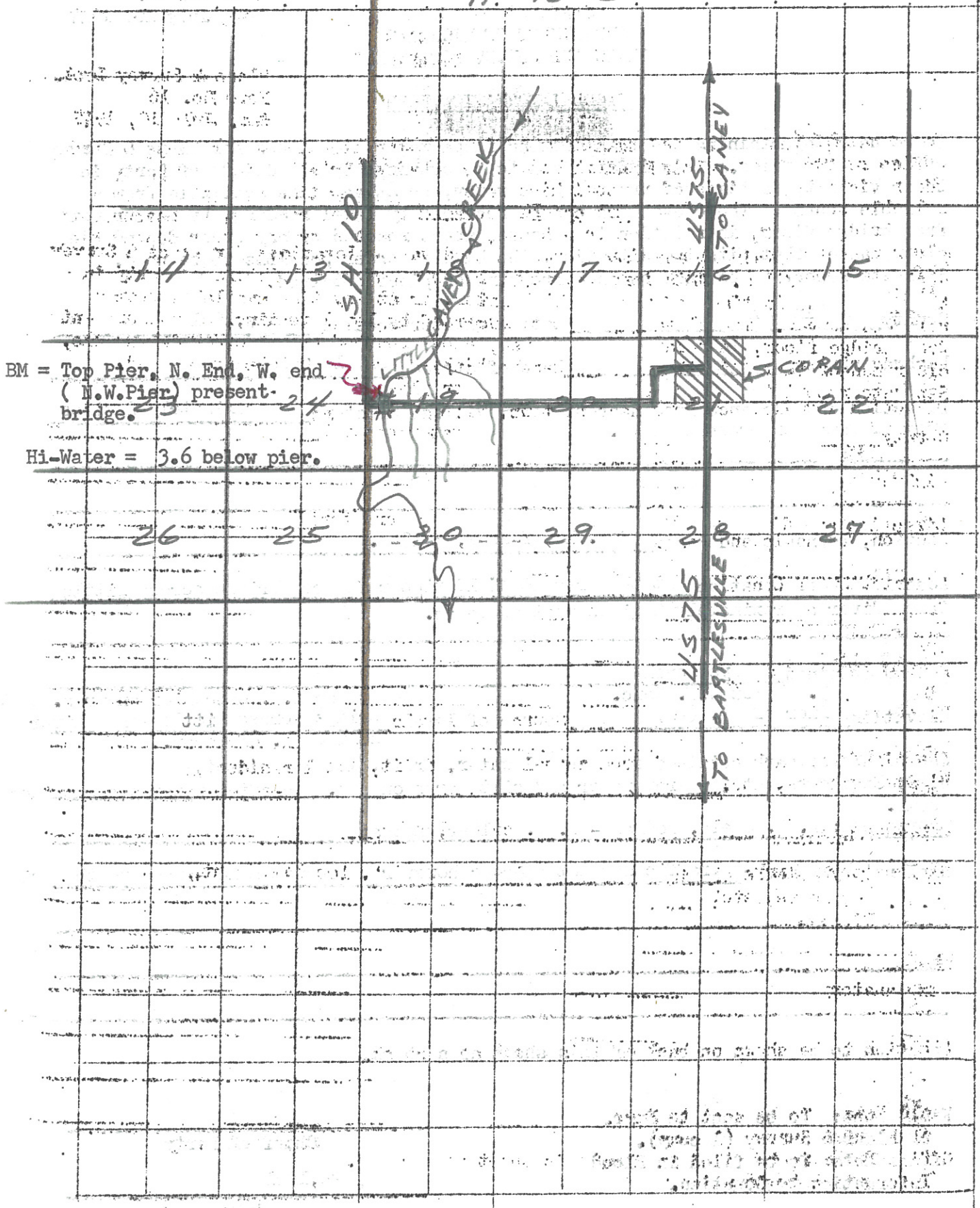

BM = Top Pier, N. End, W. end
(N.W. Pier) present
bridge.

Hi-Water = 3.6 below pier.

T
28
X

