

STATE OF OKLAHOMA  
DEPARTMENT OF HIGHWAYS  
PLANS AND SURVEY DEPARTMENT

RECEIVED  
Plans & Survey Dept.  
Form No. 16  
Rev. July 10, 1947  
SURVEY DIVISION

FLOOD INFORMATION FORM

To be used in obtaining and transmitting flood water elevations for Plans & Survey office record files. This information to be obtained by all Chiefs of Party in their vicinity in times of unusual high water, or at any time available from a reliable source. The elevations can be recorded by level reading, by measurement from bridge floor, in relation to a house, above roadbed or any other dependable, clear manner that fits the situation, the highest order possible to be used. Separate report to be made on each crossing or place obtained.

County Washington Date highwater occurred May 9, 1961

Highway number US 60 Name of stream Caney River

Direction and distance from nearest town, village or store Present US 60 crossing of Caney River on east side of main town of Bartlesville.

Section, Township and Range Section 7, T-26-N, R-13-E.

Description of Location In Bartlesville on US 60 and East Phillips Blvd. at the present concrete bridge across Caney River.

Method obtained Wye. Level USCEGS  
Elevation 21.9 Ft. below EM EM = W. End Caney River Bridge as described on back of this sheet.  
EW. 669.3 Source of levels

Was highwater mark obtained from actual water, drift, local resident, U. S. Engineers, etc? Actual Water Level by this party.  
Personnel: G. Provolt, Jr. Instrumentman & A. R. Payne, Rodman.

Explanatory Remarks Present US 60 was not under water. Flooding of residential districts occurred north of bridge in low lands along river banks.

Location to be shown on back of this sheet as a check.

Field Note: To be sent to Engr. of Plans & Survey (1 copy).  
Office Note: To be filed in Flood Information by Counties.

Russ Day Moran  
Chief of Party

May 19, 1961  
Date

LOCATION NO. 4

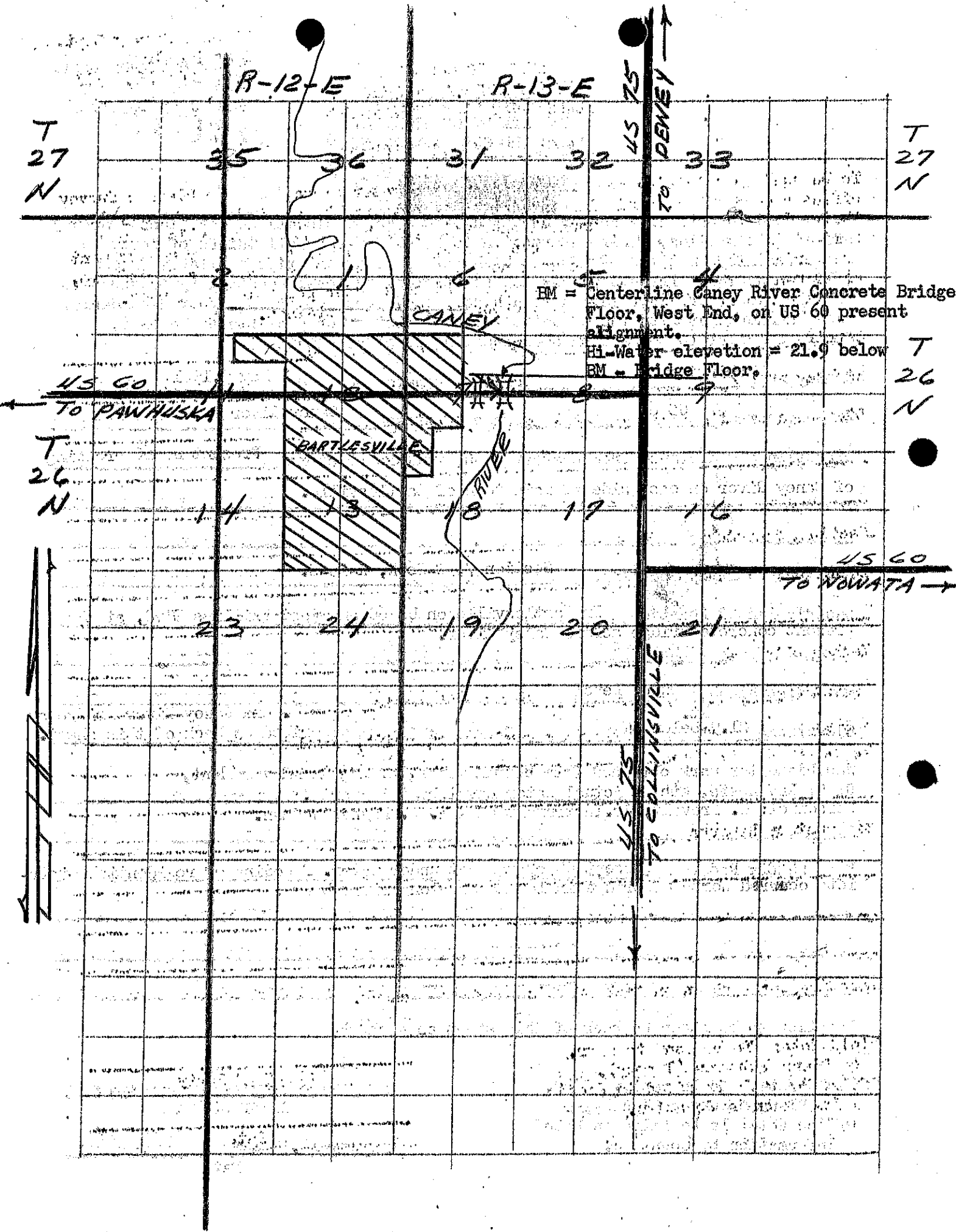

R-12-E

R-13-E

T  
27  
N

T  
27  
N

35 36 31 32 33

US 75  
TO DENNEY

BM = Centerline Caney River Concrete Bridge Floor, West End, on US 60 present alignment.  
Hi-Water elevation = 21.9 below BM = Bridge Floor.

T  
26  
N

US 60  
TO PAWBUSSKA

T  
26  
N

BARTLESVILLE

CANEY

CANEY RIVER

14 13 18 17 16

US 60  
TO NOWATA

23 24 19 20 21

US 75  
TO COLLINSVILLE