

STATE OF OKLAHOMA
DEPARTMENT OF HIGHWAYS
SURVEY DIVISION

FLOOD INFORMATION FORM

To be used in obtaining and transmitting flood water elevations for Survey Division office record files. This information to be obtained by all Chiefs of Party or others in their vicinity in times of unusual high water, or at any time available from a reliable source. The elevations can be recorded by level reading, by measurement from bridge floor, in relation to a house, above roadbed or any other dependable, clear manner that fits the situation, the highest order possible to be used. Separate report to be made on each crossing or place obtained.

County Washington Date highwater occurred April 16, 1973

Highway number US 60 Name of stream Caney River

Direction and distance from nearest town, village or store East edge of Bartlesville.

Section, Township and Range Section 7, T-26-N, R-13-E

Description of Location At present US 60 Concrete Bridge over Caney River

Elevation _____ Source of levels _____

Method obtained Measured Down with tape Date obtained April 18, 1973

25.4 Ft. from BM "X" on W. end Bridge, south walkway.

Did it appear to be normal medium extreme do not know

Was highwater mark obtained from actual water, drift, local resident, U. S. Engineers, etc.? From drift and silt left on ground south side of west end of bridge. Water had receded approx. 3 Ft. - Obtained by Moran and Basham.

Explanatory Remarks US 60 not closed to traffic or under water.

Location to be shown on back of this sheet as a check.

Field Note: To be sent to
Survey Engineer

MC: BRIDGE DIV.

Reas De Moran Jr
~~CHIEF OF PARTY~~
Location Engineer
April 23, 1973
Date

LOCATION NO. 4

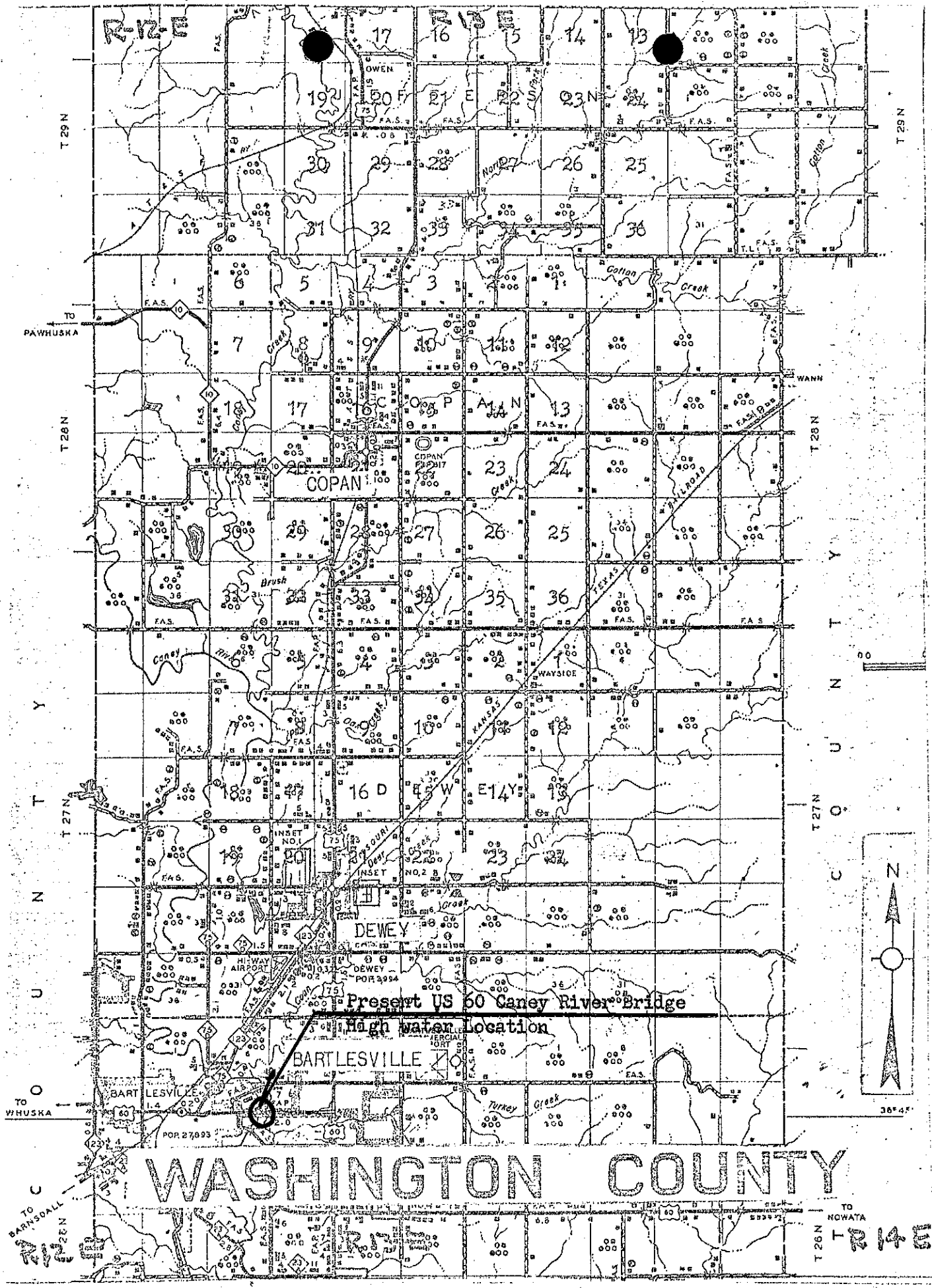

WASHINGTON COUNTY

Present US 60 Caney River Bridge
High water Location

BARTLESVILLE

DEWEY

COPAN

T 29N

T 29N

T 28N

T 28N

T 27N

T 27N

T 26N

T 26N

TO PAWHUSKA

WANN



36° 45'

TO WHUSKA

TO BARNSDALL

TO HOWATA

R 14 E