

STATE OF OKLAHOMA
DEPARTMENT OF HIGHWAYS
SURVEY DIVISION

FLOOD INFORMATION FORM

To be used in obtaining and transmitting flood water elevations for Survey Division office record files. This information to be obtained by all Chiefs of Party or others in their vicinity in times of unusual high water, or at any time available from a reliable source. The elevations can be recorded by level reading, by measurement from bridge floor, in relation to a house, above roadbed or any other dependable, clear manner that fits the situation, the highest order possible to be used. Separate report to be made on each crossing or place obtained.

County Wagoner Date highwater occurred June 19, 1980

Highway number SH 51 Name of stream Coweta Creek

Direction and distance from nearest town, village or store 2 mi. NW of Coweta.

Section, Township and Range Sec. 1, T17N-R15E

Description of Location Approx. 1000' NW of center of section 1.

Elevation 2.1' above E. Hdwl. Source of levels _____

Method obtained Wye Level & Rod Date obtained June 19, 1980

Did it appear to be normal medium extreme do not know

Was highwater mark obtained from actual water, drift, local resident, U. S. Engineers, etc.? Drift & local resident (Employees of Stans' Tire Barn, Dayton Tires)

Explanatory Remarks Approx. 6" rainfall in 3 hrs. (2:00AM-5:00AM) June 19.

Location to be shown on back of this sheet as a check.

Field Note: To be sent to
Survey Engineer

Samuel S. Sigismond
Chief of Party

June 23, 1980
Date

Location No. 13

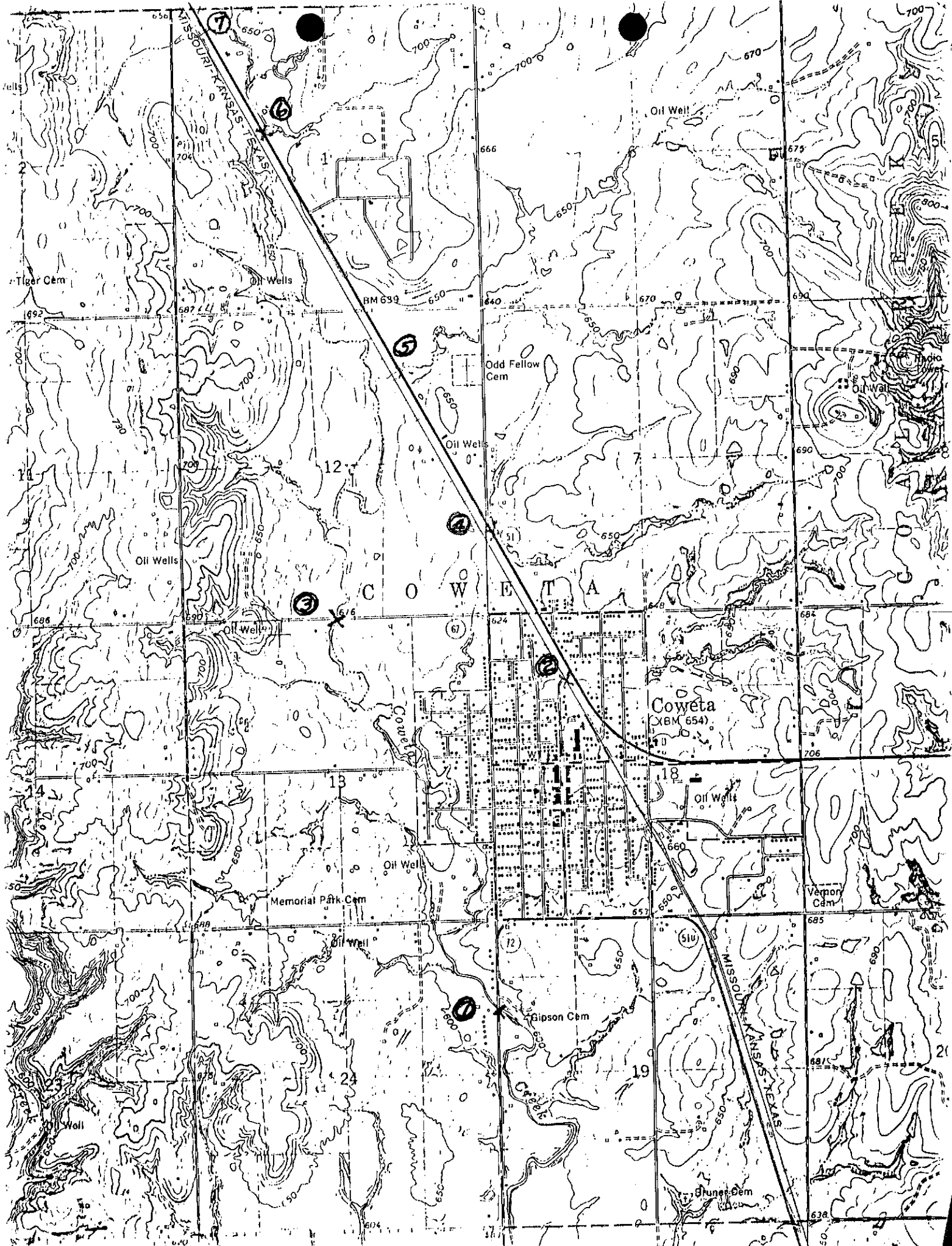

Tiger Cem

Oil Wells

Oil Wells

Oil Wells

Oil Well

Well

Oil Wells

Oil Wells

Oil Well

Oil Well

Oil Well

Oil Well

RM 639

Oil Wells

Oil Well

Oil Well

Oil Well

Oil Well

Odd Fellow Cem

Oil Wells

Oil Well

Oil Well

Oil Well

Oil Well

Oil Well

Oil Well

Oil Well

Oil Well

Oil Well

Oil Well

Oil Well

Oil Well

Oil Well

Oil Well

Oil Well

Oil Well

Oil Well

Memorial Park Cem

Sipsom Cem

Vernon Cem

Coweta

(BM 654)

Oil Well

Oil Well

Oil Well

Oil Well

Oil Well

Oil Well

Oil Well

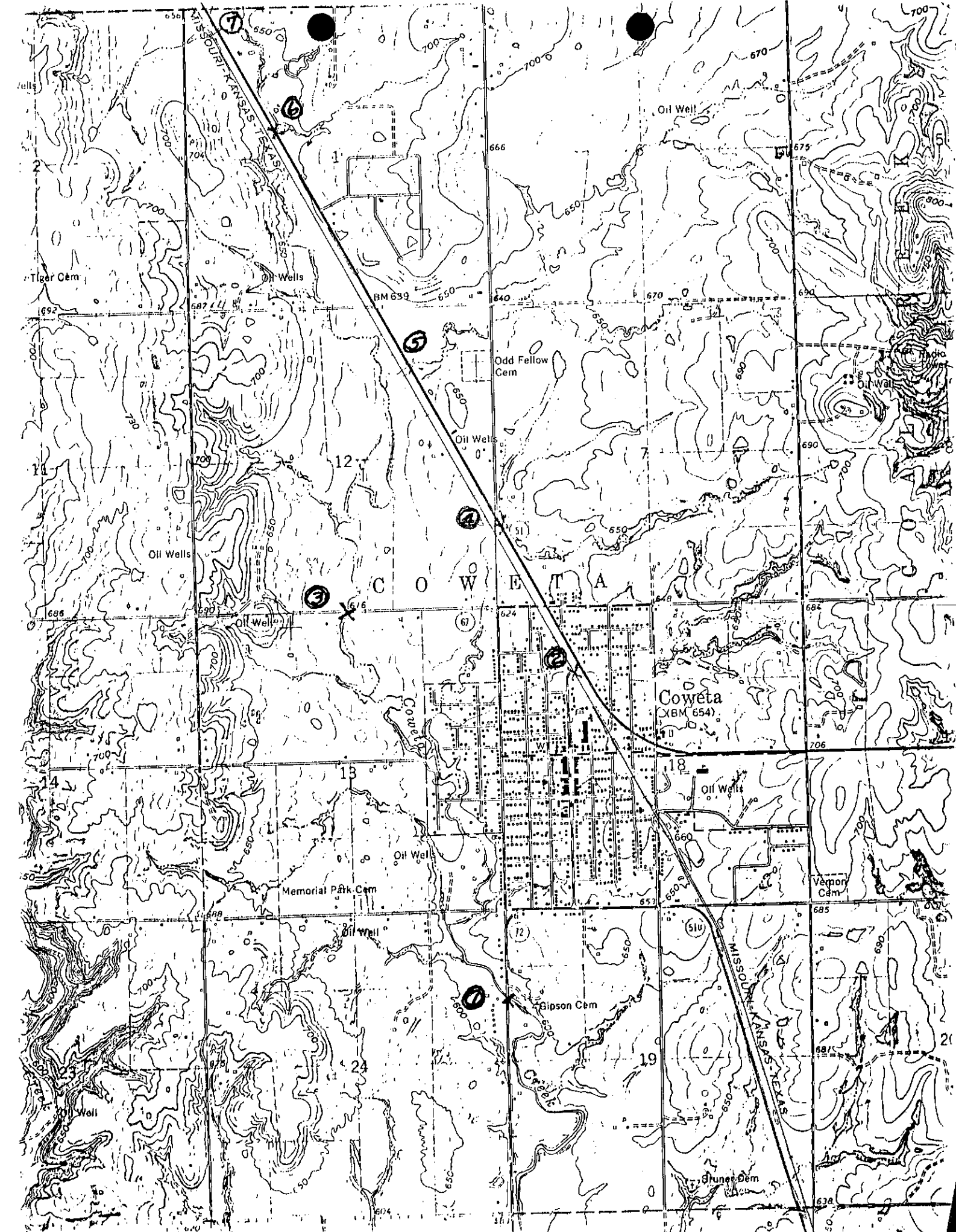

Tiger Cem

Oil Wells

Oil Wells

Oil Wells

Oil Well

Well

Oil Wells

Oil Wells

Oil Well

Oil Well

Oil Well

Oil Well

RM 639

Oil Wells

Oil Well

Oil Well

Oil Well

Oil Well

Odd Fellow Cem

Oil Wells

Oil Well

Oil Well

Oil Well

Oil Well

Oil Well

Oil Well

Oil Well

Oil Well

Oil Well

Oil Well

Oil Well

Oil Well

Oil Well

Oil Well

Oil Well

Oil Well

Oil Well

Memorial Park Cem

Sipsom Cem

Vernon Cem

Coweta

(BM 654)

Oil Well

Oil Well

Oil Well

Oil Well

Oil Well

Oil Well

Oil Well