

RECEIVED  
JUN 12 1984  
SURVEY DIVISION

Survey Division  
Form No. 16  
Rev. Dec. 2, 1974

STATE OF OKLAHOMA  
DEPARTMENT OF HIGHWAYS  
SURVEY DIVISION

FLOOD INFORMATION FORM

To be used in obtaining and transmitting flood water elevations for Survey Division office record files. This information to be obtained by all Chiefs of Party or others in their vicinity in times of unusual high water, or at any time available from a reliable source. The elevations can be recorded by level reading, by measurement from bridge floor, in relation to a house, above roadbed or any other dependable, clear manner that fits the situation, the highest order possible to be used: Separate report to be made on each crossing or place obtained.

County Wagoner Date highwater occurred May 27, 1984

Highway number SH 51F Name of stream None

Direction and distance from nearest town, village or store Approx. 2.5 miles east of Broken Arrow.

Section, Township and Range Section 7, T18N, R15E

Description of Location On south side of road at drain crossing SH 51F at Sta. 149+45 on SWO 3298(1).

Elevation 668.40 Source of levels USC&GS from bench marks estab. under SWO 3298(1).

Method obtained Fennel Level Date obtained May 29, 1984

Did it appear to be  normal  medium  extreme  do not know

Was highwater mark obtained from actual water, drift, local resident, U. S. Engineers, etc.? Fresh water marks of the actual highwater.

Explanatory Remarks \_\_\_\_\_

\_\_\_\_\_

\_\_\_\_\_

Location to be shown on back of this sheet as a check.

Field Note: To be sent to  
Survey Engineer

*James Wayne Dejeu*  
Location Engineer

June 5, 1984  
Date

*Copies sent to Bridge Div. 6-14-84  
A.Z.*

*LOCATION No. 15*

SHOW ALIGNMENT, DEGREE & LENGTH OF CURVES-SECTION, TOWNSHIP & RANGE NUMBERS-COUNTY NAMES & LINES-MAJOR STREAMS, NORTH, TOWNS & HIGHWAYS, SURVEY SECTIONS, ETC. LEGEND-PROPOSED LOCATION: RED DASHED LINE, FINAL LOCATION: SOLID RED LINE, COMPLETED SURVEY: SOLID GREEN LINE. STATION NUMBERS ON BEGINNING AND END OF SURVEY SECTIONS.

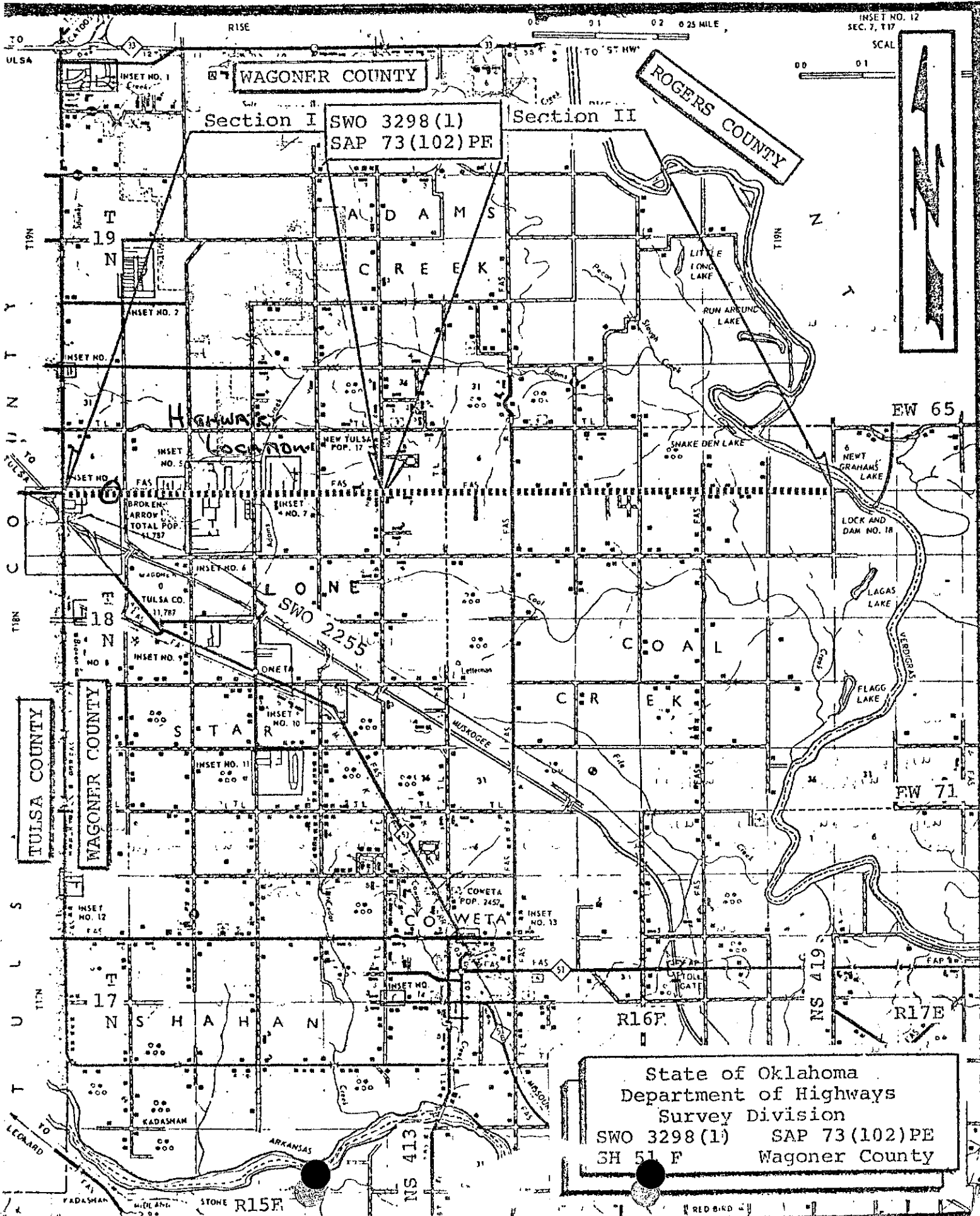

State of Oklahoma  
 Department of Highways  
 Survey Division  
 SWO 3298(1) SAP 73(102)PE  
 SH 51 F Wagoner County