

RECEIVED
DEC 4 1986
SURVEY DIVISION

STATE OF OKLAHOMA
DEPARTMENT OF HIGHWAYS
SURVEY DIVISION

Survey Division
Form No. 16
Rev. Dec. 2, 1974

FLOOD INFORMATION FORM

To be used in obtaining and transmitting flood water elevations for Survey Division office record files. This information to be obtained by all Chiefs of Party or others in their vicinity in times of unusual high water, or at any time available from a reliable source. The elevations can be recorded by level reading, by measurement from bridge floor, in relation to a house, above roadbed or any other dependable, clear manner that fits the situation, the highest order possible to be used. Separate report to be made on each crossing or place obtained.

County Wagoner Date highwater occurred October 1, 1986

Highway number SH 16 Name of stream unknown

Direction and distance from nearest town, village or store Approx. 3.9 miles south
along SH 16 from the Jct. of SH 16 & Prestolite Road in Wagoner

Section, Township and Range Section 2, T16N, R18E

Description of Location _____

Elevation _____ Source of levels _____

Method obtained Fennel Level Date obtained October 6, 1986

Did it appear to be normal medium extreme do not know

Was highwater mark obtained from actual water, drift, local resident,
U. S. Engineers, etc.? Actual water marks

Explanatory Remarks Water was 2.0 feet deep over an "X" on centerline of east head
wall of bridge at this location

Location to be shown on back of this sheet as a check.

Field Note: To be sent to
Survey Engineer

James Wayne Deppa
Location Engineer

October 9, 1986
Date

LOCATION No. 21

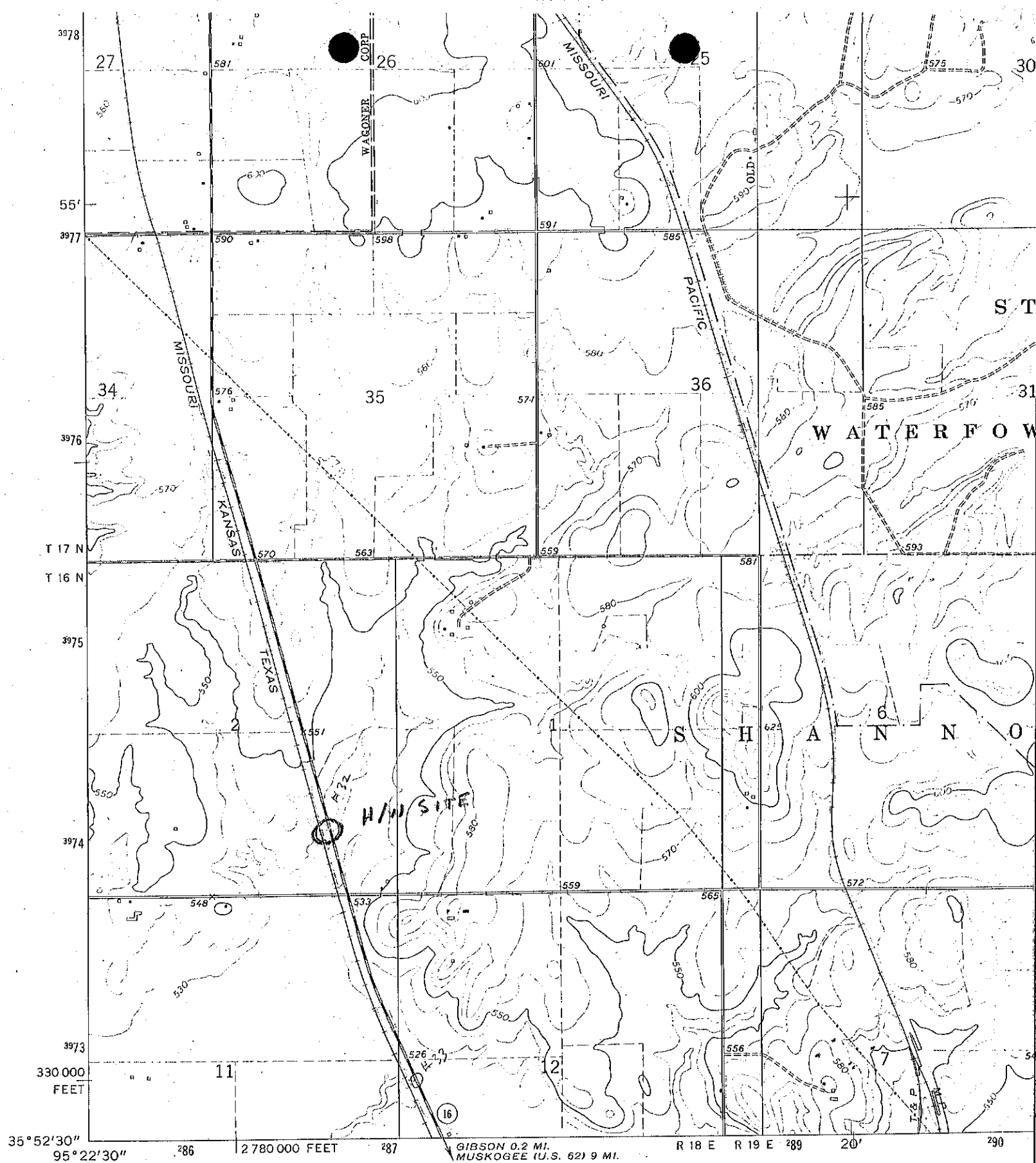

Mapped, edited, and published by the Geological Survey

Control by USGS and NOS/NOAA

Topography by photogrammetric methods from aerial photographs taken 1973. Field checked 1974

Projection and 10,000-foot grid ticks: Oklahoma coordinate system, north zone (Lambert conformal conic)

1000-metre Universal Transverse Mercator grid ticks, zone 15, shown in blue. 1927 North American datum

Red tint indicates area in which only landmark buildings are shown

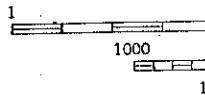
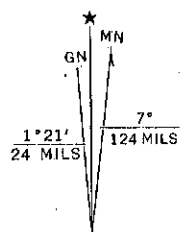

UTM GRID AND 1974 MAGNETIC NORTH

T MUSKOGEE
SW