

RECEIVED  
DEC 4 1986  
SURVEY DIVISION

Survey Division  
Form No. 16  
Rev. Dec. 2, 1974

STATE OF OKLAHOMA  
DEPARTMENT OF HIGHWAYS  
SURVEY DIVISION  
FLOOD INFORMATION FORM

To be used in obtaining and transmitting flood water elevations for Survey Division office record files. This information to be obtained by all Chiefs of Party or others in their vicinity in times of unusual high water, or at any time available from a reliable source. The elevations can be recorded by level reading, by measurement from bridge floor, in relation to a house, above roadbed or any other dependable, clear manner that fits the situation, the highest order possible to be used. Separate report to be made on each crossing or place obtained.

County Wagoner Date highwater occurred October 1, 1986

Highway number US 69 Name of stream Unknown

Direction and distance from nearest town, village or store Approx 0.7 mile south of the intersection of US 69 & SH 51 in Wagoner

Section, Township and Range In Section 16, T17N, R18E

Description of Location large RCB just north of Prestolite Road

Elevation \_\_\_\_\_ Source of levels \_\_\_\_\_

Method obtained Fennel Level Date obtained October 6, 1986

Did it appear to be  normal  medium  extreme  do not know

Was highwater mark obtained from actual water, drift, local resident, U. S. Engineers, etc.? Actual water marks

Explanatory Remarks Water was 1.1 foot over the top of the centerline of the west headwall of the RCB at this location.

Location to be shown on back of this sheet as a check.

Field Note: To be sent to Survey Engineer

James Wayne Deane  
Location Engineer  
October 9, 1986  
Date

LOCATION No. 22

WAGONER WEST QUADRANGLE  
OKLAHOMA—WAGONER CO.  
7.5 MINUTE SERIES (TOPOGRAPHIC)

NW/4 WAGONER 15' QUADRANGLE

6956 III SE  
(ROCKY POINT)

282 25' 283 | 2 770 000 FEET 285 95° 22' 30" 36° 00'

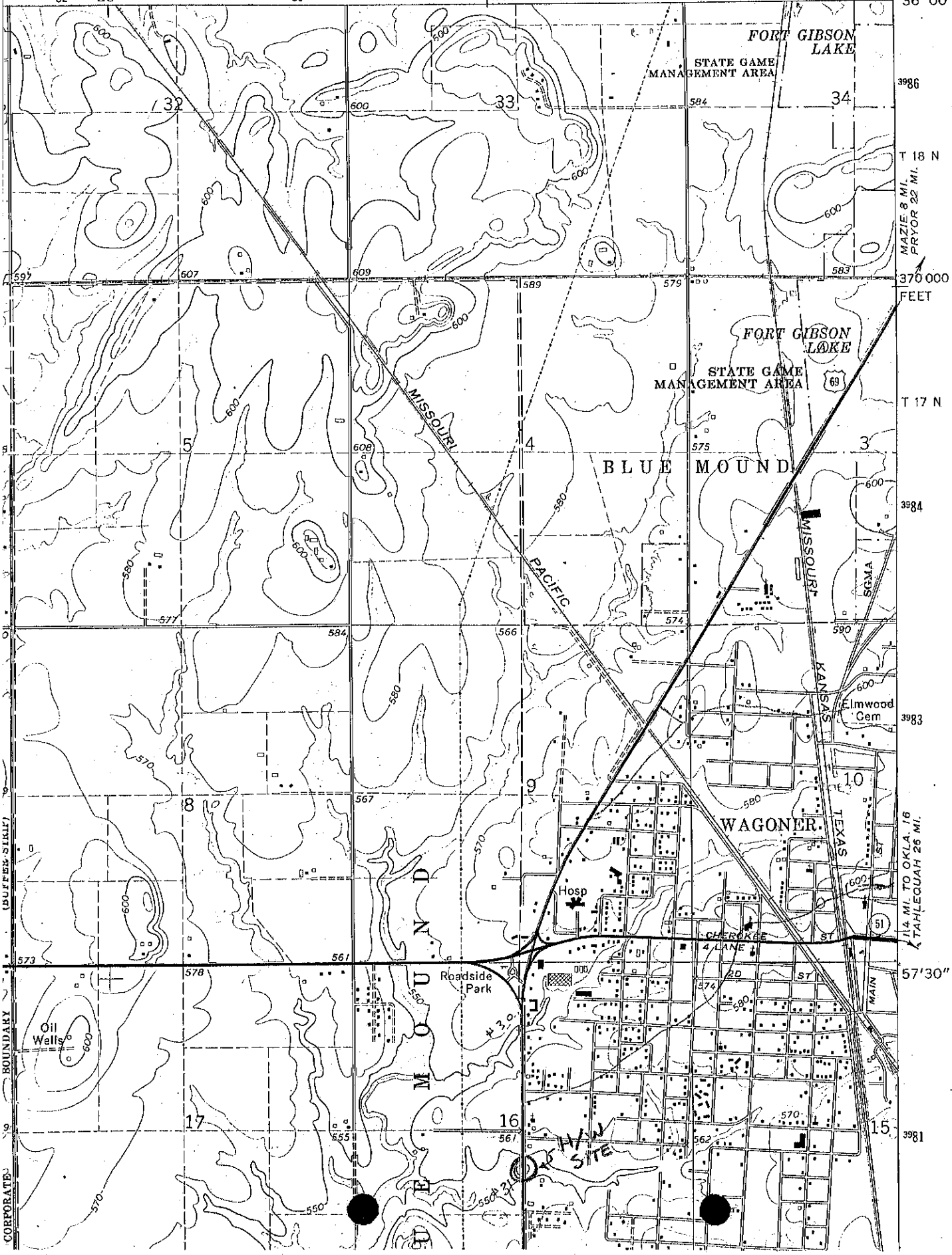

MAZIE 8 MI.  
PRYOR 22 MI.  
370 000 FEET  
T 18 N  
T 17 N  
3984  
3983  
1/4 MI. TO OKLA. 16  
TAHLEQUAH 26 MI.  
57' 30"