

RECEIVED
DEC 4 1986
SURVEY DIVISION

STATE OF OKLAHOMA
DEPARTMENT OF HIGHWAYS
SURVEY DIVISION

Survey Division
Form No. 16
Rev. Dec. 2, 1974

FLOOD INFORMATION FORM

To be used in obtaining and transmitting flood water elevations for Survey Division office record files. This information to be obtained by all Chiefs of Party or others in their vicinity in times of unusual high water, or at any time available from a reliable source. The elevations can be recorded by level reading, by measurement from bridge floor, in relation to a house, above roadbed or any other dependable, clear manner that fits the situation, the highest order possible to be used. Separate report to be made on each crossing or place obtained.

County Wagoner Date highwater occurred October 1, 1986
Highway number US 69 Name of stream unknown
Direction and distance from nearest town, village or store approx. 0.2 mile south of the Jct US 69 & SH 51 in Wagoner

Section, Township and Range in Section 16, T17N, R18E
Description of Location 1st RCB South of the Wagoner ODOT Maintenance Barn

Elevation _____ Source of levels _____
Method obtained Fennel Level Date obtained October 6, 1986

Did it appear to be normal medium extreme do not know
Was highwater mark obtained from actual water, drift, local resident, U. S. Engineers, etc.? Actual water marks and residue

Explanatory Remarks Water was 0.5 over top of the northeast corner of the east headwall of RCB

Location to be shown on back of this sheet as a check.

Field Note: To be sent to
Survey Engineer

James Wayne Rogers
Location Engineer
October 9, 1986
Date

LOCATION No. 23

WAGONER WEST QUADRANGLE
OKLAHOMA—WAGONER CO.
7.5 MINUTE SERIES (TOPOGRAPHIC)

NW/4 WAGONER 15' QUADRANGLE

6255 III SE
(ROCKY POINT)

282 25'

283

12 770 000 FEET

285

95° 22' 30"

36° 00'

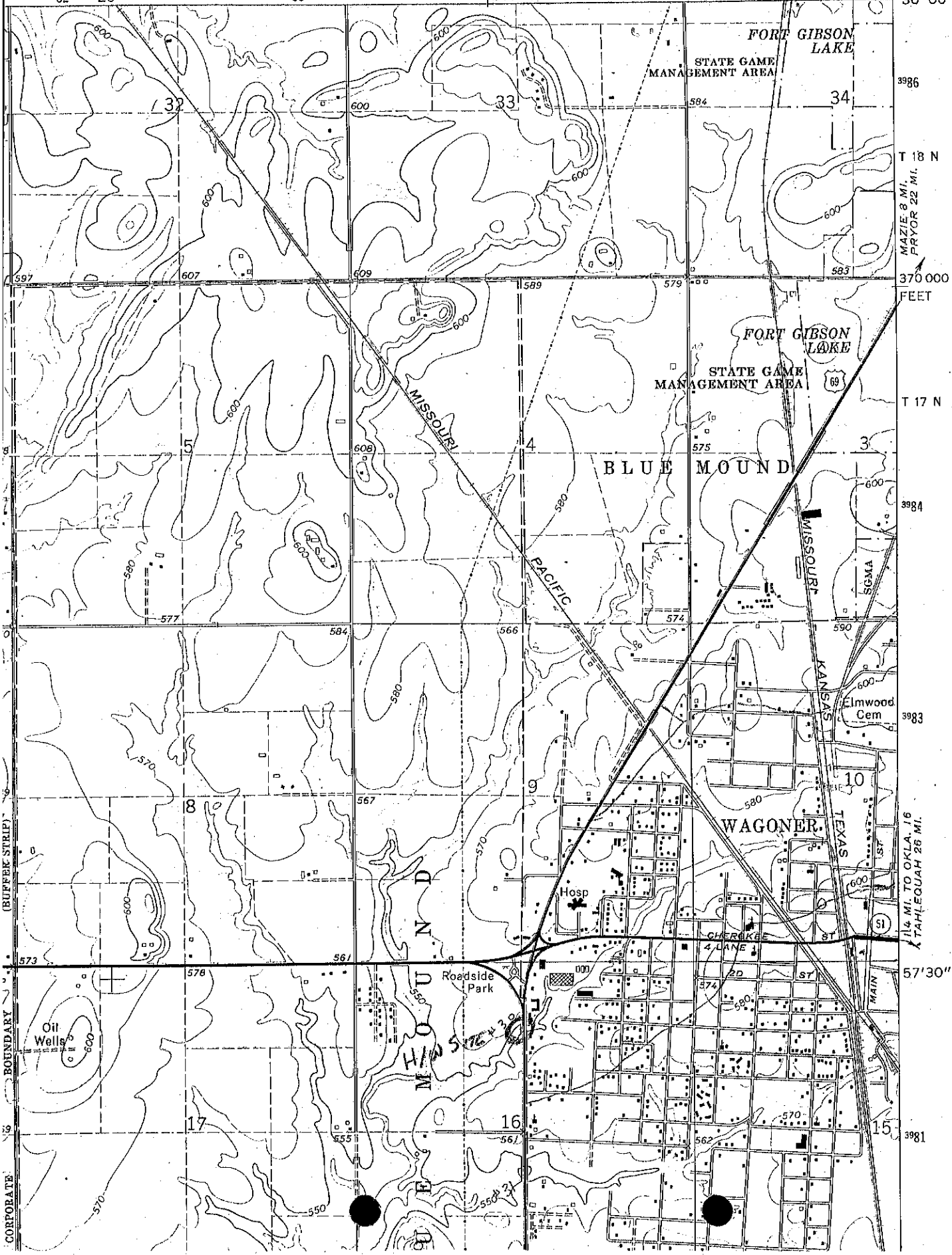

T 18 N
MAZIE 8 MI.
PRYOR 22 MI.
370 000
FEET

T 17 N
3984

11.4 MI. TO OKLA. 16
ATAHLEQUAH 28 MI.

57' 30"
3981