

RECEIVED

APR 17 1995

SURVEY  
DIVISION

STATE OF OKLAHOMA  
DEPARTMENT OF HIGHWAYS  
SURVEY DIVISION

Survey Division  
Form No. 16  
Rev. Dec. 2, 1974

FLOOD INFORMATION FORM

To be used in obtaining and transmitting flood water elevations for Survey Division office record files. This information to be obtained by all Chiefs of Party or others in their vicinity in times of unusual high water, or at any time available from a reliable source. The elevations can be recorded by measurement from bridge floor, in relation to a house, above roadbed or any other dependable, clear manner that fits the situation, the highest order possible to be used. Separate report to be made on each crossing of place obtained.

County WAGONER Date of highwater occurred 4-11-95

Highway number SH 104 Name of stream \_\_\_\_\_

Direction and distance from nearest town, village or store. 1.0 miles south and 2.7 miles westerly along SH 104 to Haskell.

Section, Township and Range Sec. 28 T-16-N, R-16-E

Description of Location Approx. 1200' south of the NW corner of Sec. 28 T-16-N, R-16-E on SH 104.

Elevation \_\_\_\_\_ Source of levels \_\_\_\_\_

Method obtained Visual Observation Date obtained 4-11-95

Highwater appeared to be medium

Was highwater mark obtained from actual water, drift, local resident, U.S. Engineers, etc.? Actual water

Explanatory Remarks Visually observed the water level was at the top of the bottom brick at the N.E. corner of house.

Location to be shown on back of this sheet as a check.

Field Note: To be sent to Survey Engineer

*J. B. Hall*

Location Engineer

4/13/95

Date

5-1-95 Copy to Bridge Division

LOCATION No. 36 APR 17 1995

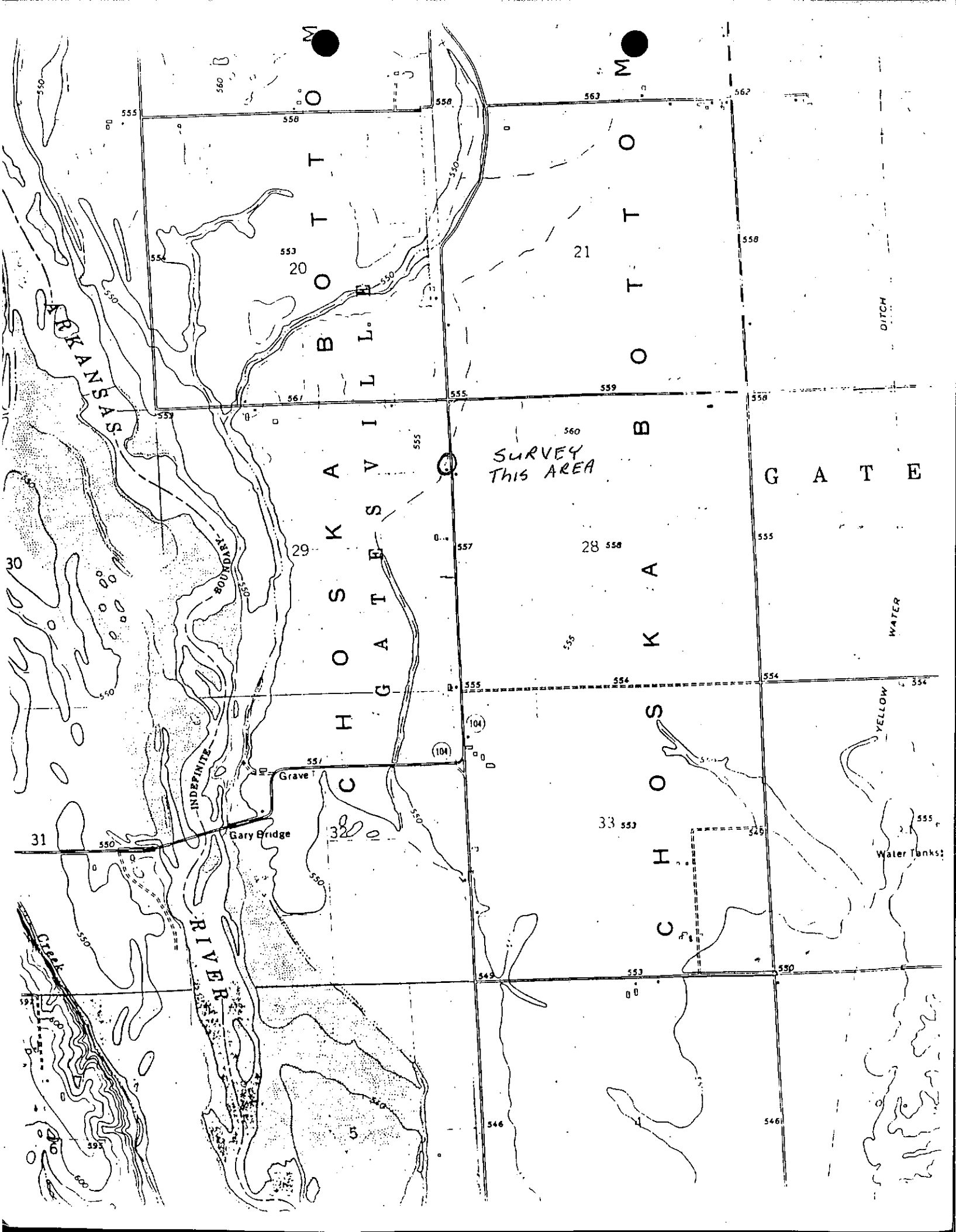

SURVEY  
THIS AREA

ARKANSAS

RIVER

INDEPINITE

GARY BRIDGE

GRAVE

WATER TANKS

YELLOW

WATER

DITCH

30

31

20

21

29

28

33

555

558

558

563

562

556

553

550

558

557

557

555

559

558

555

560

557

558

555

555

554

554

557

555

104

104

550

549

553

550

546

546