

RECEIVED

APR 17 1995

SURVEY
DIVISION

STATE OF OKLAHOMA
DEPARTMENT OF HIGHWAYS
SURVEY DIVISION

Survey Division
Form No. 16
Rev. Dec. 2, 1974

FLOOD INFORMATION FORM

To be used in obtaining and transmitting flood water elevations for Survey Division office record files. This information to be obtained by all Chiefs of Party or others in their vicinity in times of unusual high water, or at any time available from a reliable source. The elevations can be recorded by measurement from bridge floor, in relation to a house, above roadbed or any other dependable, clear manner that fits the situation, the highest order possible to be used. Separate report to be made on each crossing of place obtained.

County WAGONER Date of highwater occurred 4-11-95

Highway number SH 104 Name of stream _____

Direction and distance from nearest town, village or store. 1.3 Miles south and 2.7 miles westerly along SH 104 to Haskell.

Section, Township and Range Sec. 28 T-16-N, R-16-E

Description of Location 250' east of the N.W. corner of sec. 28 T-16-N, R-16-E.

Elevation _____ Source of levels _____

Method obtained Wild Level Date obtained 4-11-95

Highwater appeared to be Medium

Was highwater mark obtained from actual water, drift, local resident, U.S. Engineers, etc.? actual water

Explanatory Remarks Top of water was down 6" from top centerline north headwall at Sta. 110+00 on FASP/94/3/1 Plans.

Location to be shown on back of this sheet as a check.

Field Note: To be sent to Survey Engineer

5-1-95 Copy to Bridge Division

John D. Holt

Location Engineer

4/13/95

Date

LOCATION No. 3 APR 17 1995

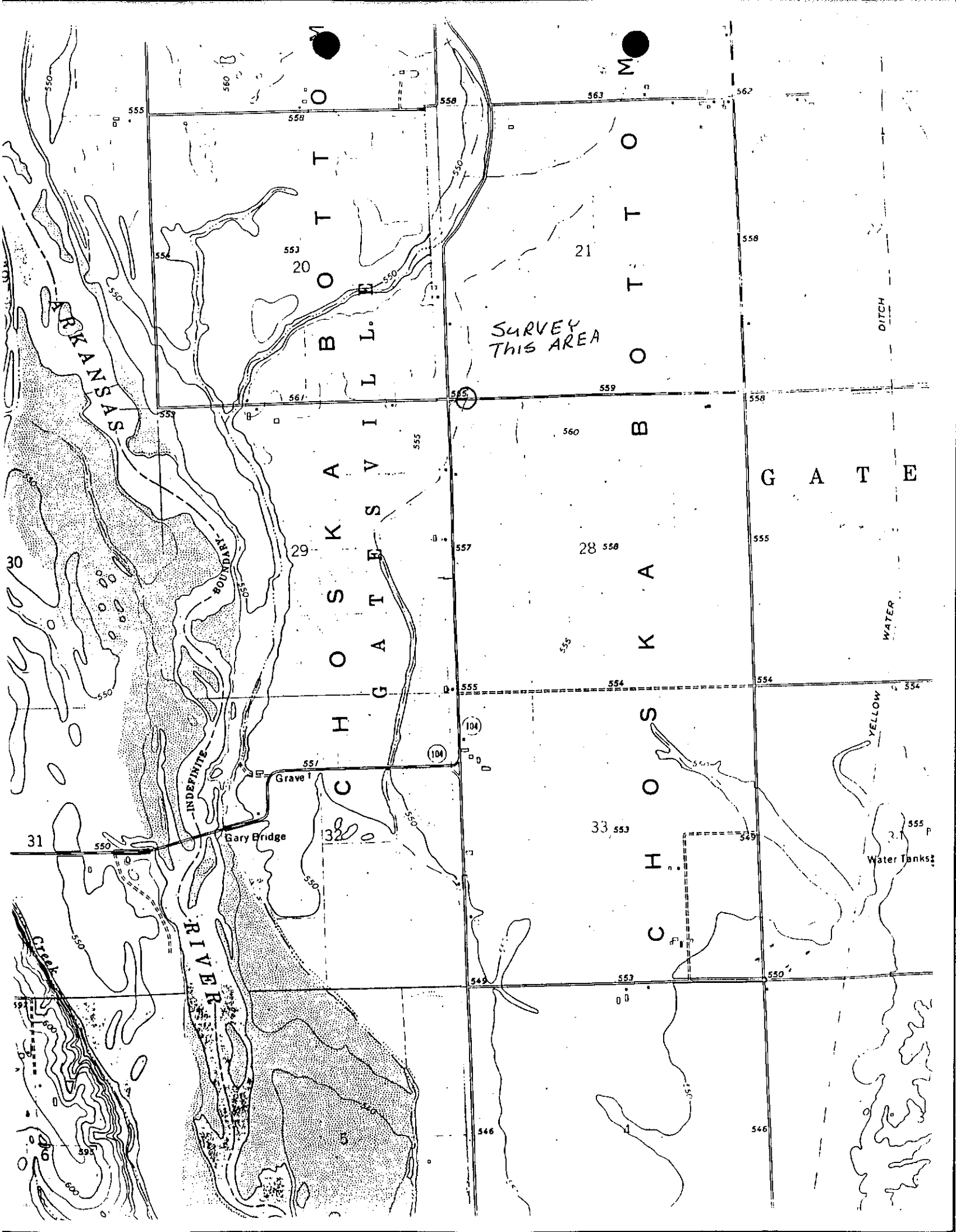

ARKANSAS RIVER

BOTTLE

CHOSKVILLE

BOTTLE

CHOSKVILLE

GATE

SURVEY THIS AREA

31

INDEFINITE

Grave 1

Gary Bridge

32

104

104

33

CHOSKVILLE

Water Tanks

YELLOW

WATER

DITCH

555

558

558

563

562

554

553

550

21

558

553

561

555

559

558

30

29

555

560

B

555

28

31

550

551

555

554

554

554

594

549

553

550

546

546

555