

RECEIVED

APR 17 1995

SURVEY
DIVISION

STATE OF OKLAHOMA
DEPARTMENT OF HIGHWAYS
SURVEY DIVISION

FLOOD INFORMATION FORM

Survey Division
Form No. 16
Rev. Dec. 2, 1974

To be used in obtaining and transmitting flood water elevations for Survey Division office record files. This information to be obtained by all Chiefs of Party or others in their vicinity in times of unusual high water, or at any time available from a reliable source. The elevations can be recorded by measurement from bridge floor, in relation to a house, above roadbed or any other dependable, clear manner that fits the situation, the highest order possible to be used. Separate report to be made on each crossing of place obtained.

County WAGONER Date of highwater occurred 12-14-92

Highway number SH 104 Name of stream Yellow Water

Direction and distance from nearest town, village or store. Approx. 1/2
mile north of Choska.

Section, Township and Range _____

Description of Location Approx. 1/2 mile N. of the int. of EW 82 &
NS 414.5.

Elevation _____ Source of levels _____

Method obtained Fennell Level Date obtained 12-14-92

Highwater appeared to be extreme

Was highwater mark obtained from actual water, drift, local resident,
U.S. Engineers, etc.? Actual water

Explanatory Remarks Shot west HDWL. approx. 75' N. of highwater read
5.20 & on top of water 5.3 & on asph. 5.85. (pipe clogged).

Location to be shown on back of this sheet as a check.

Field Note: To be sent to
Survey Engineer

San D. Hatt

Location Engineer

4/13/95

5-1-95 Copy to Bridge Division

Date APR 17 1995

LOCATION NO. 38

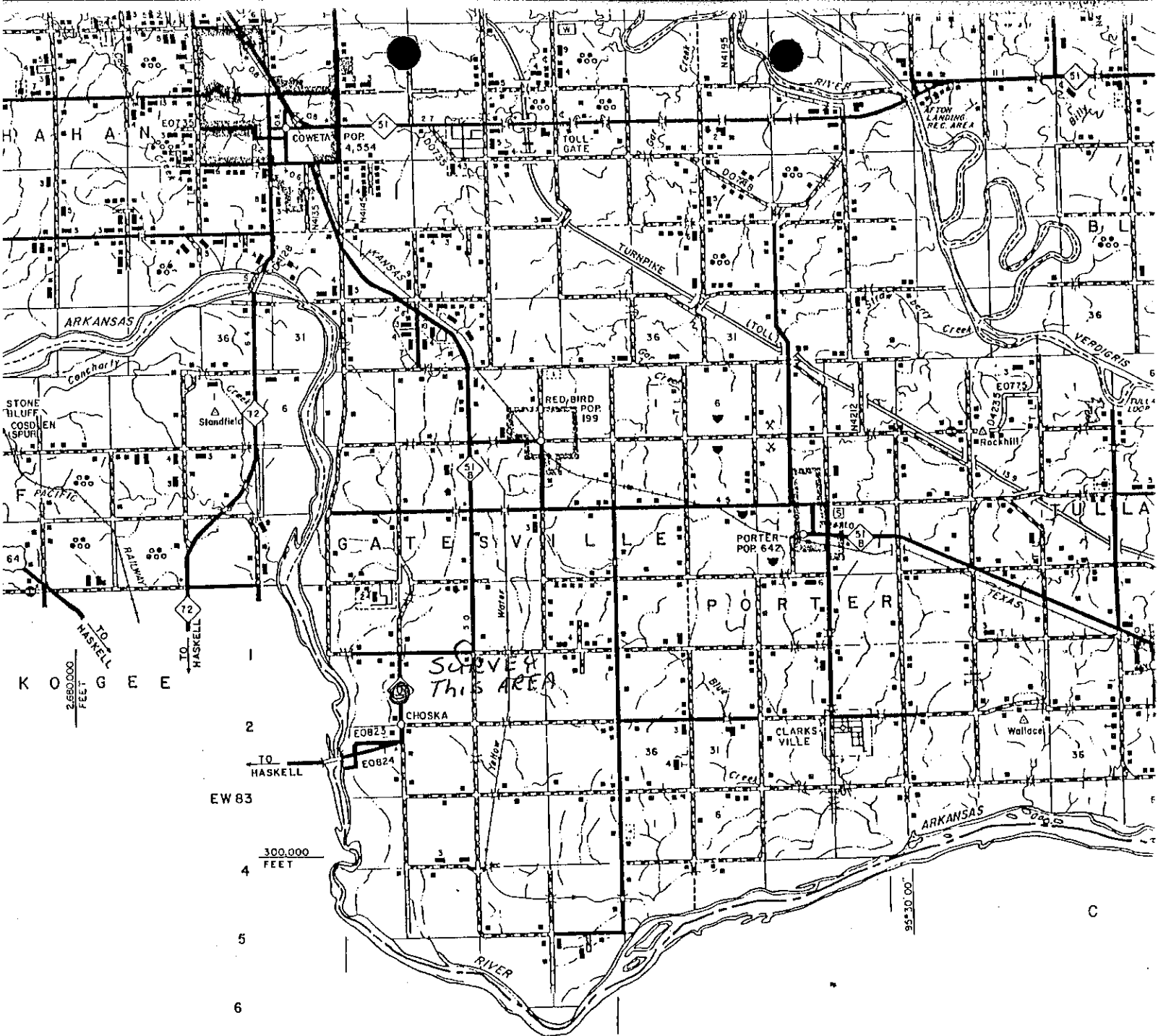

2,680,000 FEET

EW 83

300,000 FEET

95° 30' 00"

SURVEY THIS AREA

H A H A N

COWETA POP. 4,554

TOLL GATE

ASTON LANDING REG. AREA

B L

ARKANSAS

STONE BLUFF
CROSSING
SPUR

Standfield

RED BIRD POP. 199

Rock Hill

TRAIL LOOP

K O G G E E

G A T E S V I L L E

P O R T E R POP. 642

T U L S A

CHOSKA

CLARKS VILLE

Wallace

ARKANSAS

RIVER

C