

RECEIVED

APR 17 1995

SURVEY  
DIVISION

STATE OF OKLAHOMA  
DEPARTMENT OF HIGHWAYS  
SURVEY DIVISION

Survey Division  
Form No. 16  
Rev. Dec. 2, 1974

FLOOD INFORMATION FORM

To be used in obtaining and transmitting flood water elevations for Survey Division office record files. This information to be obtained by all Chiefs of Party or others in their vicinity in times of unusual high water, or at any time available from a reliable source. The elevations can be recorded by measurement from bridge floor, in relation to a house, above roadbed or any other dependable, clear manner that fits the situation, the highest order possible to be used. Separate report to be made on each crossing of place obtained.

County WAGONER Date of highwater occurred 12-14-92

Highway number SH 104 Name of stream YELLOW WATER

Direction and distance from nearest town, village or store. 1 mile north and 1 mile east of Choska.

Section, Township and Range \_\_\_\_\_

Description of Location Approx. 200' west of the Int. of EW 81 & NS 415.75.

Elevation \_\_\_\_\_ Source of levels \_\_\_\_\_

Method obtained Fennell Level Date obtained 12-14-92

Highwater appeared to be extreme

Was highwater mark obtained from actual water, drift, local resident, U.S. Engineers, etc.? Actual water

Explanatory Remarks Shot top of N. HDWL. approx. 100' east of highwater read 5.46 & 5.9 on top of water & 6.29 on asph.

Location to be shown on back of this sheet as a check.

Field Note: To be sent to Survey Engineer

5-1-95 Copy to Bridge Division

*Jon D. Hall*

Location Engineer

4/13/95

Date

LOCATION No. 39 APR 17 1995

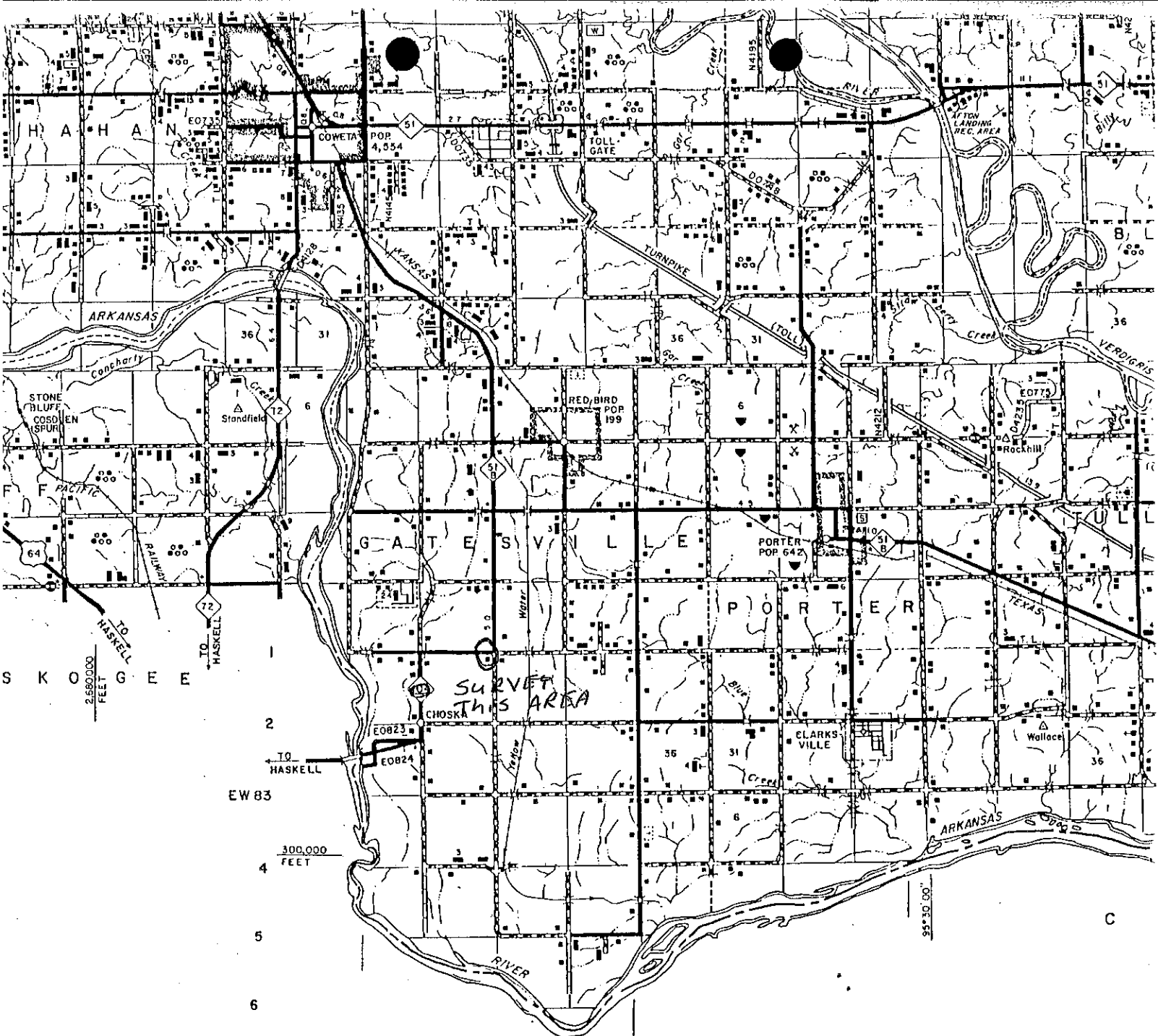

H A H A N

COWETA POP 4,054

TOLL-GATE

ARKANSAS

STONE BLUFF  
COSDEN  
SPUR

Standfield

RED BIRD POP 199

EGGERS

G A T E S V I L L E

PORTER POP 642

P O R T E R

S K O G E E

*SURVEY THIS AREA*

CHOSKA

CLARKSVILLE

Wallace

2

EW 83

4

5

6

TO HASKELL

TO HASKELL

300,000 FEET

95°30'00"

C