

RECEIVED
OCT 29 1971
SURVEY DIVISION

Survey Division
Form No. 16
Rev. Sept. 10, 1961

STATE OF OKLAHOMA
DEPARTMENT OF HIGHWAYS
SURVEY DIVISION

FLOOD INFORMATION FORM

To be used in obtaining and transmitting flood water elevations for Survey Division office record files. This information to be obtained by all Chiefs of Party or others in their vicinity in times of unusual high water, or at any time available from a reliable source. The elevations can be recorded by level reading, by measurement from bridge floor, in relation to a house, above roadbed or any other dependable, clear manner that fits the situation, the highest order possible to be used. Separate report to be made on each crossing or place obtained.

County Tulsa Date highwater occurred Sept. 5, 1971

Highway number US 75 Bee Line Name of stream Coal Creek

Direction and distance from nearest town, village or store 1-mile south of N.W. corner Glenn Pool, Okla. on US 75 Bee Line

Section, Township and Range Sec 23 T-17-N R-12-E

Description of Location On US 75 BEE-Line & Jct. 151st. St. South

Elevation _____ Source of levels _____

Method obtained Survey Party Y-Level Date obtained Sept 7, 1971

Did it appear to be normal medium extreme do not know

Was highwater mark obtained from actual water, drift, local resident, U. S. Engineers, etc.? Drift up 4.70' from centerline west Hdwl. at 151 st. St South

Explanatory Remarks Water approximately 1.0' deep over Bee Line

Location to be shown on back of this sheet as a check.

Field Note: To be sent to
Survey Engineer

Serge E. Higginbotham
Chief of Party

Sept 7, 1971
Date

LOCATION NO. 1

R-12-E

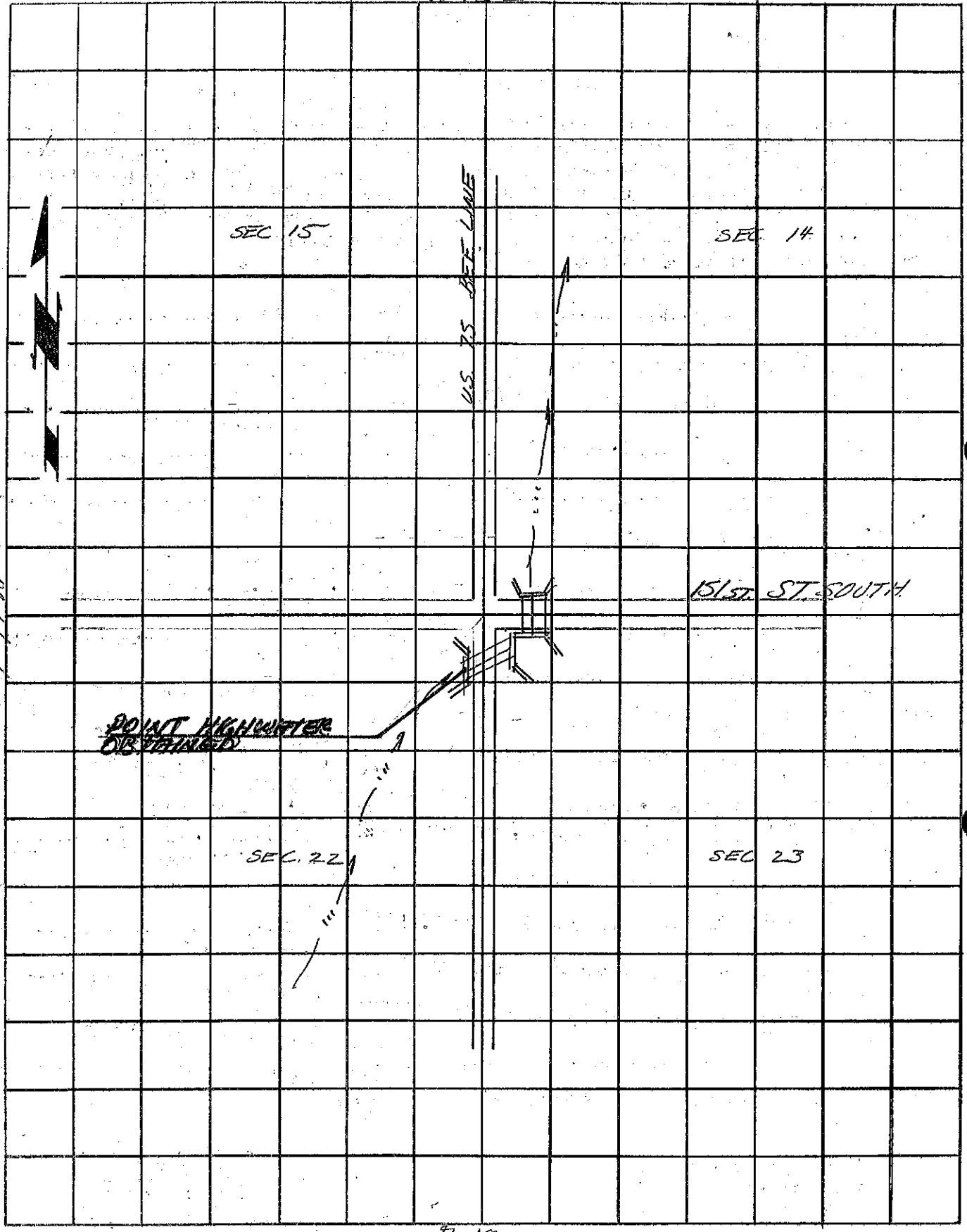

SEC 15

SEC 14

U.S. 75 BEE LANE

15th ST. SOUTH

POINT HIGHWATER OBTAINED

SEC. 22

SEC 23

T-17-N

T-17-N

R-12-E