

STATE OF OKLAHOMA
DEPARTMENT OF HIGHWAYS
PLANS AND SURVEY DEPARTMENT

FLOOD INFORMATION FORM

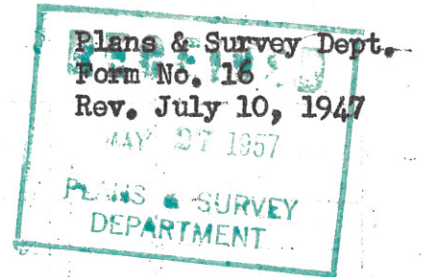

To be used in obtaining and transmitting flood water elevations for Plans & Survey office record files. This information to be obtained by all Chiefs of Party in their vicinity in times of unusual high water, or at any time available from a reliable source. The elevations can be recorded by level reading, by measurement from bridge floor, in relation to a house, above roadbed or any other dependable, clear manner that fits the situation, the highest order possible to be used. Separate report to be made on each crossing or place obtained.

County Tulsa Date highwater occurred May 21, 1957

Highway number 0 54 Name of stream Arkansas River

Direction and distance from nearest town, village or store Elevation obtained in Bixby Oklahoma. at intersection Armstrong St and Breckenridge St, in front of U.S. Post Office.

Section, Township and Range Section 24 - T-17-N, R-13-E

Description of Location In Bixby Oklahoma, in front of U.S. Post Office Bldg., at intersection of Armstrong St. and Breckenridge St.

Method obtained Field observation on May 24, 1957 - Levels obtained by WYE Level.

11.9 ft below centerline floor, BM = S. End, Top Floor Arkansas River Bridge, 1/2 mile N. Bixby.
Source of levels River Bridge, 1/2 mile N. Bixby.

Was highwater mark obtained from actual water, drift, local resident, U. S. Engineers, etc? Field Observation by A. W. Opela, Rodman this party.

Obtained from water mark on building and from inside postoffice bldg. at Bixby.

Explanatory Remarks The earth dike along the south side of the Arkansas River gave way northwest of Bixby which caused part of the flooding.

There was 2 tenths water on floor of Post Office Bldg.

Location to be shown on back of this sheet as a check.

Field Note: To be sent to Engr. of Plans & Survey (1 copy).

Office Note: To be filed in Flood Information by Counties.

Reed Day Morgan
Chief of Party

May 24, 1957
Date

✓

LOCATION NO 11

SH 64
TO TOLSON
5/16/54

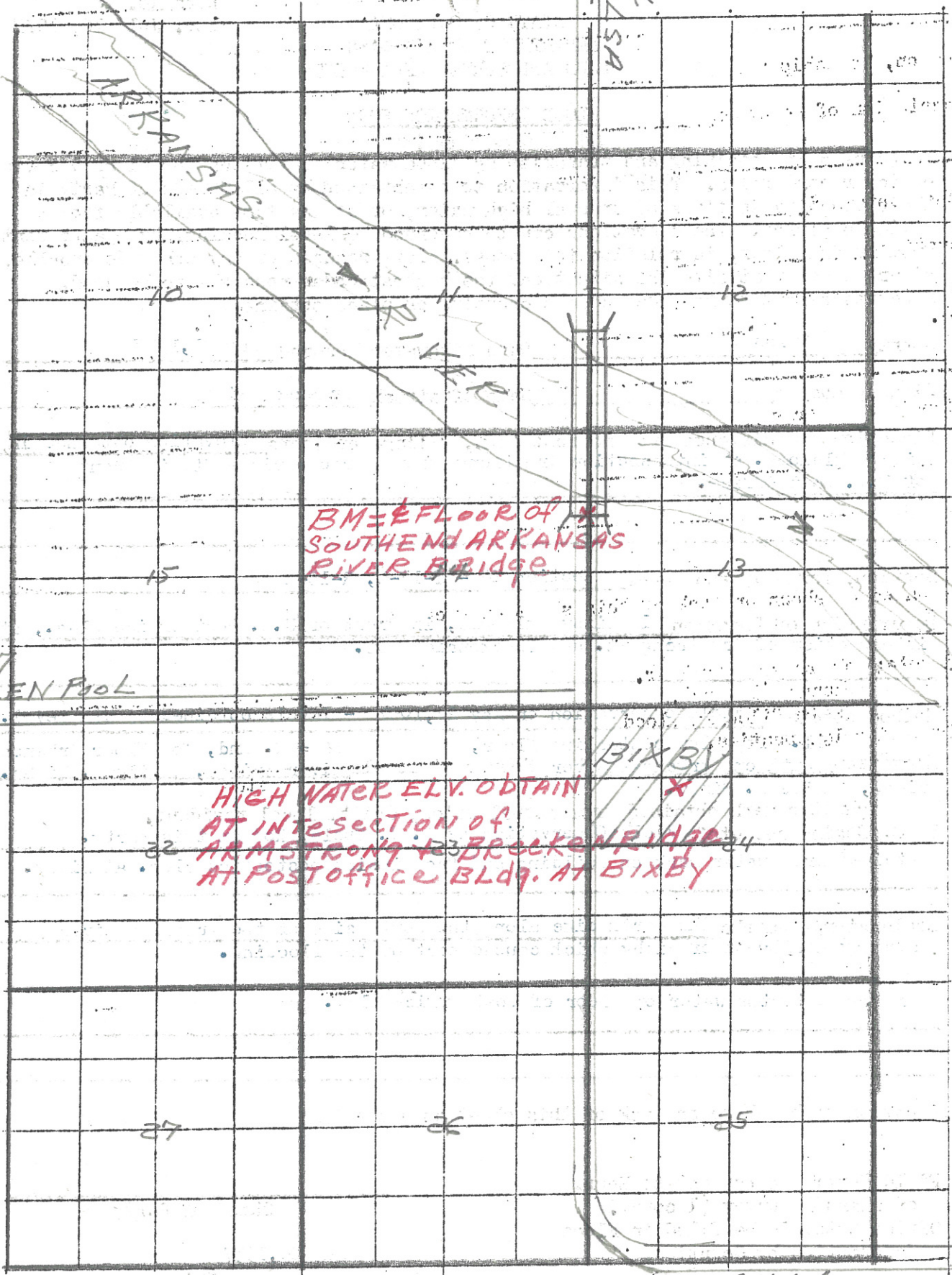

SH 67
TO GLEN POOL

BM = E FLOOR OF
SOUTHERN ARKANSAS
RIVER BRIDGE

HIGH WATER ELV. OBTAIN
AT INTERSECTION OF
ARMSTRONG & BROCKEN RIDGE
AT POST OFFICE BLDG. AT BIXBY

BIXBY

R-13-E SH 64
TO LEONARD