

Plans & Survey Dept.
Form No. 16
March, 1947

OKLAHOMA STATE HIGHWAY COMMISSION
PLANS & SURVEYS DEPARTMENT

FLOOD INFORMATION FORM

To be used in obtaining and transmitting flood water elevations for Plans & Survey office record files. This information to be obtained by all Chiefs of Party in their vicinity in times of unusual high water. The elevations can be recorded by level reading, by measurement from bridge floor, in relation to a house, above roadbed or any other dependable, clear manner that fits the situation, the highest order possible to be used. Separate report to be made on each crossing or place obtained.

County Tulsa Date 1947

Highway number US. 64 Name of Creek Snake

Direction and distance from nearest town, village or store 2.0 miles south and 3.0 east of Bixby.

Section, Township and Range Sec. 32, T17N, R14E.

Description of Location Sta. 103+97 SWO. 1419 Tulsa County

Method obtained Elev. 598.5 From U.S.E.D. Tulsa Office

Was highwater mark obtained from actual water, drift, or local resident, explain U.S.E.D. Tulsa Office.

Explanatory Remarks

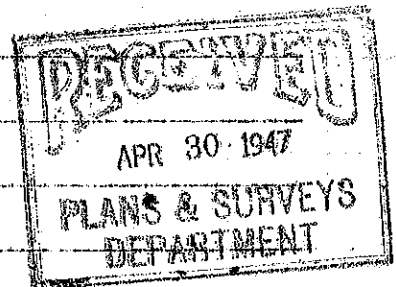

Location to be shown on back of this sheet as a check.

J. A. Williams
Chief of Party

Field note: To be sent to Engr.
of Plans & Surveys (one copy).
Office note: To be filed in Flood
information by Counties,

April 18, 1947
Date

LOCATION NO. 12

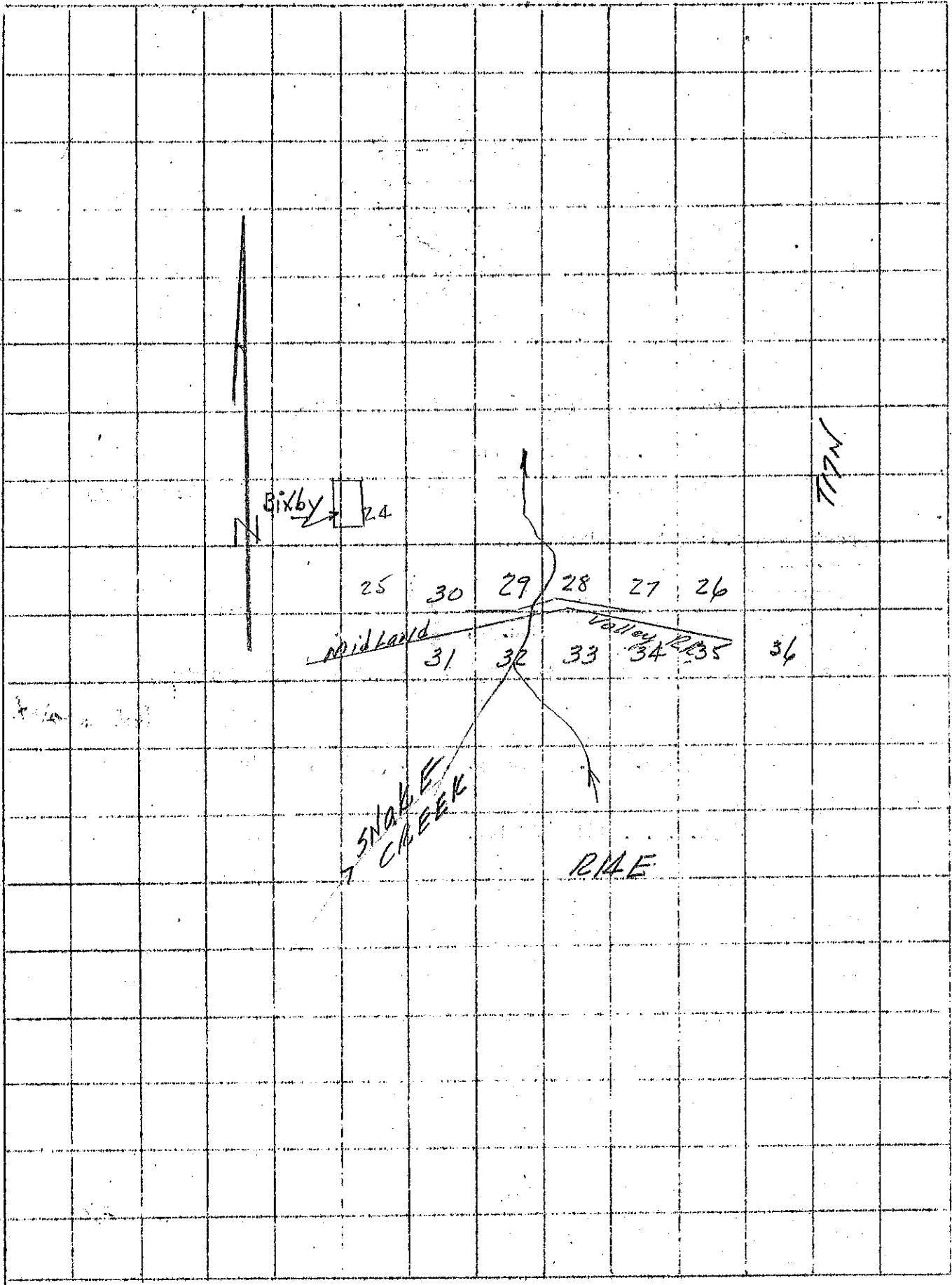

Bixby 24

25 30 29 28 27 26

Midland 31 32 33 34 35 36

Snake Creek

RAE

717N