

STATE OF OKLAHOMA
DEPARTMENT OF HIGHWAYS
SURVEY DIVISION

FLOOD INFORMATION FORM

To be used in obtaining and transmitting flood water elevations for Survey Division office record files. This information to be obtained by all Chiefs of Party or others in their vicinity in times of unusual high water, or at any time available from a reliable source. The elevations can be recorded by level reading, by measurement from bridge floor, in relation to a house, above roadbed or any other dependable, clear manner that fits the situation, the highest order possible to be used. Separate report to be made on each crossing or place obtained.

County Tulsa Date highwater occurred November 3, 1974
Interchange Survey
Highway number US 75 & SH 117 Name of stream Coal Creek
SWO 2470 (3)
Direction and distance from nearest town, village or store Approximately 5 miles east of Sapulpa, just east of the proposed interchange at Jct. US 75 & SH 117.

Section, Township and Range E & W Sec. Line between Sec. 2, T-17-N, R-12-E & Sec. 35, T-18-N, R-12-E.
Description of Location Approximately 1300 Feet east of Jct. US 75 & SH 117 at the Coal Creek crossing of above section line and present bridge.

Elevation 637.8 Feet Source of levels Mean Sea Level "USC&GS" From SWO 2470(3) Survey
Method obtained Wye Level Date obtained November 6, 1974

Did it appear to be normal medium extreme do not know

Was highwater mark obtained from actual water, drift, local resident, U. S. Engineers, etc.? Obtained by M. K. Williamson, Chief of Party, and D. R. Barnes, Instman 11 of this party, from silt and drift particles around present bridge after water had receded.

Explanatory Remarks Due to heavy rains during the week of from Oct. 28, 74 to Nov. 3, 74, during which time the Tulsa area received approx. 10 inches of rain.

Location to be shown on back of this sheet as a check.

Field Note: To be sent to
Survey Engineer

Rees D. Johnson
Location Engineer

November 12, 1974
Date

Location No. 26

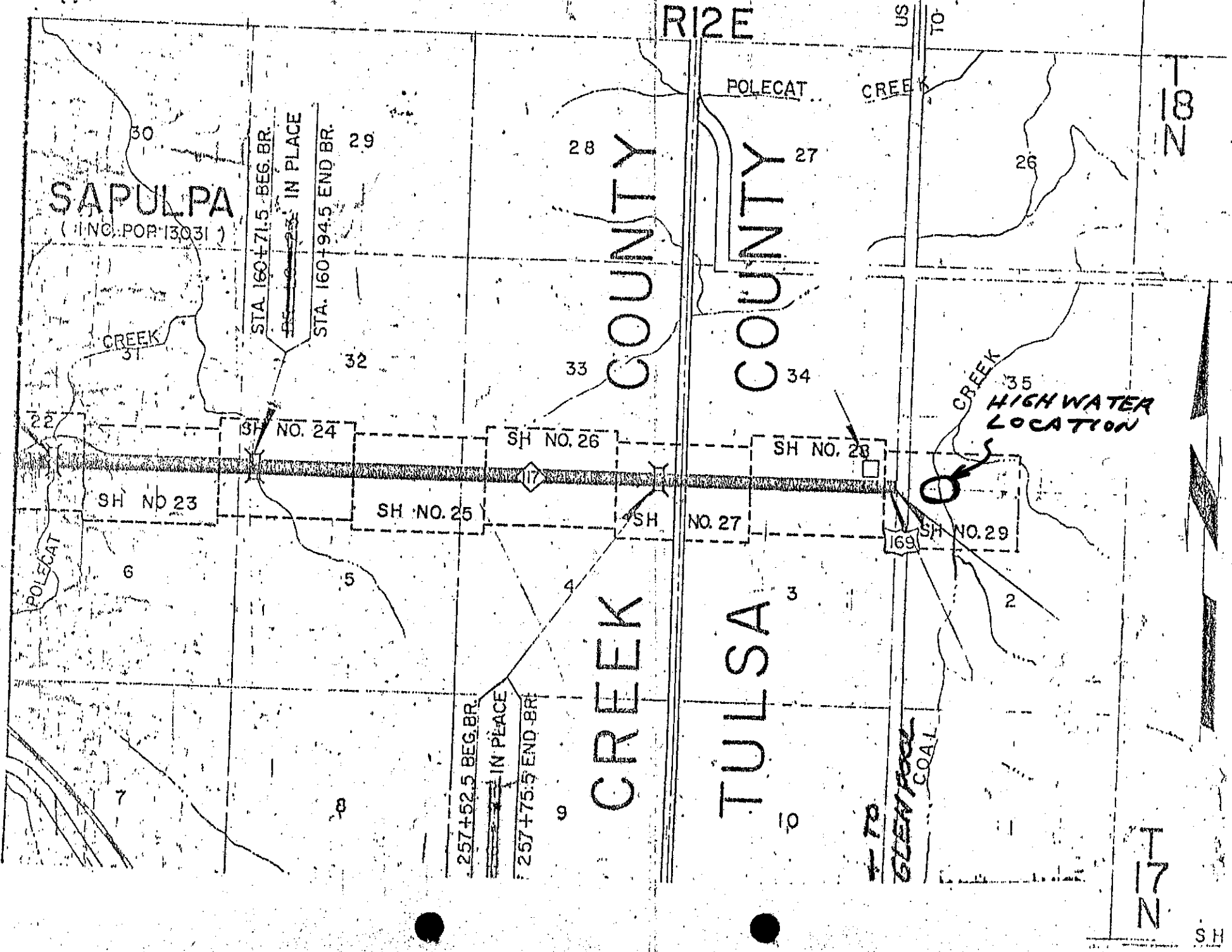

SAPULPA
(INC. POP. 13031)

R12E

US 169
TO TULSA

18
N

CREEK COUNTY
TULSA COUNTY

CREEK

CREEK
HIGH WATER
LOCATION

SH NO. 23

SH NO. 24

SH NO. 26

SH NO. 28

SH NO. 25

SH NO. 27

SH NO. 29

257+52.5 BEG. BR.

IN PLACE

257+75.5 END BR.

CREEK

TULSA

GLEN POOL
COAL

17
N

SH