

RECEIVED
JUL 12 1984
SURVEY DIVISION

STATE OF OKLAHOMA
DEPARTMENT OF HIGHWAYS
SURVEY DIVISION

Survey Division
Form No. 16
Rev. Sept. 10, 1961

FLOOD INFORMATION FORM

To be used in obtaining and transmitting flood water elevations for Survey Division office record files. This information to be obtained by all Chiefs of Party or others in their vicinity in times of unusual high water, or at any time available from a reliable source. The elevations can be recorded by level reading, by measurement from bridge floor, in relation to a house, above roadbed or any other dependable, clear manner that fits the situation, the highest order possible to be used. Separate report to be made on each crossing or place obtained.

County Tulsa Date highwater occurred 5-27-84

Highway number S.H. 51 Name of stream Mingo Creek

Direction and distance from nearest town, village or store East edge of Tulsa on the Broken Arrow Expressway.

Section, Township and Range 30, T-19-N R-14-E

Description of Location .4 mi. east of Mingo Road on the Broken Arrow Expwy.

Elevation 658.3 Source of levels _____

Method obtained Hand Level & Level Rod Date obtained 5-29-84

Did it appear to be normal medium extreme do not know

Was highwater mark obtained from actual water, drift, local resident, U. S. Engineers, etc.? Drifts along roadway.

Explanatory Remarks It did not appear that water was over roadway.

B.M. 'II' on top conc. parapet wall at S.E. cor. R.O.B. marked 663.18

Location No. 4 on back of this sheet.

Location to be shown on back of this sheet as a check.

Field Note: To be sent to
Survey Engineer

Henry E. Higginbotham
Location Engineer

may 31, 1984
Date

LOCATION NO. 41

**COMM.
DIST.
NO. 1**

86th ST N
76th ST N
66th ST N
56th ST N
46th ST N
36th ST N
APACHE
(26th ST N)
PINE
(15th ST N)

R
O
G
E
R
S

STATE MAP AS
APPROVED BY
COMMISSIONER
OF LANDS

11th ST
21th ST
31th ST
41th ST
51th ST
61th ST
71th ST
81th ST
91th ST
101th ST
111th ST
121th ST
131th ST
141th ST

T
19
N
C
O
U
N
T
Y

T
18
N
N
E
R

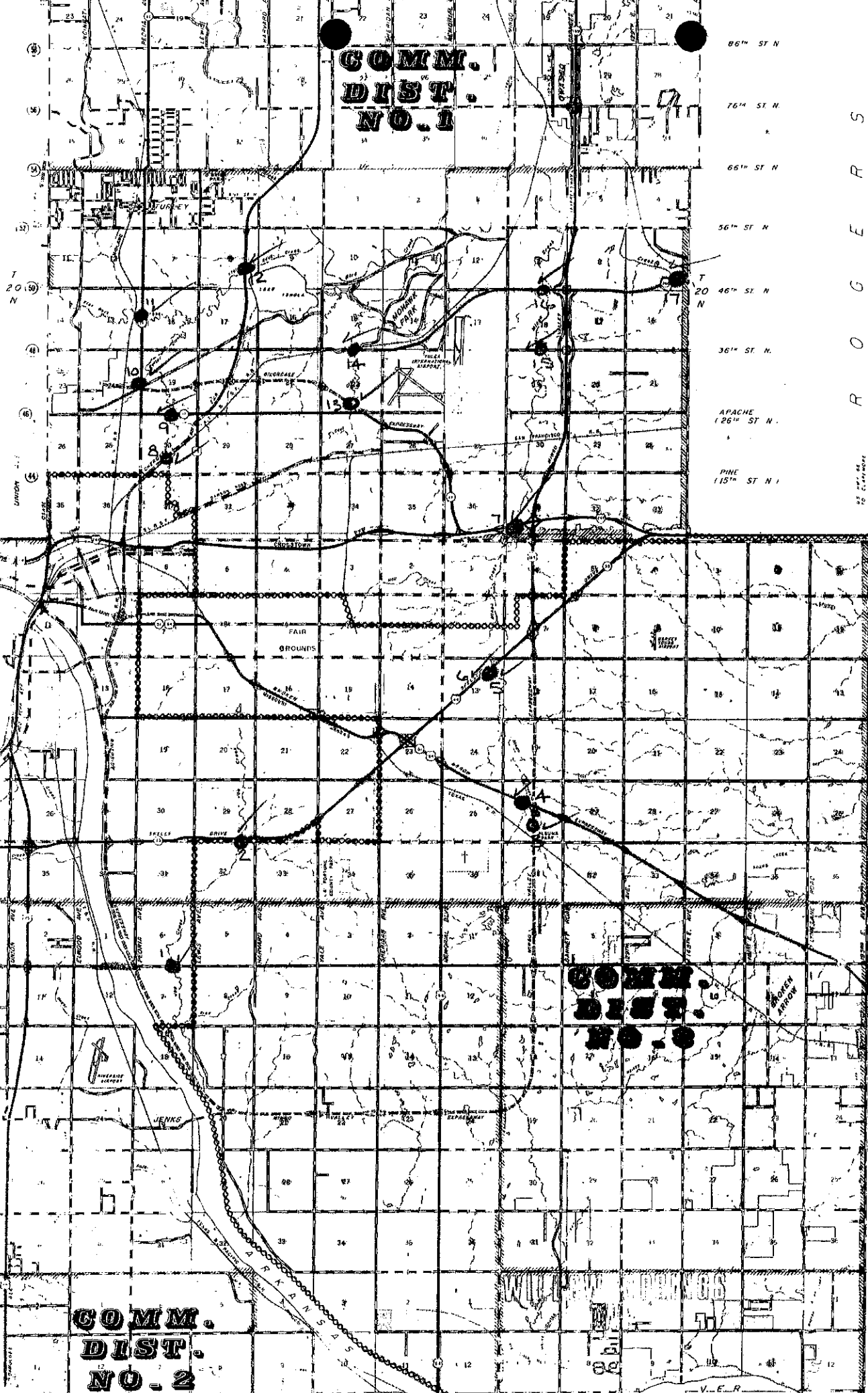

**COMM.
DIST.
NO. 2**