

STATE OF OKLAHOMA  
DEPARTMENT OF HIGHWAYS  
SURVEY DIVISION

FLOOD INFORMATION FORM

To be used in obtaining and transmitting flood water elevations for Survey Division office record files. This information to be obtained by all Chiefs of Party or others in their vicinity in times of unusual high water, or at any time available from a reliable source. The elevations can be recorded by level reading, by measurement from bridge floor, in relation to a house, above roadbed or any other dependable, clear manner that fits the situation, the highest order possible to be used. Separate report to be made on each crossing or place obtained.

County Tulsa Date highwater occurred May 27, 1984

Highway number US 169 Name of stream None

Direction and distance from nearest town, village or store In Northeast Tulsa

Section, Township and Range Section 30, T20N, R14E

Description of Location Water marks on bridge pier of railroad bridge over US 169.

Elevation 506.17 Source of levels Assumed

Method obtained Fennel Level Date obtained May 29, 1984

Did it appear to be  normal  medium  extreme  do not know

Was highwater mark obtained from actual water, drift, local resident, U. S. Engineers, etc.? Fresh water marks of the actual highwater.

Explanatory Remarks Bench mark in the exact center of the east hdwl. of the first structure north of the Burlington Northern Railroad overpass on US 169.

Assumed elev. - 500.00

Location to be shown on back of this sheet as a check.

Field Note: To be sent to  
Survey Engineer

*James Wayne Rogers*  
Location Engineer

6/5/84  
Date

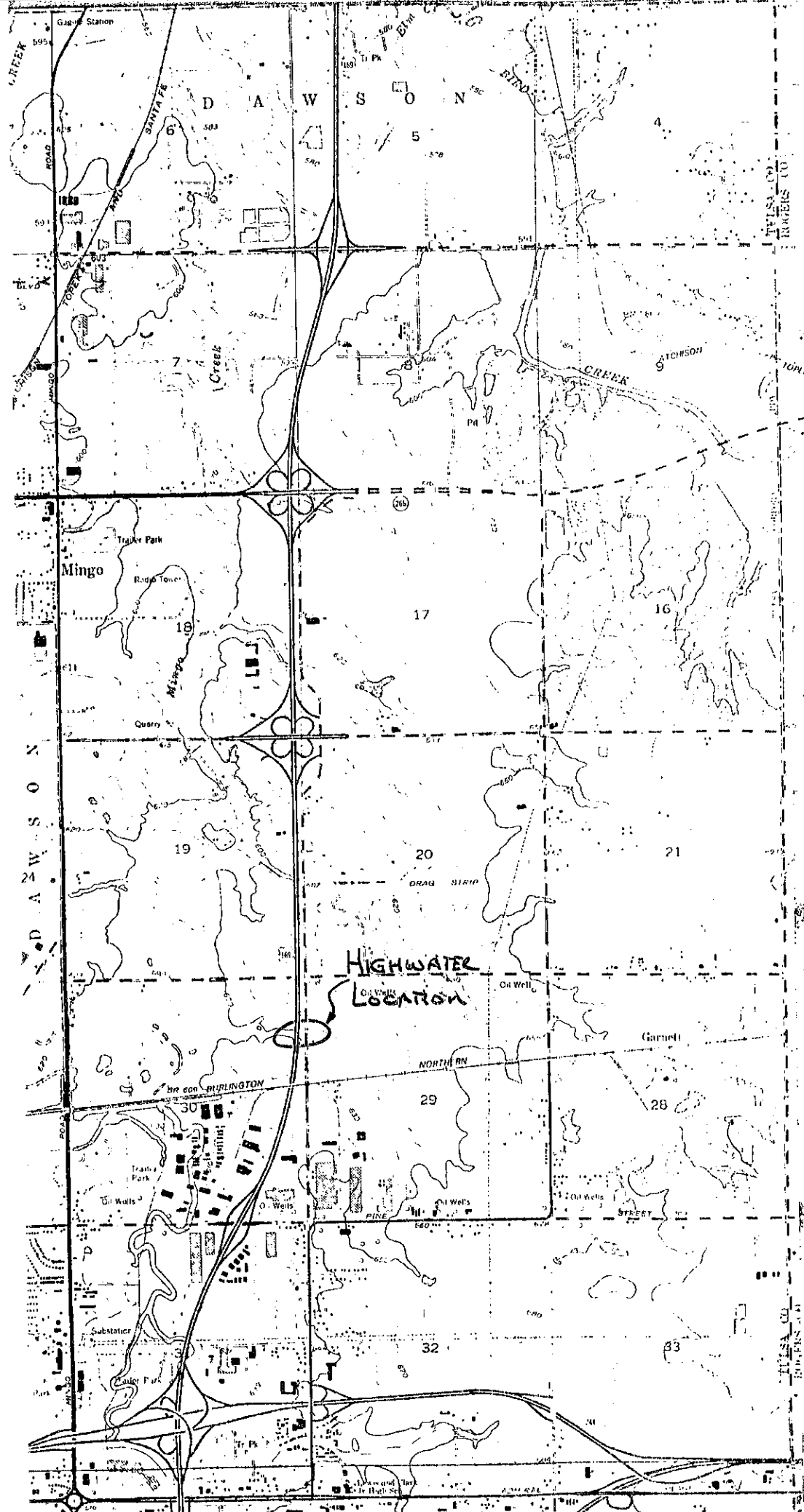

HIGHWATER  
LOCATION

DAWSON  
OKLAHOMA

DAWSON  
OKLAHOMA