

RECEIVED  
JUL 12 1984  
SURVEY DIVISION

STATE OF OKLAHOMA  
DEPARTMENT OF HIGHWAYS  
SURVEY DIVISION

Survey Division  
Form No. 16  
Rev. Sept. 10, 1961

FLOOD INFORMATION FORM

To be used in obtaining and transmitting flood water elevations for Survey Division office record files. This information to be obtained by all Chiefs of Party or others in their vicinity in times of unusual high water, or at any time available from a reliable source. The elevations can be recorded by level reading, by measurement from bridge floor, in relation to a house, above roadbed or any other dependable, clear manner that fits the situation, the highest order possible to be used. Separate report to be made on each crossing or place obtained.

County Tulsa Date highwater occurred 5-27-84

Highway number S.H. 11 Name of stream Dirty Butter Creek

Direction and distance from nearest town, village or store N.W. part of Tulsa.

Section, Township and Range 30. T-20-N R-13-E

Description of Location Approx. .5 mi. East of Peoria Ave. on E. Apache St. in Tulsa.

Elevation 2.3' over 0 Pav. at R.O.B. Source of levels \_\_\_\_\_

Method obtained Level & level rod Date obtained 5-29-84

Did it appear to be  normal  medium  extreme  do not know

Was highwater mark obtained from actual water, drift, local resident, U. S. Engineers, etc.? Drift in cyclone fence

Explanatory Remarks Location No. 9 on back of this sheet.

Location to be shown on back of this sheet as a check.

Field Note: To be sent to  
Survey Engineer

  
Location Engineer

May 31, 1984  
Date

LOCATION No. 64

**COMM.  
DIST.  
NO. 1**

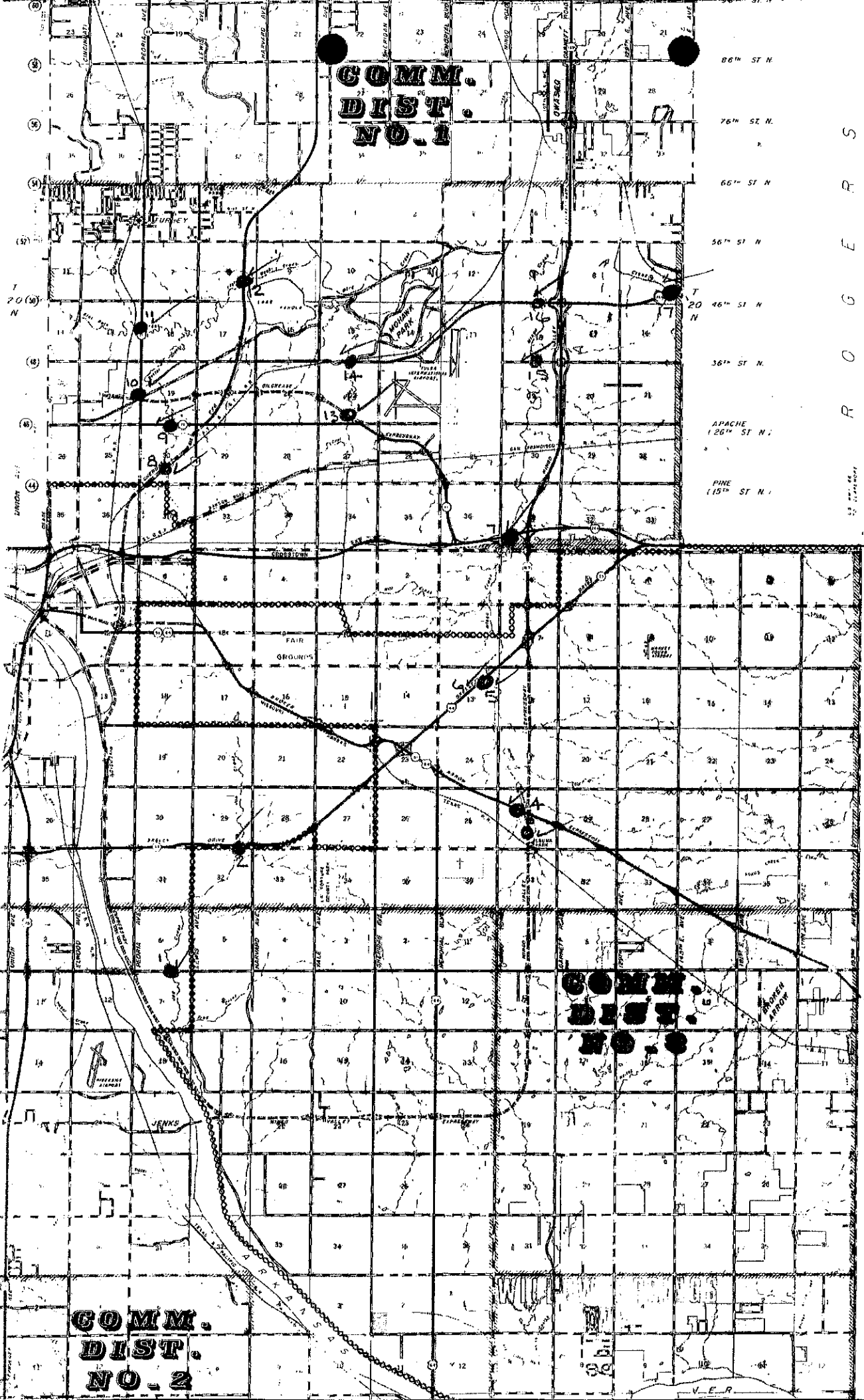

**COMM.  
DIST.  
NO. 2**

**COMM.  
DIST.  
NO. 1**

ROGERS  
COU  
N  
E  
R  
Y

STATE MAP OF  
OKLAHOMA  
CHEROKEE  
CREEK LINE  
11th ST  
21st ST  
T  
19  
31st ST  
N  
41st ST  
51st ST  
61st ST  
71st ST  
81st ST  
T  
10  
91st ST  
N  
101st ST  
111st ST  
121st ST  
131st ST  
141st ST