

STATE OF OKLAHOMA
DEPARTMENT OF HIGHWAYS
SURVEY DIVISION

FLOOD INFORMATION FORM

To be used in obtaining and transmitting flood water elevations for Survey Division office record files. This information to be obtained by all Chiefs of Party or others in their vicinity in times of unusual high water, or at any time available from a reliable source. The elevations can be recorded by level reading, by measurement from bridge floor, in relation to a house, above roadbed or any other dependable, clear manner that fits the situation, the highest order possible to be used. Separate report to be made on each crossing or place obtained.

County Tulsa Date highwater occurred October 1, 1986

Highway number US 64 Name of stream unknown

Direction and distance from nearest town, village or store 0.8 mile south of the Jct. US 64 & SH 67 in Bixby

Section, Township and Range Near NW Cor SW $\frac{1}{4}$ SW $\frac{1}{4}$ of Section 24, T17N, R13E

Description of Location _____

Elevation _____ Source of levels _____

Method obtained Fennel Level Date obtained October 6, 1986

Did it appear to be normal medium extreme do not know

Was highwater mark obtained from actual water, drift, local resident, U. S. Engineers, etc.? Actual water marks and residue

Explanatory Remarks Water was 0.5 feet below centerline of paving over the RCB at this location.

Location to be shown on back of this sheet as a check.

Field Note: To be sent to
Survey Engineer

James Wayne Rogers
Location Engineer

October 9, 1986
Date

LOCATION No. 79

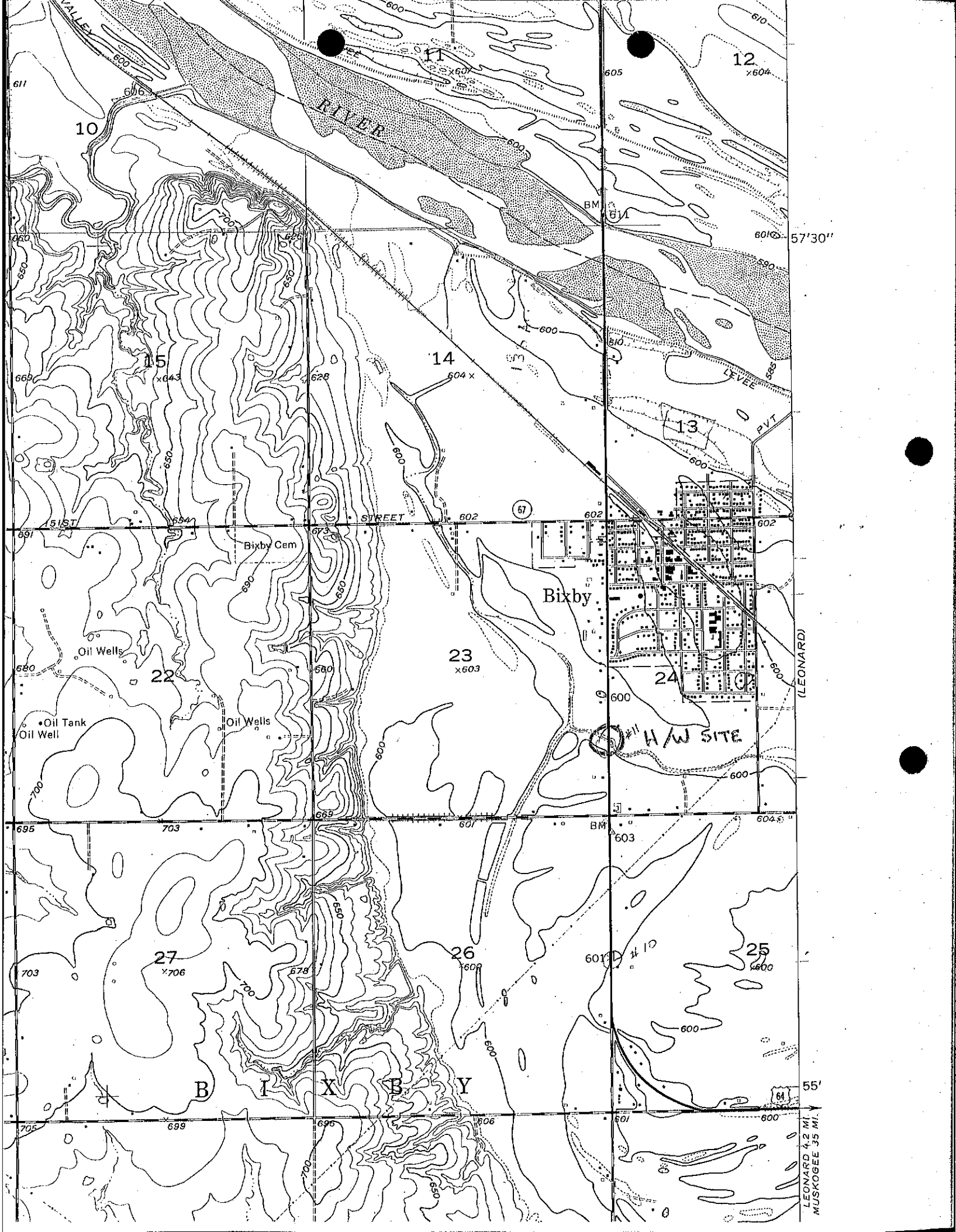

611

10

RIVER

11

12

15

14

13

Bixby Cem

STREET

Bixby

23

24

(LEONARD)

Oil Wells

Oil Tank Oil Well

Oil Wells

H/W SITE

27

26

25

BIXBY

LEONARD 4.2 MI
MUSKOGEE 3.5 MI

57°30''