



OKLAHOMA DEPARTMENT OF TRANSPORTATION  
SURVEY DIVISION

**FLOOD INFORMATION FORM**

Division #:	1 <input type="checkbox"/> 2 <input type="checkbox"/> 3 <input type="checkbox"/> 4 <input type="checkbox"/> 5 <input type="checkbox"/> 6 <input checked="" type="checkbox"/> 7 <input type="checkbox"/> 8 <input type="checkbox"/>
County:	Texas County
Date Highwater occurred:	6/19/2024
Highway Number:	S.H. 94
Name of Stream:	None
Direction and distance from nearest town, or highway junction	From approx. 2 miles. South of Hooker to 6 miles south of Hooker.
Section, Township, Range:	Section 15 T 4 N , R 17 E
Description of Location:	Approx. 4 Miles along S.H. 94, cultivation and pasture.
Latitude	36^50'03.36"N to 36^46'34.40"N
Longitude	101^ 12'20.95"W to 101^12'21.00"W
Highwater Elevation:	Approx. 2958' and 2943'
Level Datum & Source:	NAVD 88 (Computed using GEOID 12B)
Method used:	RTK (Base set on NGS Monument G 15)
Date Elevation Obtained:	7/10/2024
Apparent Magnitude:	Normal <input type="checkbox"/> Medium <input type="checkbox"/> Extreme <input checked="" type="checkbox"/> Unknown <input type="checkbox"/>
Was Highwater Mark obtained from actual water, drift, local resident, or other source?	We shot drift at S.H. 94 and E120 (Road L) HW approx. 2958' and drift found at S.H. 94 and pig farm north of E160 (Road P) HW approx. 2943'
Explanatory Remarks:	Rainfall estimated 7"-11" approx. 0.5' above highway for 4 miles.

Name (Signature)

*Kevin Fleck*

Name (Printed)

**Clinton Crew**

Date

**7/11/2024**

Note: Show Vicinity Map on back of form

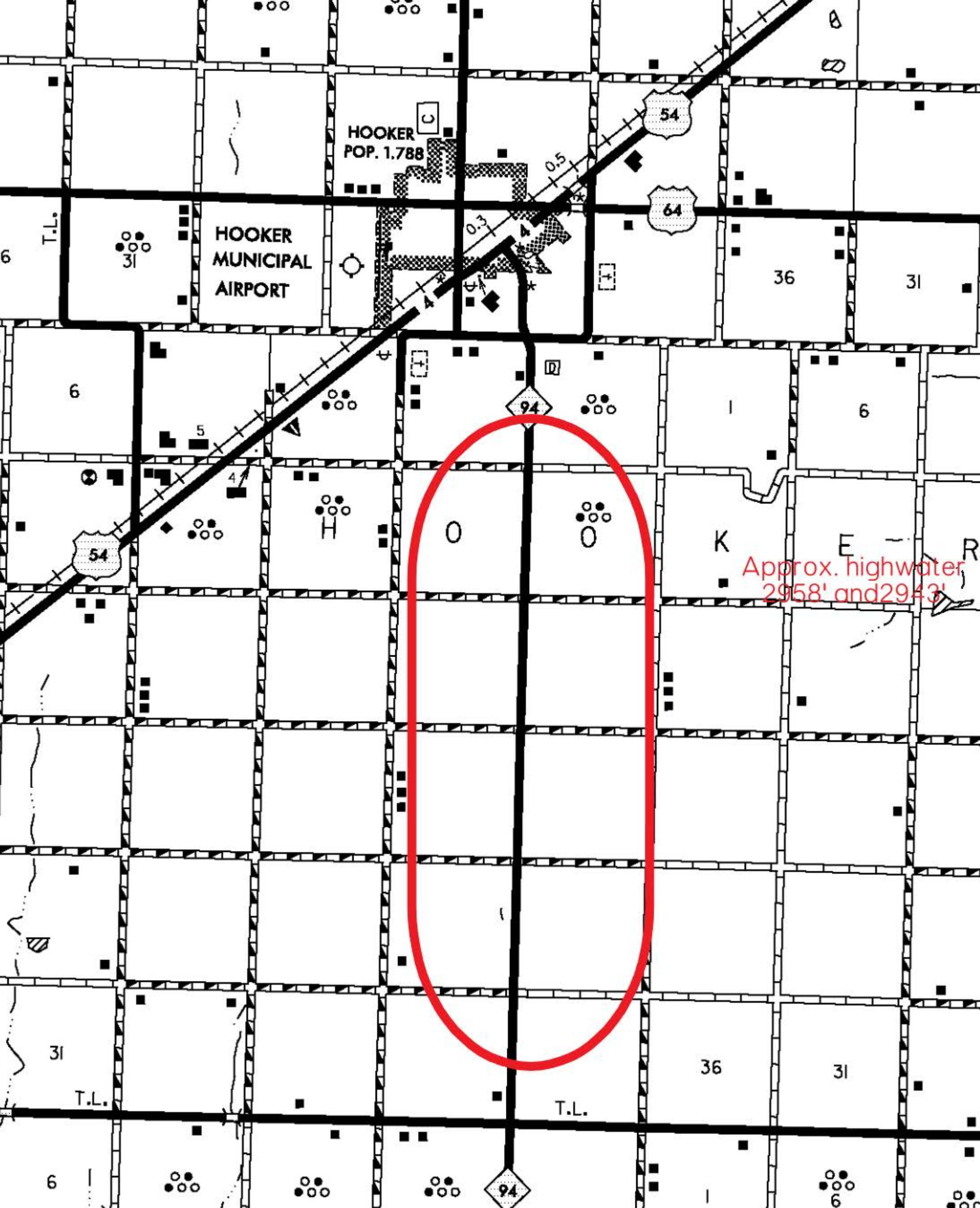

HOOKER  
POP. 1,788

HOOKER  
MUNICIPAL  
AIRPORT

Approx. highwater  
2958' and 2943'

