



OKLAHOMA DEPARTMENT OF TRANSPORTATION
SURVEY DIVISION

FLOOD INFORMATION FORM

District #:	1 <input type="checkbox"/> 2 <input type="checkbox"/> 3 <input type="checkbox"/> 4 <input type="checkbox"/> 5 <input type="checkbox"/> 6 <input type="checkbox"/> 7 <input checked="" type="checkbox"/> 8 <input type="checkbox"/>
County:	Stephens
Date Highwater occurred:	4/28/2021
Highway Number:	SH 53
Name of Stream:	Negro Creek
Direction and distance from nearest town, or highway junction	Approx. 0.5 Miles West of Loco, Oklahoma
Section, Township, Range:	Section 2 T 3 S , R 5 W
Description of Location:	Shots taken on centerline of highway
Latitude	34°20'49.79573" N
Longitude	097°43'33.03588" W
Highwater Elevation:	927.96'
Level Datum & Source:	
Method used:	GPS Network
Date Elevation Obtained:	
Apparent Magnitude:	Normal <input type="checkbox"/> Medium <input checked="" type="checkbox"/> Extreme <input type="checkbox"/> Unknown <input type="checkbox"/>
Was Highwater Mark obtained from actual water, drift, local resident, or other source?	Obtained from drift.
Explanatory Remarks:	Flash flood in that area.

Name (Signature) Lynn Hurley
Name (Printed) Lynn Hurley
Date 4-29-2021

Note: Show Vicinity Map on back of form

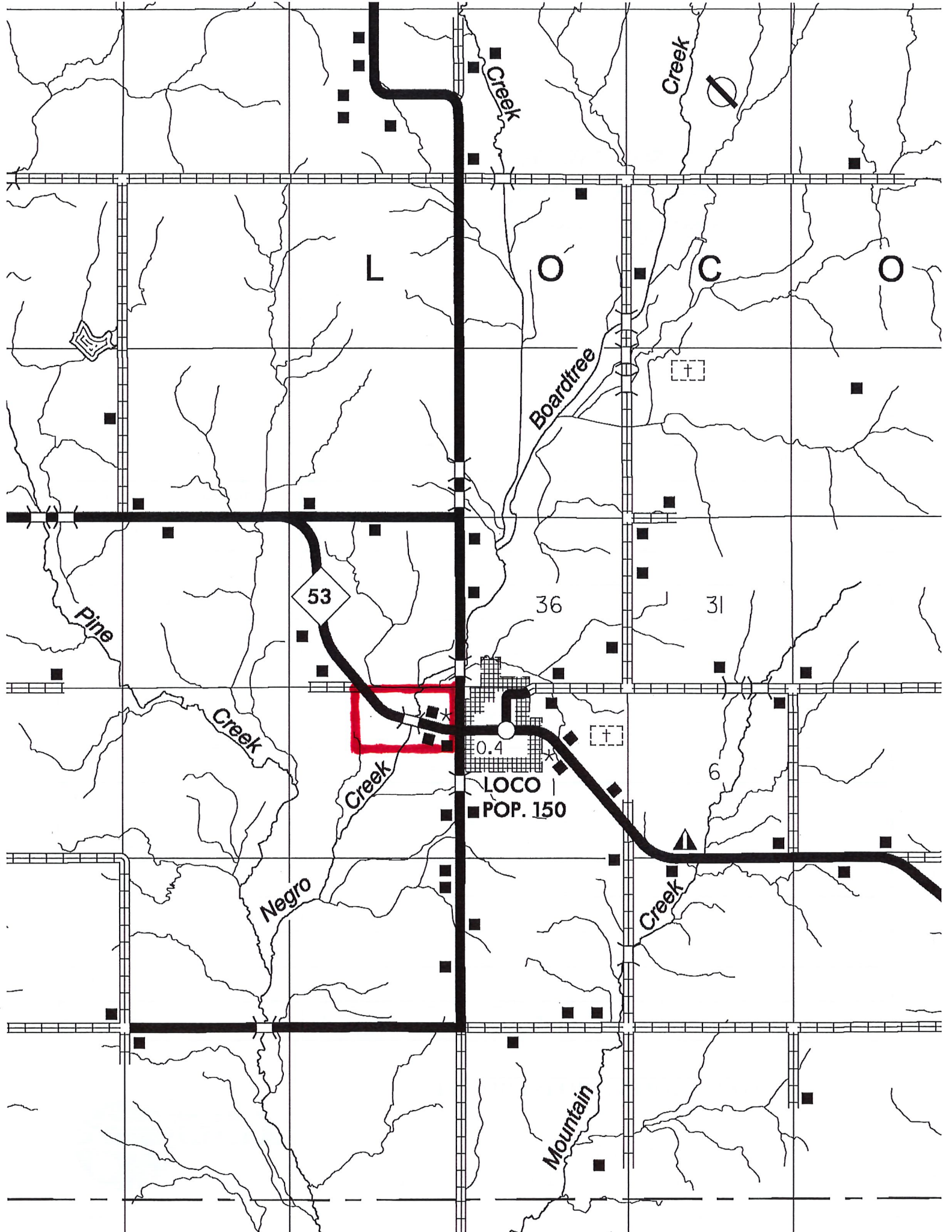

Creek

Creek

L

O

C

O

Boardtree

Pine

53

36

31

Creek

Creek

LOCO
POP. 150

6

Negro

Creek

Mountain