

STATE OF OKLAHOMA
DEPARTMENT OF HIGHWAYS
PLANS AND SURVEY DEPARTMENT

FLOOD INFORMATION FORM

To be used in obtaining and transmitting flood water elevations for Plans & Survey office record files. This information to be obtained by all Chiefs of Party in their vicinity in times of unusual high water, or at any time available from a reliable source. The elevations can be recorded by level reading, by measurement from bridge floor, in relation to a house, above roadbed or any other dependable, clear manner that fits the situation, the highest order possible to be used. Separate report to be made on each crossing or place obtained.

County Stephens ~~Comanche~~ Date highwater occurred May 10, 1950

Highway number U.S. 81 Name of stream Back Water from Owl Creek

Direction and distance from nearest town, village or store At the south
Edge of Comanche

Section, Township and Range _____

Description of Location H.W. was taken At the intersection of U.S. 81
And Hickory Ave At 2 x 2 Culvert At the south Property line of Hickory Ave

Method obtained Level Readings

Elevation 5.3 Above ~~2~~ of Pavement Source of levels at the culvert

Was highwater mark obtained from actual water, drift, local resident, U. S. Engineers, etc? H.W. was taken from Marks on Service Station

Buildings And silt Deposit on Pavement Just south of the
Intersection of 3rd St & Willow Ave in Comanche
Explanatory Remarks _____

Location to be shown on back of this sheet as a check.

Field Note: To be sent to Engr. of Plans & Survey (1 copy).
Office Note: To be filed in Flood Information by Counties.

C. S. WORTHAM
C. S. WORTHAM, Chief of Party
Ass't. Engr. of Plans & Surveys

Date _____

Plan A Survey
from 1896
1896

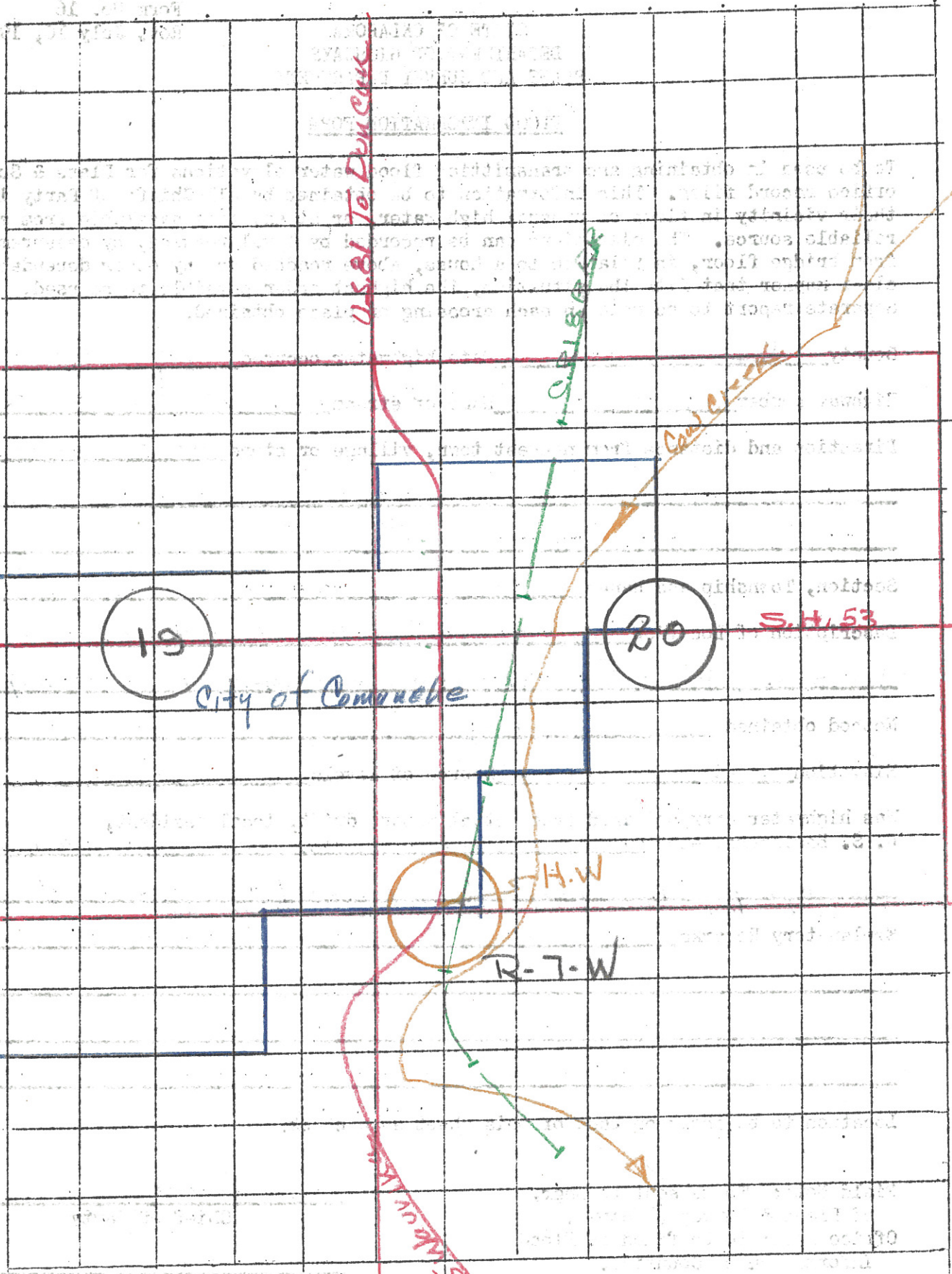

U.S. & Duane

S. 18th St

Cass Creek

19

20

City of Commerce

S.H. 53

H.W.

R-7-W

Kearney Ave

T
2
5