

STATE OF OKLAHOMA  
DEPARTMENT OF HIGHWAYS  
PLANS AND SURVEY DEPARTMENT

FLOOD INFORMATION FORM

To be used in obtaining and transmitting flood water elevations for Plans & Survey office record files. This information to be obtained by all Chiefs of Party in their vicinity in times of unusual high water, or at any time available from a reliable source. The elevations can be recorded by level reading, by measurement from bridge floor, in relation to a house, above roadbed or any other dependable, clear manner that fits the situation, the highest order possible to be used. Separate report to be made on each crossing or place obtained.

County Stephens Date highwater occurred May 10, 1950

Highway number New hwy U.S. 81 Name of stream Branch of Coal Creek

Direction and distance from nearest town, village or store on West Main St in Duncan

Section, Township and Range \_\_\_\_\_

Description of Location At Timber Bridge Approx 300' west of the Point where S.W. 1368-(2) Crosses Main St

Method obtained "Y" level shots on H.W.

Elevation 1099.1 Source of levels U.S.C. & G.S. From S.W. 1368(2)

Was highwater mark obtained from actual water, drift, local resident, U. S. Engineers, etc? H.W. was obtained from Mark on House Just west of the Creek

Explanatory Remarks \_\_\_\_\_

Location to be shown on back of this sheet as a check.

Field Note: To be sent to Engr. of Plans & Survey (1 copy).  
Office Note: To be filed in Flood Information by Counties.

C. S. Wortham  
C. S. WORTHAM, Chief of Party  
Ass't. Engr. of Plans & Surveys  
May 26, 1950  
Date

State of Oklahoma  
Department of Highways  
Tulsa, Oklahoma

STATE OF OKLAHOMA  
DEPARTMENT OF HIGHWAYS  
TULSA, OKLAHOMA

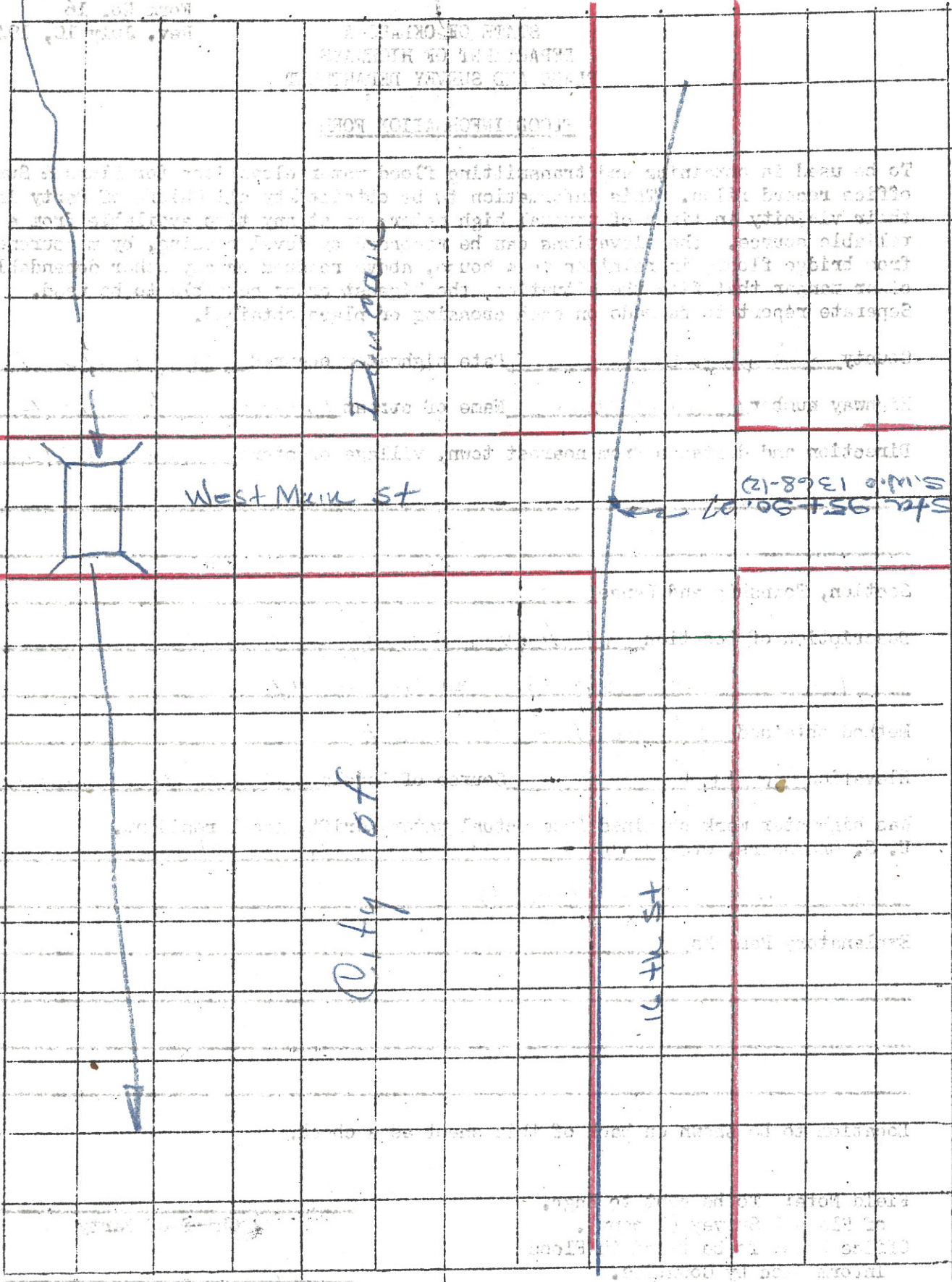

West Main St

St. 95+50.07  
S.M. 1368-12

City of

16th St

House  
H.W. Davis  
Tulsa, Okla