

STATE OF OKLAHOMA
DEPARTMENT OF HIGHWAYS
SURVEY DIVISION

FLOOD INFORMATION FORM

To be used in obtaining and transmitting flood water elevations for Survey Division office record files. This information to be obtained by all Chiefs of Party or others in their vicinity in times of unusual high water, or at any time available from a reliable source. The elevations can be recorded by level reading, by measurement from bridge floor, in relation to a house, above roadbed or any other dependable, clear manner that fits the situation, the highest order possible to be used. Separate report to be made on each crossing or place obtained.

County Stephens Date highwater occurred April 12, 1967

Highway number SH 53 Name of stream Dry Creek

Direction and distance from nearest town, village or store Approx. 3.2 miles west of the intersection of SH 53 and US 81 in Commanche, Oklahoma. At the Dry Creek bridge on SH 53.

Section, Township and Range Between section 27&22, T2S, R8W.

Description of Location Down 14.0 feet from the bridge floor.

Elevation _____ Source of levels _____

Method obtained Tape Date obtained April 14, 1967

Did it appear to be normal medium extreme do not know

Was highwater mark obtained from actual water, drift, local resident, U. S. Engineers, etc.? Drifts

Explanatory Remarks _____

SURVEY DIVISION	
GHS	
WAV	5-467
WNM	5-967
GWP	
OCC	
GER	
SDD	
IDW	
DP	
BM	
CB	

Location to be shown on back of this sheet as a check.

Field Note: To be sent to Survey Engineer

Location Engineer
April 17, 1967
Date

LOCATION N NO. 2

R9W

R8W

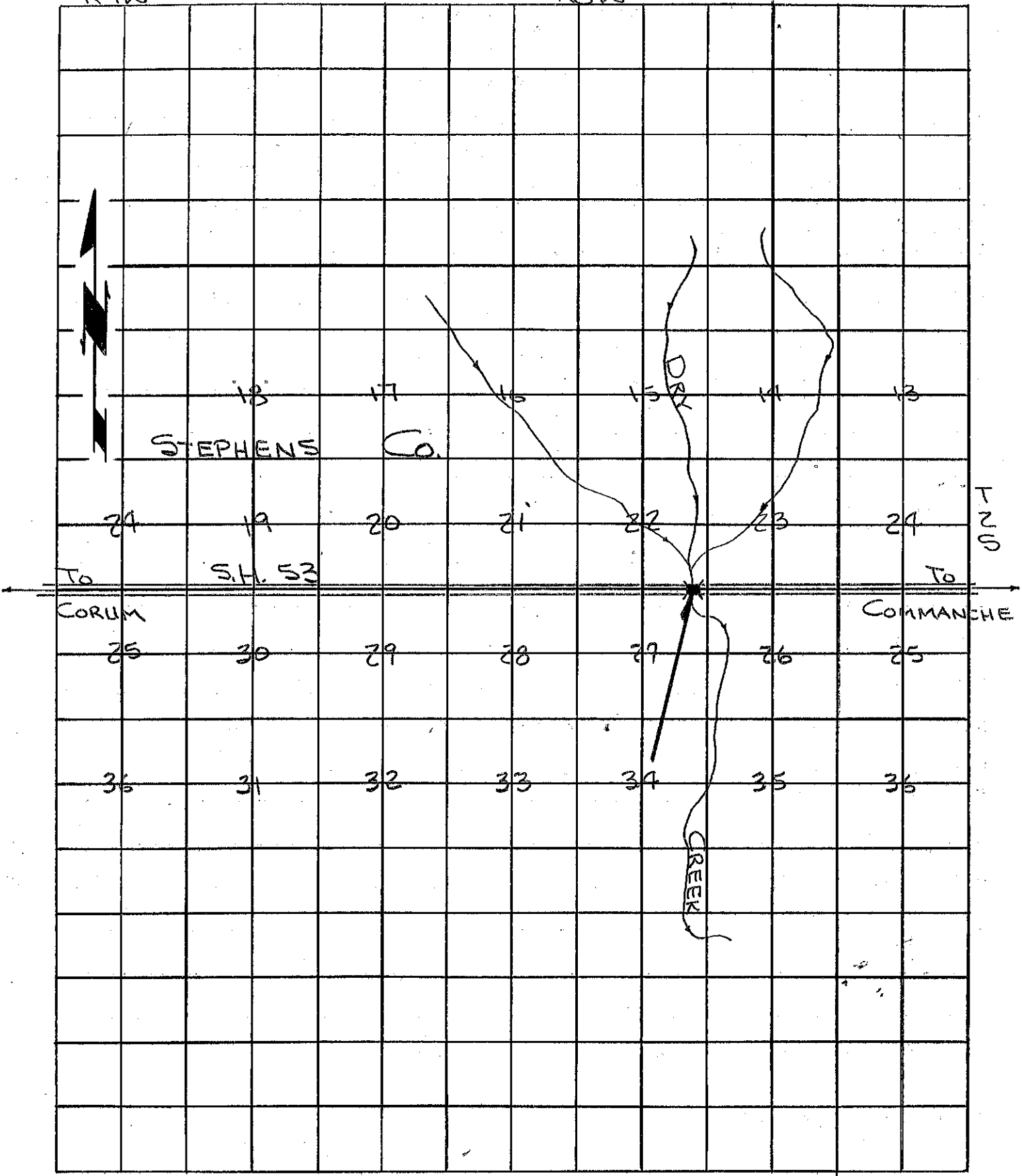

STEPHENS Co.

SH. 53

To CORUM

To COMMANCHE

T2S

DRY

CREEK

