

STATE OF OKLAHOMA
DEPARTMENT OF HIGHWAYS
SURVEY DIVISION

FLOOD INFORMATION FORM

To be used in obtaining and transmitting flood water elevations for Survey Division office record files. This information to be obtained by all Chiefs of Party or others in their vicinity in times of unusual high water, or at any time available from a reliable source. The elevations can be recorded by level reading, by measurement from bridge floor, in relation to a house, above roadbed or any other dependable, clear manner that fits the situation, the highest order possible to be used. Separate report to be made on each crossing or place obtained.

County STEPHENS Date highwater occurred 10-20-83

Highway number SH 7 Name of stream STAGE STAND CREEK

Direction and distance from nearest town, village or store 4.1 MILES WEST OF THE JCT. OF US 81 & SH.7 WEST, NORTH OF DUNCAN

Section, Township and Range SEC. 33, T2N, R8W

Description of Location AT THE NW BRIDGE SEAT

Elevation 1103.7 Source of levels USC&GS SAP 1149(1) PLANS

Method obtained Y-LEVEL Date obtained 10-26-83

Did it appear to be normal medium extreme do not know

Was highwater mark obtained from actual water, drift, local resident, U. S. Engineers, etc.? ACTUAL WATER MARK

Explanatory Remarks _____

Location to be shown on back of this sheet as a check.

Field Note: To be sent to
Survey Engineer

Bobby Earl Garland
Chief of Party

Copy to Bridge 12-13-83
A2

NOV. 17, 1983
Date

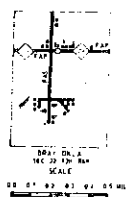
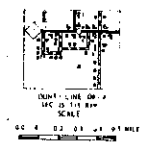
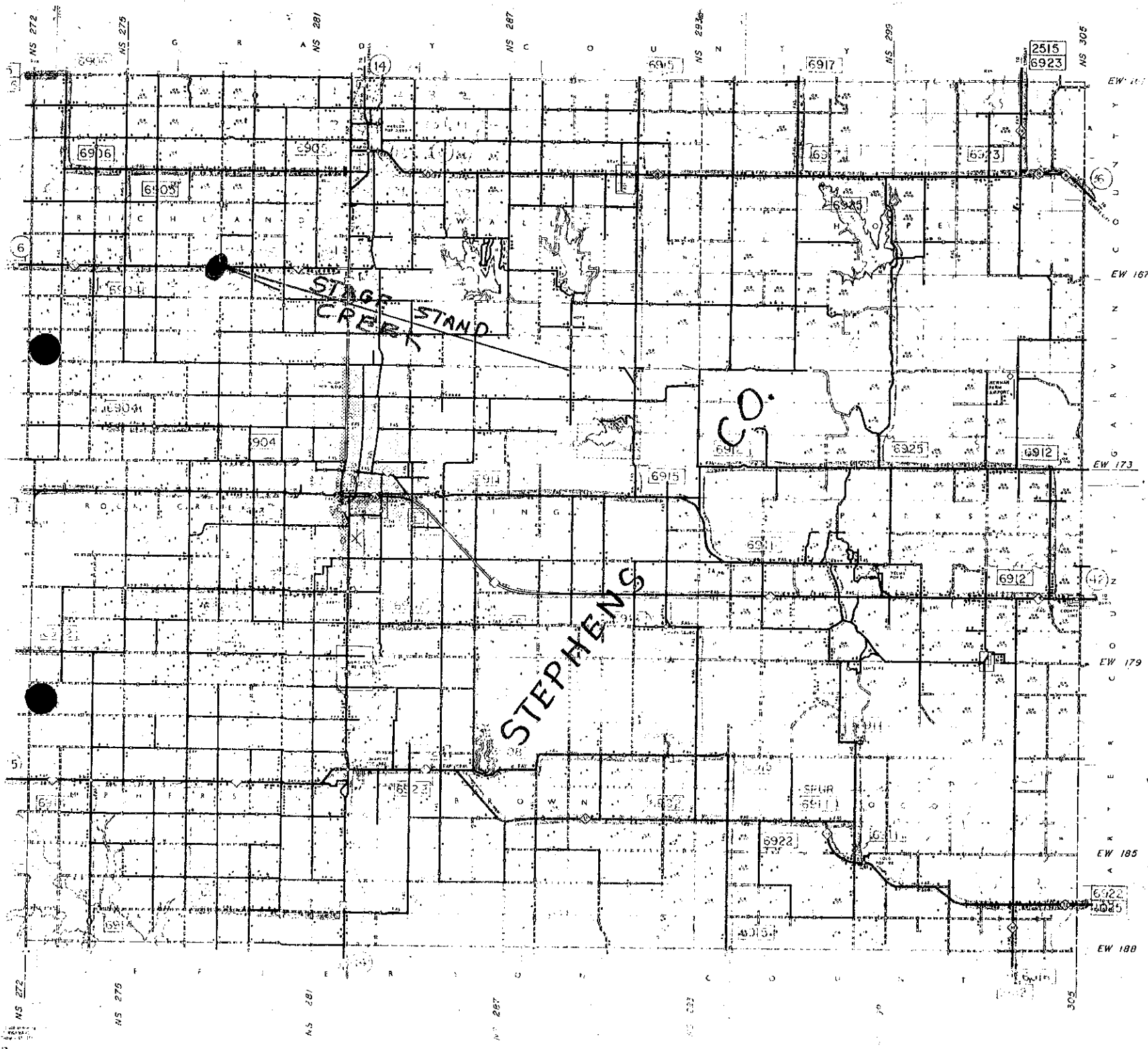

- REVISIONS
- | | | |
|---------|-----|-----------|
| DATE | BY | REVISIONS |
| 12-1-84 | ... | ... |
| 1-1-85 | ... | ... |
| 3-1-85 | ... | ... |
| 5-1-85 | ... | ... |
| 7-1-85 | ... | ... |
| 9-1-85 | ... | ... |
| 11-1-85 | ... | ... |
| 1-1-86 | ... | ... |
| 3-1-86 | ... | ... |
| 5-1-86 | ... | ... |
| 7-1-86 | ... | ... |
| 9-1-86 | ... | ... |
| 11-1-86 | ... | ... |

FAI...
E.A.S. SYSTEM
HIA SYSTEM
LIBRARY