



OKLAHOMA DEPARTMENT OF TRANSPORTATION
SURVEY DIVISION

FLOOD INFORMATION FORM

Division #:	1 <input checked="" type="checkbox"/> 2 <input type="checkbox"/> 3 <input type="checkbox"/> 4 <input type="checkbox"/> 5 <input type="checkbox"/> 6 <input type="checkbox"/> 7 <input type="checkbox"/> 8 <input type="checkbox"/>
County:	Sequoyah
Date Highwater occurred:	5/28/2019
Highway Number:	US 64
Name of Stream:	Arkansas River Backwater
Direction and distance from nearest town, or highway junction	2.3 Miles East along US 64 from the Jct. of US 64 & I-40 at overflow bridge.
Section, Township, Range:	Section 19, T-11N, R-27E
Description of Location:	US 64
Highwater Elevation:	422.40'
Level Datum & Source:	NGS Monument S200
Method used:	Differential Leveling
Date Elevation Obtained:	5/28/2019
Apparent Magnitude:	Normal <input type="checkbox"/> Medium <input type="checkbox"/> Extreme <input checked="" type="checkbox"/> Don't Know <input type="checkbox"/>
Was Highwater Mark obtained from actual water, drift, local resident, or other source?	Actual Water
Explanatory Remarks:	State Plane Coordinates N: 166327.4384 E: 3014257.4568

Note: Show Vicinity Map on back of form

Name (signature) _____

Name (Printed)

Date:

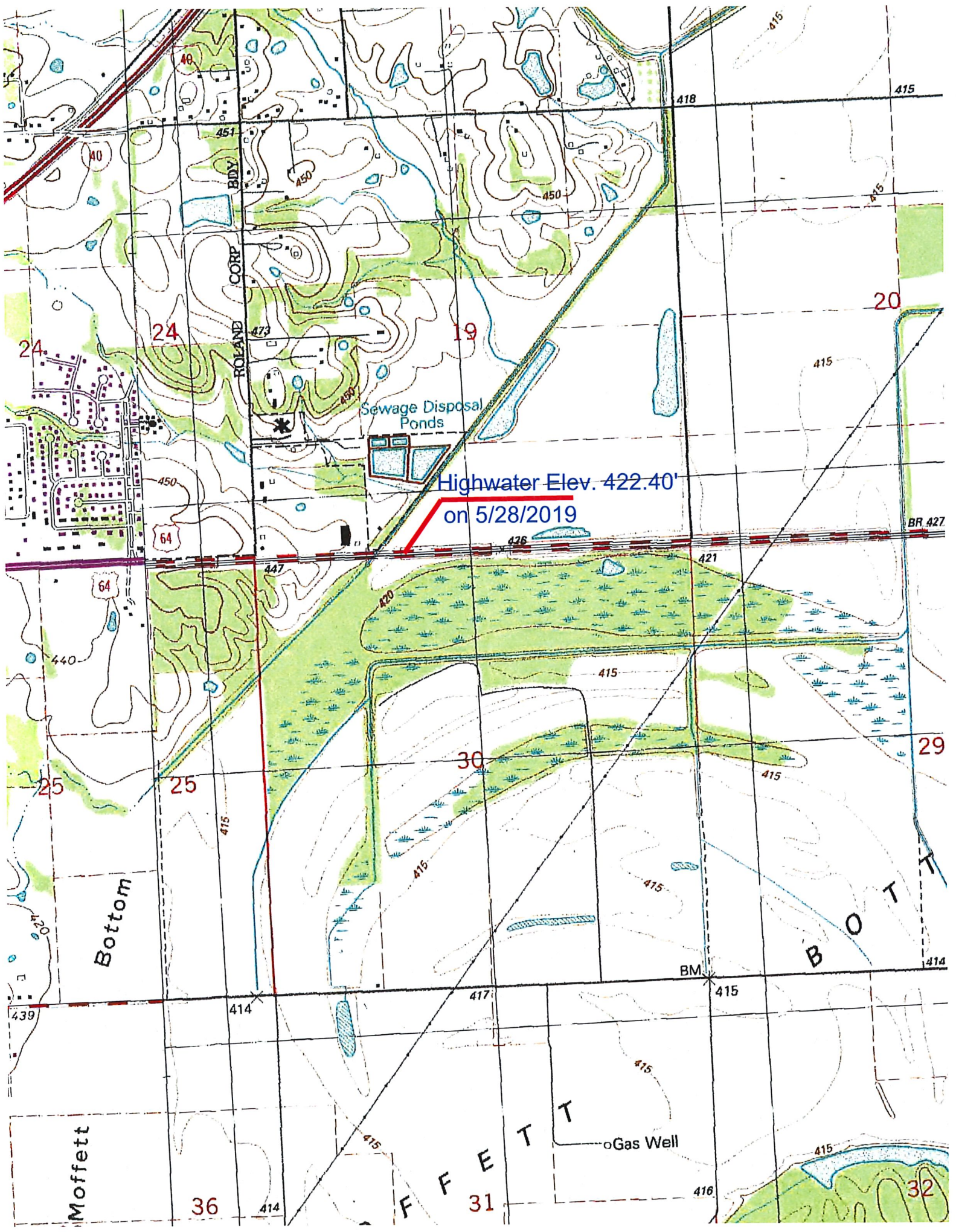

Highwater Elev. 422.40'
on 5/28/2019

Sewage Disposal Ponds

Gas Well

Bottom

B O T T O M

Moffett

F F E T T

