



**OKLAHOMA DEPARTMENT OF TRANSPORTATION
SURVEY DIVISION**

FLOOD INFORMATION FORM

Division #:	1 <input checked="" type="checkbox"/> 2 <input type="checkbox"/> 3 <input type="checkbox"/> 4 <input type="checkbox"/> 5 <input type="checkbox"/> 6 <input type="checkbox"/> 7 <input type="checkbox"/> 8 <input type="checkbox"/>
County:	Sequoyah
Date Highwater occurred:	5/28/2019
Highway Number:	County Rd / N4520RD
Name of Stream:	Arkansas River Backwater
Direction and distance from nearest town, or highway junction	From the Jct. of I-40 and SH82 2.5 miles South At the Sequoyah Wildlife Refuge
Section, Township, Range:	Section 4, T-11N, R-22E
Description of Location:	N4520RD
Highwater Elevation:	467.44'
Level Datum & Source:	NAVD 88, Geoid 12B
Method used:	GPS/OPUS_RS
Date Elevation Obtained:	5/28/2019
Apparent Magnitude:	Normal <input type="checkbox"/> Medium <input type="checkbox"/> Extreme <input checked="" type="checkbox"/> Don't Know <input type="checkbox"/>
Was Highwater Mark obtained from actual water, drift, local resident, or other source?	Drift line and chief of headquarters testimony
Explanatory Remarks:	State Plane Coordinates N: 178832.8116, E: 2869821.7633

Note: Show Vicinity Map on back of form

Name (signature) 
 Name (Printed) _____
 Date: 6/05/2019

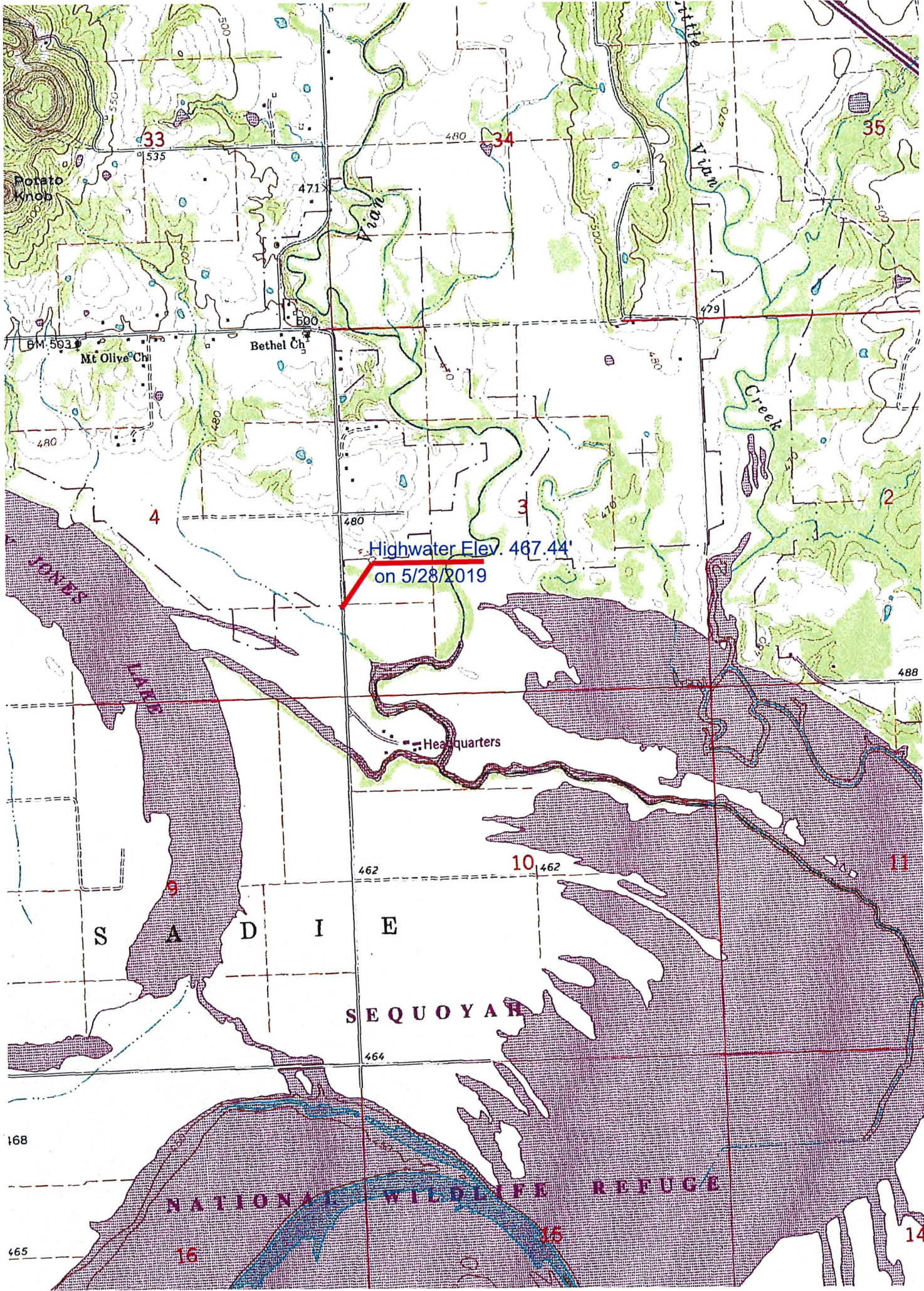

Highwater Elev. 467.44'
on 5/28/2019

S A D I E

SEQUOYAH

NATIONAL WILDLIFE REFUGE

HEADQUARTERS