



OKLAHOMA DEPARTMENT OF TRANSPORTATION
SURVEY DIVISION

FLOOD INFORMATION FORM

Division #:	1 <input checked="" type="checkbox"/> 2 <input type="checkbox"/> 3 <input type="checkbox"/> 4 <input type="checkbox"/> 5 <input type="checkbox"/> 6 <input type="checkbox"/> 7 <input type="checkbox"/> 8 <input type="checkbox"/>
County:	Sequoyah
Date Highwater occurred:	8/13/2017
Highway Number:	US 59
Name of Stream:	N/A
Direction and distance from nearest town, or highway junction	1.7 Miles South of the Jct. of US 59 & I-40.
Section, Township, Range:	Section 18 T 11 N , R 24 E
Description of Location:	Water got up to the Centerline of the North Bound Lane.
Latitude	35 25 25.51"
Longitude	94 48 20.41"
Highwater Elevation:	475.18'
Level Datum & Source:	NAVD88/SWO 5238(1)
Method used:	RTK
Date Elevation Obtained:	8/14/2017
Apparent Magnitude:	Normal <input type="checkbox"/> Medium <input type="checkbox"/> Extreme <input checked="" type="checkbox"/> Unknown <input type="checkbox"/>
Was Highwater Mark obtained from actual water, drift, local resident, or other source?	Drift Mark
Explanatory Remarks:	

Name (Signature) 
 Name (Printed) Shannon D. Harris
 Date 8/15/2017

Note: Show Vicinity Map on back of form

516

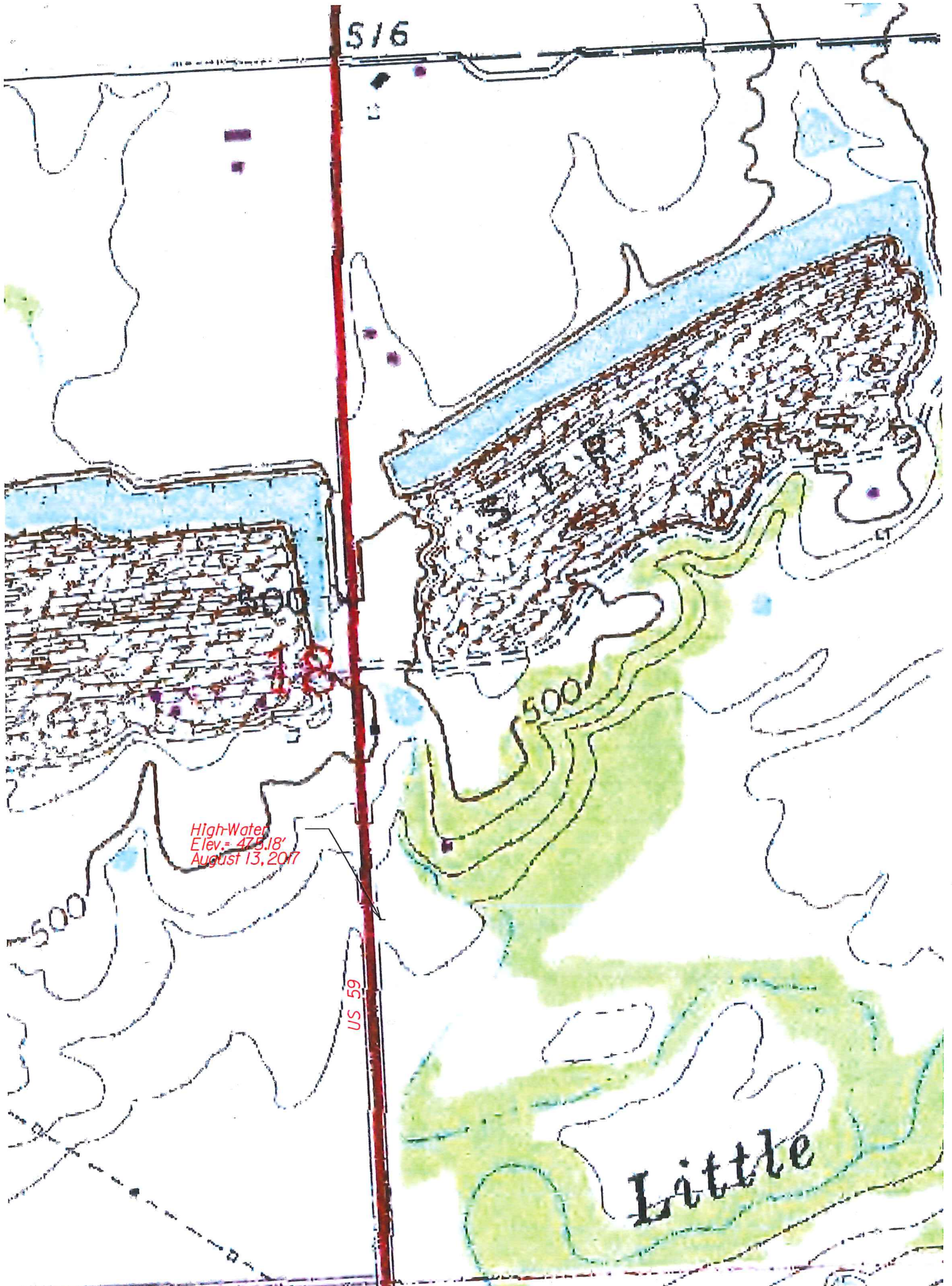

High-Water
Elev.: 475.18'
August 13, 2017

US 59

Little