



OKLAHOMA DEPARTMENT OF TRANSPORTATION
SURVEY DIVISION

FLOOD INFORMATION FORM

Division #:	1 X 2 <input type="checkbox"/> 3 <input type="checkbox"/> 4 <input type="checkbox"/> 5 <input type="checkbox"/> 6 <input type="checkbox"/> 7 <input type="checkbox"/> 8 <input type="checkbox"/>
County:	Sequoyah
Date Highwater occurred:	5/30/2015
Highway Number:	64D
Name of Stream:	Arkansas River Back Water
Direction and distance from nearest town, or highway junction	From the Jct. of I-40 and 64D Southerly along 64D 1.9 miles
Section, Township, Range:	Section 15, T-9N, R-27E
Description of Location:	64D
Highwater Elevation:	409.86'
Level Datum & Source:	NAVD 88, Geoid 12B
Method used:	GPS/OPUS_RS
Date Elevation Obtained:	6/1/2015
Apparent Magnitude:	Normal <input type="checkbox"/> Medium <input type="checkbox"/> Extreme X Don't Know <input type="checkbox"/>
Was Highwater Mark obtained from actual water, drift, local resident, or other source?	Drift
Explanatory Remarks:	State Plane Coordinates: N: 174 394.0016, E: 3 029 610.28

Note: Show Vicinity Map on back of form

Name (signature) 

Name (Printed) Shannon D Harris

Date: 6-22-15

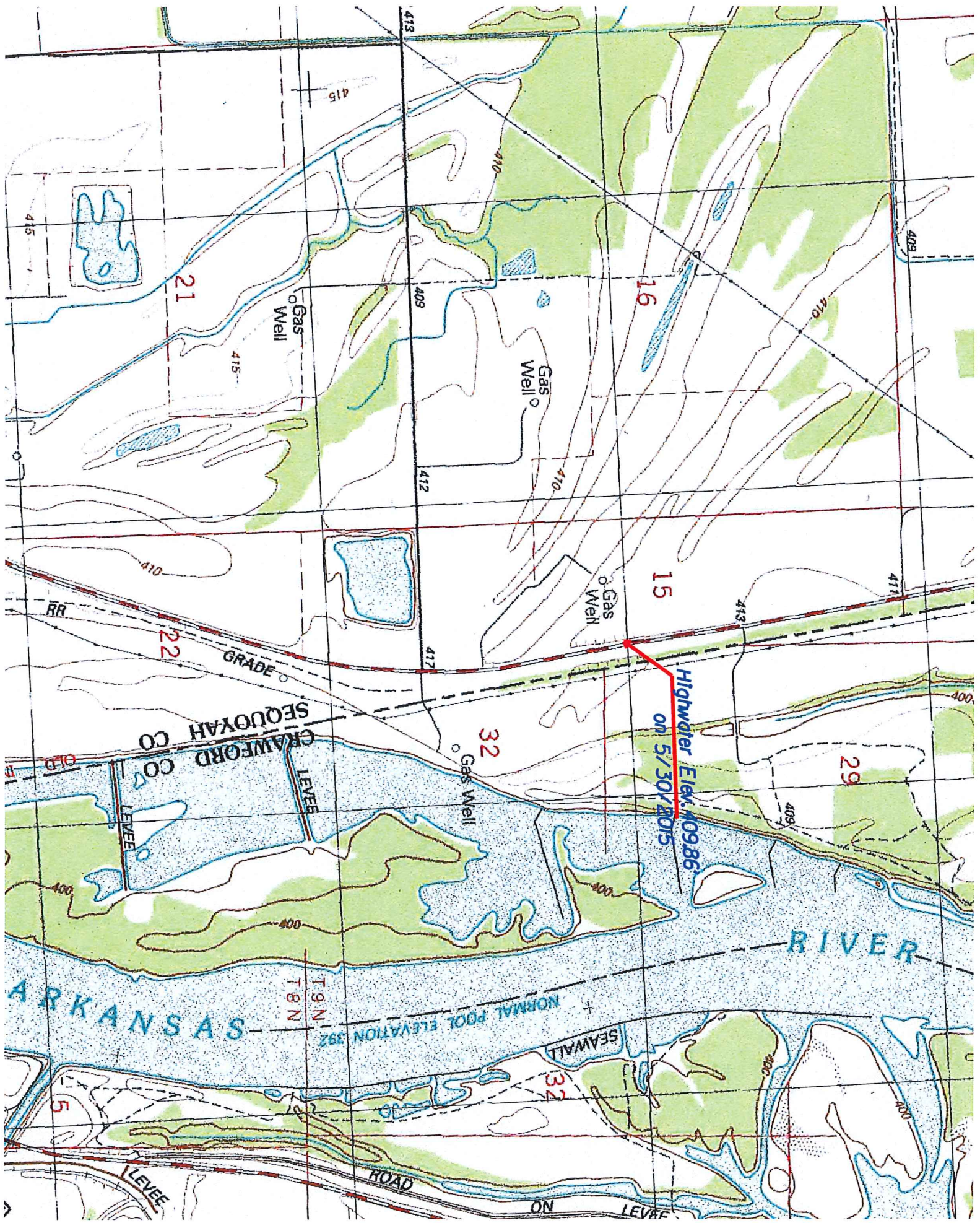

21

16

15

22

29

32

ARKANSAS

RIVER

T 9 N

T 8 N

NORMAL POOL ELEVATION 392

SEAWALL

33

LEVEE

ROAD

ON LEVEE

Gas Well

Gas Well

Gas Well

Gas Well

RR

GRADE

CRAWFORD CO
SEQUOYAH CO

LEVEE

LEVEE

Highwater Elev. 409.86
on 5/30/2015