

STATE OF OKLAHOMA
DEPARTMENT OF HIGHWAYS
SURVEY DIVISION

Survey Division
Form No. 16
Rev. Dec. 2, 1974

FLOOD INFORMATION FORM

To be used in obtaining and transmitting flood water elevations for Survey Division office record files. This information to be obtained by all Chiefs of Party or others in their vicinity in times of unusual high water, or at any time available from a reliable source. The elevations can be recorded by level reading, by measurement from bridge floor, in relation to a house, above roadbed or any other dependable, clear manner that fits the situation, the highest order possible to be used. Separate report to be made on each crossing or place obtained.

County Sequoyah Date highwater occurred 5/2/1990

Highway number U.S. 64 Name of stream unknown

Direction and distance from nearest town, village or store approx. 0.6 miles west of Vian

Section, Township and Range Sec 21 T12N R22E

Description of Location Approx. 0.6 miles west of jct. S.H. 82 and U.S. 64 in Vian on U.S. 64, first drain crossing west of town.

Elevation _____ Source of levels _____

Method obtained Fennel Level Date obtained 5/3/1990

Did it appear to be normal medium extreme do not know

Was highwater mark obtained from actual water, drift, local resident, U. S. Engineers, etc.? actual water.

Explanatory Remarks Top water was up 2:2 from top hdwl. but did not get over the road.

Location to be shown on back of this sheet as a check.

Field Note: To be sent to
Survey Engineer

Jan [Signature]
Professional Land Surveyor

Copy to Bridge Div. 6-19-90

6/13/90
Date

Copy with map to Bridge 8-9-90

LOCATION No. 11

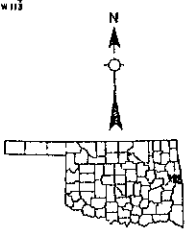
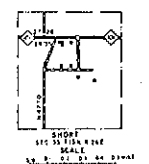
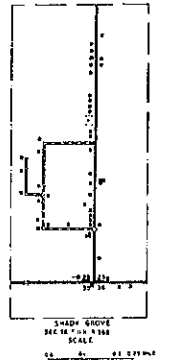
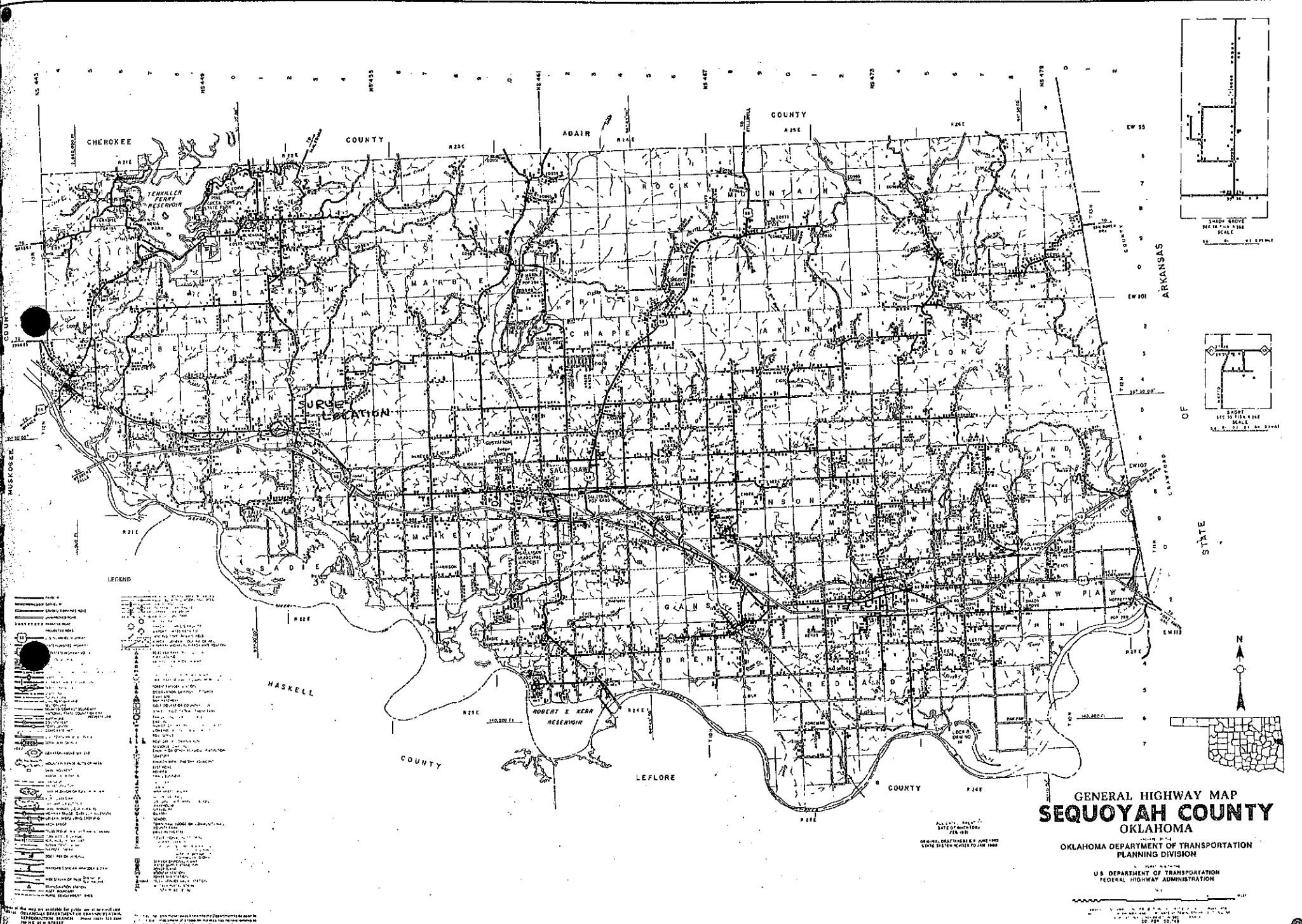

LEGEND

	INTERSTATE HIGHWAY
	U.S. HIGHWAY
	STATE HIGHWAY
	COUNTY ROAD
	ROAD
	RIVER
	LAKE/RESERVOIR
	CITY
	TOWN
	VILLAGE
	UNINCORPORATED COMMUNITY
	SCHOOL
	CHURCH
	CEMETERY
	PUBLIC BUILDING
	GAS STATION
	TELEPHONE EXCHANGE
	POWER LINE
	RAILROAD
	PIPELINE
	CONTOUR LINE
	SPOT ELEVATION
	BOUNDARY

**GENERAL HIGHWAY MAP
SEQUOYAH COUNTY
OKLAHOMA**

OKLAHOMA DEPARTMENT OF TRANSPORTATION
PLANNING DIVISION

ALL DATA FROM
DATE OF SURVEY
JULY 1952
ORIGINAL DRAFTED BY JUNE 1952
STATE HIGHWAY DIVISION

U.S. DEPARTMENT OF TRANSPORTATION
FEDERAL HIGHWAY ADMINISTRATION