



OKLAHOMA DEPARTMENT OF TRANSPORTATION
SURVEY DIVISION

FLOOD INFORMATION FORM

Division #:	1 X 2 <input type="checkbox"/> 3 <input type="checkbox"/> 4 <input type="checkbox"/> 5 <input type="checkbox"/> 6 <input type="checkbox"/> 7 <input type="checkbox"/> 8
County:	Sequoyah
Date Highwater occurred:	9/9/10
Highway Number:	SH141
Name of Stream:	NA
Direction and distance from nearest town, or highway junction	4.6 miles east of Jct. of SH141 and SH 59
Section, Township, Range:	Section 36 T-11-N, R-24-E
Description of Location:	Located in the W1/2 of Section 36
Highwater Elevation:	485.7'
Level Datum & Source:	NAVD88 - OPUS
Method used:	GPS (STATIC)
Date Elevation Obtained:	9/14/10
Apparent Magnitude:	Normal <input type="checkbox"/> Medium Extreme X Don't Know <input type="checkbox"/>
Was Highwater Mark obtained from actual water, drift, local resident, or other source?	Highwater was obtained by drift marks.
Explanatory Remarks:	

Note: Show Vicinity Map on back of form

Name (signature)

Name (Printed)

Darin K. Stratton, PLS

Date:

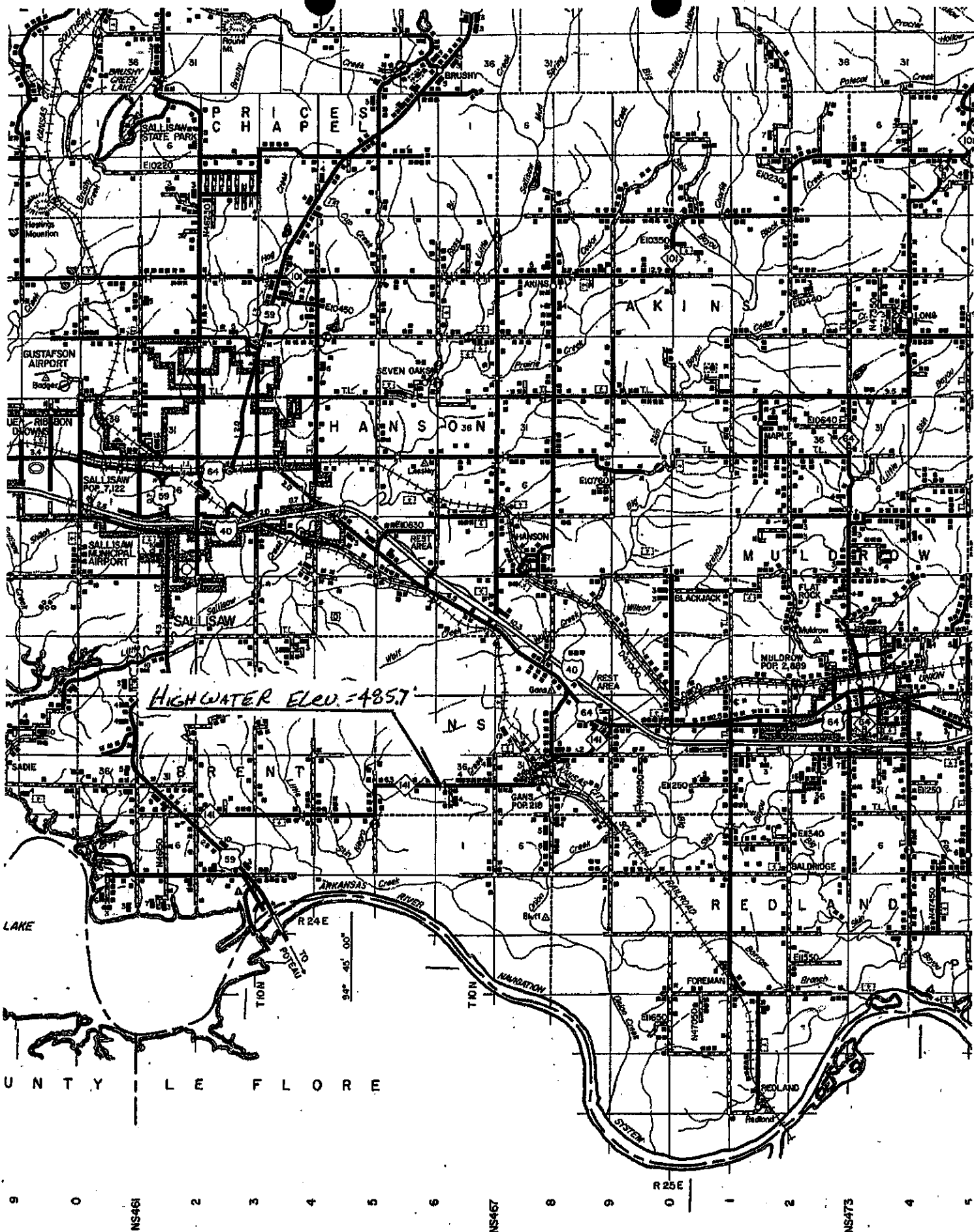

HIGH WATER ELEV. = 485.7

COUNTY OF FLORENCE

9 0 NS461 2 3 4 5 6 NS467 8 9 R 25E 0 1 2 NS473 4 5