

SURVEY DIVISION
 MAY 28 1968
 6-17-68
 6-17-68
 6-24-68
 CHS
 AV
 VM
 P
 OCC
 ER
 SDD
 RDA
 HFJ
 GSS

STATE OF OKLAHOMA
 DEPARTMENT OF HIGHWAYS
 SURVEY DIVISION

Survey Division
 Form No. 16
 Rev. Sept. 10, 1961

MAY 28 1968
 SURVEY DIVISION

FLOOD INFORMATION FORM

To be used in obtaining and transmitting flood water elevations for Survey Division office record files. This information to be obtained by all Chiefs of Party or others in their vicinity in times of unusual high water, or at any time available from a reliable source. The elevations can be recorded by level reading, by measurement from bridge floor, in relation to a house, above roadbed or any other dependable, clear manner that fits the situation, the highest order possible to be used. Separate report to be made on each crossing or place obtained.

County Seminole Date highwater occurred May 13, 1968

Highway number SH # 99 Name of stream Jumper Creek

Direction and distance from nearest town, village or store Approx. 1.0 Mile North of Konawa From the Jct Of SH # 99 & 39

Section, Township and Range Section 26 T 6 N R 5 E

Description of Location Highwater Obtained At The Existing Bridge Across Jumper Creek On SH 99 Approx. 1.0 Mile North Of Konawa, Oklahoma

Elevation N. A. Source of levels _____

Method obtained Eng' - Level Date obtained May 20, 1968

Did it appear to be normal medium extreme do not know

Was highwater mark obtained from actual water, drift, local resident, U. S. Engineers, etc.? Drift

Explanatory Remarks Extreme Highwater is 1.3 Above BM "X" on the Center Line of East Head wall of existing Bridge Section 26 T 6 N R 5 E

Location to be shown on back of this sheet as a check.

Field Note: To be sent to Survey Engineer

Chief of Party

May 20, 1968
 Date

SWO - NONE
 Project - SAP 744 A

LOCATION NO. 1

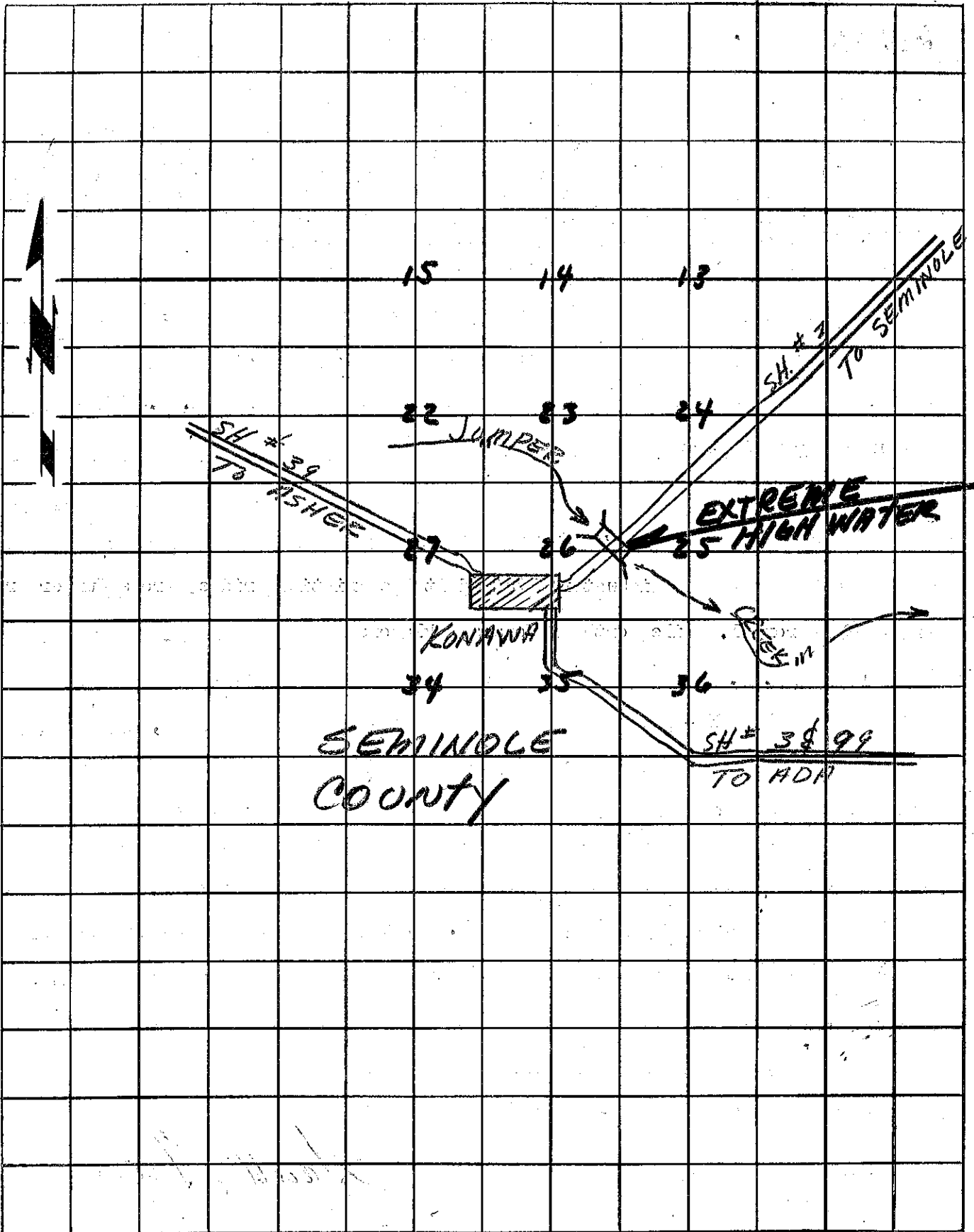

T
6
N

R 5 E