

STATE OF OKLAHOMA  
DEPARTMENT OF HIGHWAYS  
SURVEY DIVISION

Survey Division  
Form No. 16  
Rev. Sept. 10, 1961

FLOOD INFORMATION FORM

Minus  
0.41  
From This  
Elev

To be used in obtaining and transmitting flood water elevations for Survey Division office record files. This information to be obtained by all Chiefs of Party or others in their vicinity in times of unusual high water, or at any time available from a reliable source. The elevations can be recorded by level reading, by measurement from bridge floor, in relation to a house, above roadbed or any other dependable, clear manner that fits the situation, the highest order possible to be used. Separate report to be made on each crossing or place obtained.

County Seminole Date highwater occurred May 14th, 1968

Highway number SH # 99 Name of stream salt Creek

Direction and distance from nearest town, village or store 6. 3/4 Miles South  
of Bowlegs.

Section, Township and Range Sec. 28-27 T 7 N - R 6 E

Description of Location salt Creek out on North & South side of Highway

Bridge closing SH 99 for approximately 24 Hours.

Elevation South Side 815.19  
North Side 811.01 Source of levels Level Datum in Mean Sea Level USO&GS

Method obtained " v " Level Date obtained May 14th, 1968

Did it appear to be  normal  medium  extreme  do not know

Was highwater mark obtained from actual water, drift, local resident,  
U. S. Engineers, etc.? Actual Water

Explanatory Remarks Actual High Water taken after Four or Five Days of rain, on  
each side of overflow 3/4 mile apart. Elevation on south side of Creek 815.19 -  
Elevation on North side of Creek was 811.01. Both Elevation taken from the Conc  
Pavement (SH 99)

Location to be shown on back of this sheet as a check.

Field Note: To be sent to  
Survey Engineer

J. S. O'Gwin  
Chief of Party

FILE: FLOOD INFORMATION - SEMINOLE CO. ←

Date

5-4-1968

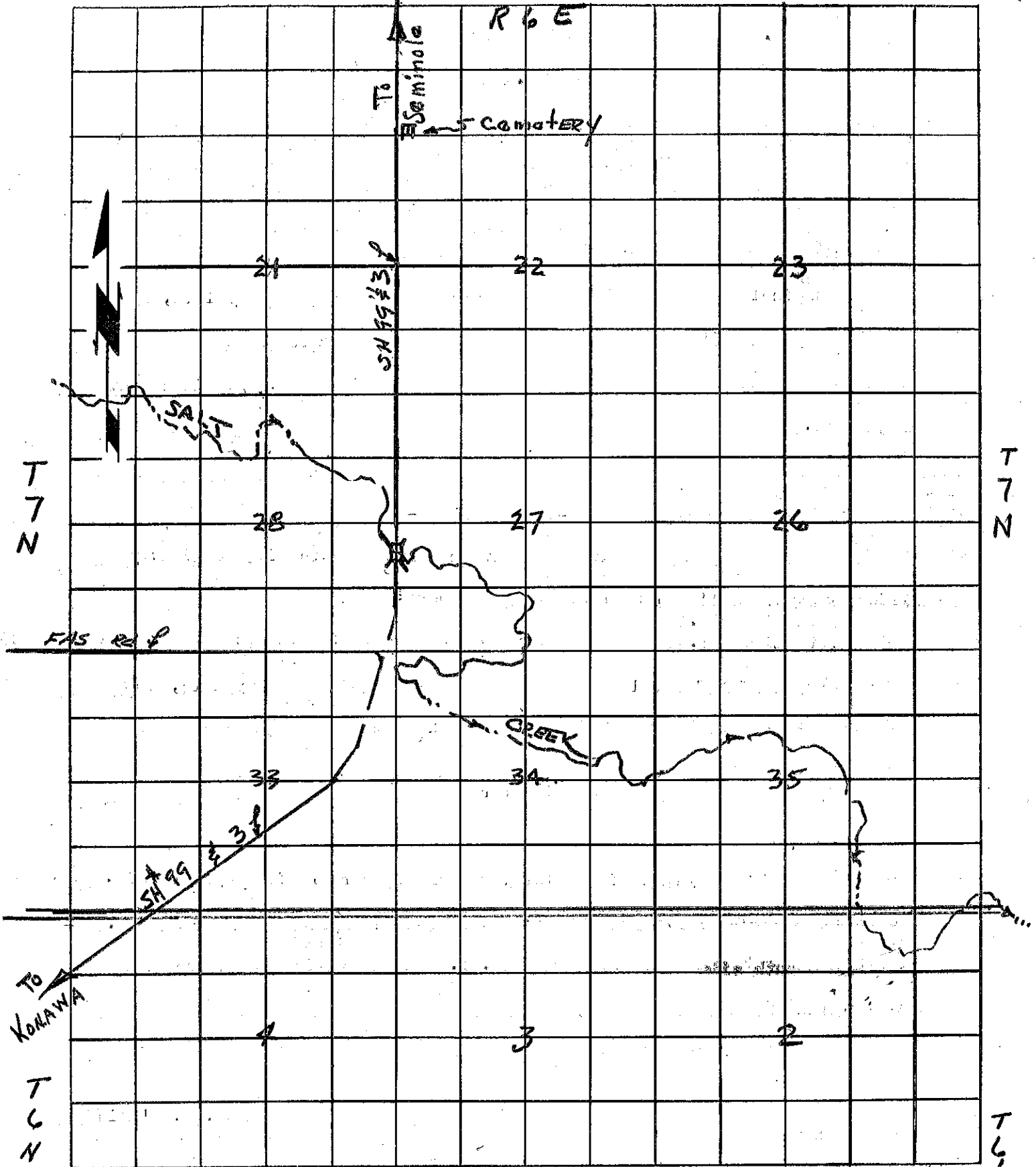

R6E