

STATE OF OKLAHOMA
DEPARTMENT OF HIGHWAYS
SURVEY DIVISION

11-3-70

11-4-70

FLOOD INFORMATION FORM

To be used in obtaining and transmitting flood water elevations for Survey Division office record files. This information to be obtained by all Chiefs of Party or others in their vicinity in times of unusual high water, or at any time available from a reliable source. The elevations can be recorded by level reading, by measurement from bridge floor, in relation to a house, above roadbed or any other dependable, clear manner that fits the situation, the highest order possible to be used. Separate report to be made on each crossing or place obtained.

County SEMINOLE Date highwater occurred OCT. 8TH, 1970

Highway number S.H. 56 Name of stream NONE

Direction and distance from nearest town, village or store APPROX. 3/4 MILE NORTH EAST OF SASAKWA, OKLA. ON S.H. 56

Section, Township and Range SEC. 36 R7E, T6N

Description of Location HIGHWATER MARK WAS OBTAINED AT A 2-10'X8'X RDY. R.C.B. ON S.H. 56 APPROX. 50' NORTH OF FRISCO R.R. TRESTLE APPROX. 3/4 MILE NORTHEAST OF SASAKWA, OKLAHOMA.

Elevation 785.70 Source of levels USC & GS MEAN SEA LEVEL

Method obtained GURLEY ENGINEER LEVEL Date obtained OCT. 9, 1970

Did it appear to be normal medium extreme do not know

Was highwater mark obtained from actual water, drift, local resident, U. S. Engineers, etc.? DRIFT ALONG S.H. 56

Explanatory Remarks THIS HIGHWATER MARK IS 0.5' OVER S.H. 56 AT THIS BOX. APPROX. 12" RAIN FELL IN A 4 HOUR PERIOD ON OCT. 7&8, 1970.

Location to be shown on back of this sheet as a check.

Field Note: To be sent to
Survey Engineer

*FILED FLOOD FILE SEMINOLE Co.
MO. BRIDGE DIV.*

[Signature]
~~XXXXXXXXXX~~
LOCATION ENGINEER
NOV. 2, 1970
Date

LOCATION NO. 6

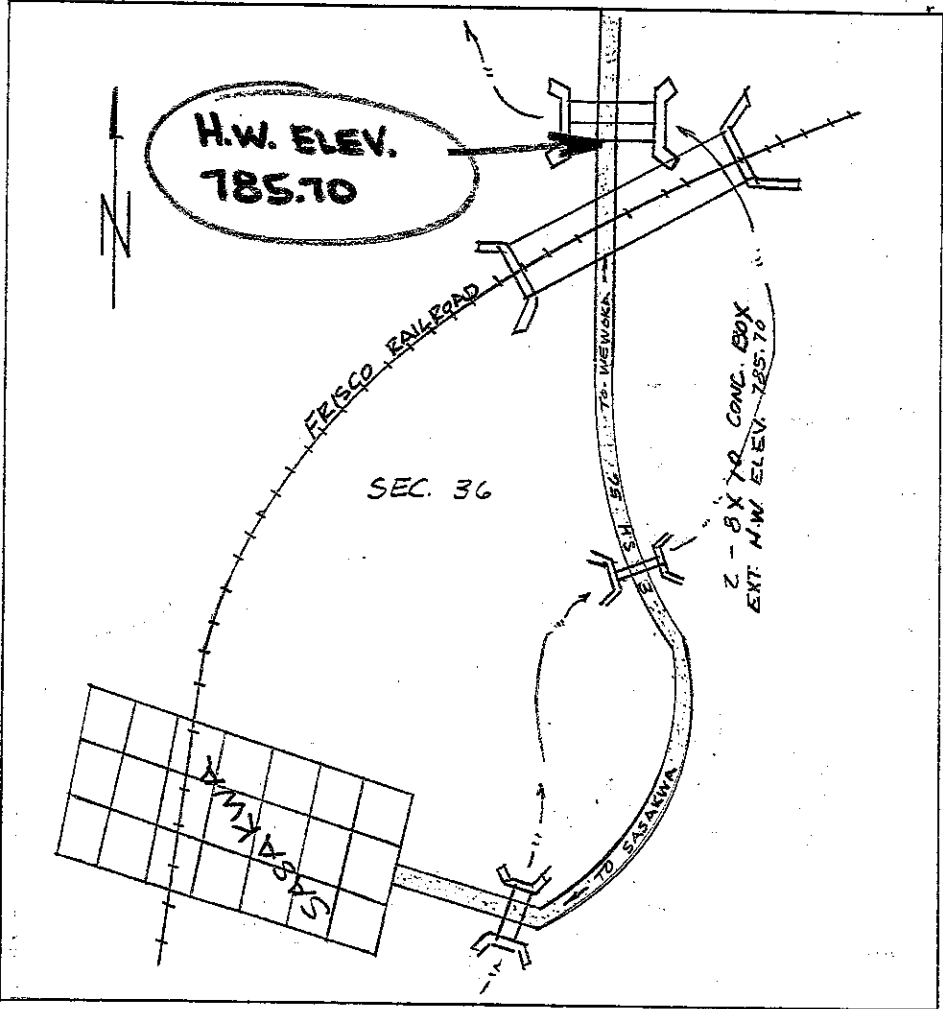

R-7 E

T
6
2