

Plans & Survey Dept.
Form No. 16
Rev. July 10, 1947

STATE OF OKLAHOMA
DEPARTMENT OF HIGHWAYS
PLANS AND SURVEY DEPARTMENT

FLOOD INFORMATION FORM

To be used in obtaining and transmitting flood water elevations for Plans & Survey office record files. This information to be obtained by all Chiefs of Party in their vicinity in times of unusual high water, or at any time available from a reliable source. The elevations can be recorded by level reading, by measurement from bridge floor, in relation to a house, above roadbed or any other dependable, clear manner that fits the situation, the highest order possible to be used. Separate report to be made on each crossing or place obtained.

County Seminole Date highwater occurred July 3, 1948

Highway number #56 Name of stream Little River

Direction and distance from nearest town, village or store From intersection of Broadway & Olive street in Sasakwa, Okla. A Dist. Of 1.6 Miles

Along State Highway #56, Bearing North East.

Section, Township and Range 25 T. 6N R. 7 E.

Description of Location Little River Bridge

Method obtained Ran Elevation From U.S.C.&G.S In Sasakwa Okla.

Elevation 766.05 Source of levels U.S.C. & G.S.

Was highwater mark obtained from actual water, drift, local resident, U. S. Engineers, etc? Drift, And by resident Mr. Sam Capps who has lived in this County for 28 Years.

Explanatory Remarks _____

Location to be shown on back of this sheet as a check.

Field Note: To be sent to Engr. of Plans & Survey (1 copy).
Office Note: To be filed in Flood Information by Counties.

E. J. Leverett
Chief of Party
7-26-1948
Date



R7E

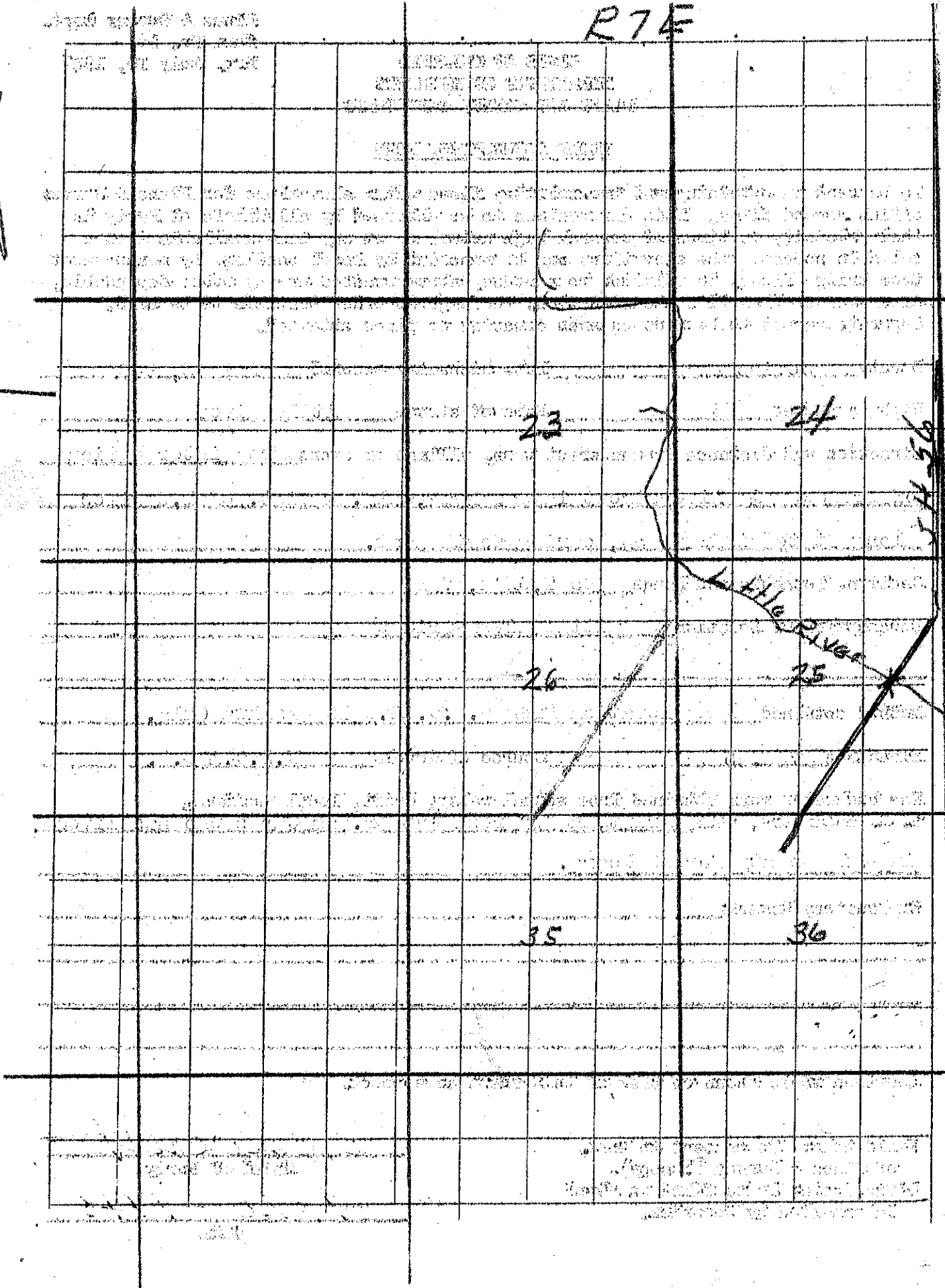

T6N