

✓	WWW	
✓	RLS	10-23-70
	GWP	
✓	OCC	10/26/70
✓	RGC	10-26-70
	GP	
	SDU	
	RDA	
✓	DP	
	IF	

Survey Division
Form No. 16
Rev. Sept. 10, 1961

RECEIVED
OCT 21 1970

SURVEY DIVISION

STATE OF OKLAHOMA
DEPARTMENT OF HIGHWAYS
SURVEY DIVISION

FLOOD INFORMATION FORM

To be used in obtaining and transmitting flood water elevations for Survey Division office record files. This information to be obtained by all Chiefs of Party or others in their vicinity in times of unusual high water, or at any time available from a reliable source. The elevations can be recorded by level reading, by measurement from bridge floor, in relation to a house, above roadbed or any other dependable, clear manner that fits the situation, the highest order possible to be used. Separate report to be made on each crossing or place obtained.

County SEMINOLE Date highwater occurred OCT. 8, 1970

Highway number S.H. 56 Name of stream NO NAME AVAILABLE

Direction and distance from nearest town, village or store APPROX. 2 1/2 MILES SOUTH OF WEWOKA, OKLAHOMA ON S.H. 56 AND APPROX. 465' SOUTH OF N.E. COR. SECTION 6, T-7-N, R-8-E.

Section, Township and Range BETWEEN SECTIONS 5 & 6, T-7-N, R-8-E.

Description of Location HIGHWATER MARK OBTAINED AT A 20'RDY X 44' CONC. BRIDGE ON S.H. 56 APPROX. 465' SOUTH OF N.E. COR OF SEC. 6, T-7-N, R-8-E.

Elevation 836.60 Source of levels USC & GS MEAN SEA LEVEL TAKEN FROM S.W.O. 2863(C) SURVEY.

Method obtained GURLEY ENGINEERS LEVEL Date obtained OCT. 16, 1970

Did it appear to be normal medium extreme do not know

Was highwater mark obtained from actual water, drift, local resident, U. S. Engineers, etc.? H.W. MARK OBTAINED FROM DRIFT AND VERIFIED BY LOCAL RESIDENT, MR. IVEY RT #1, BOX 380, WEWOKA, OKLA.

Explanatory Remarks A 5.7" RAIN FELL DURING A 4 HOUR PERIOD ON OCT. 7 & 8, 1970. THIS HIGHWATER MARK WAS OBTAINED FROM A CLEARLY VISIBLE DRIFT UNDER BRIDGE AND CONFIRMED BY A NEARBY PROPERTY OWNER.

Location to be shown on back of this sheet as a check.

Field Note: To be sent to
Survey Engineer

*FILE: FLOOD FILE, SEMINOLE Co.
MC: BRIDGE DIV.*

Walter Cullen
~~Chief of Party~~
LOCATION ENGINEER
OCT. 16, 1970.
Date

LOCATION NO. 8

R-7-E

R-8-E

RANGE
LINE

Z-0-1

Z-0-1

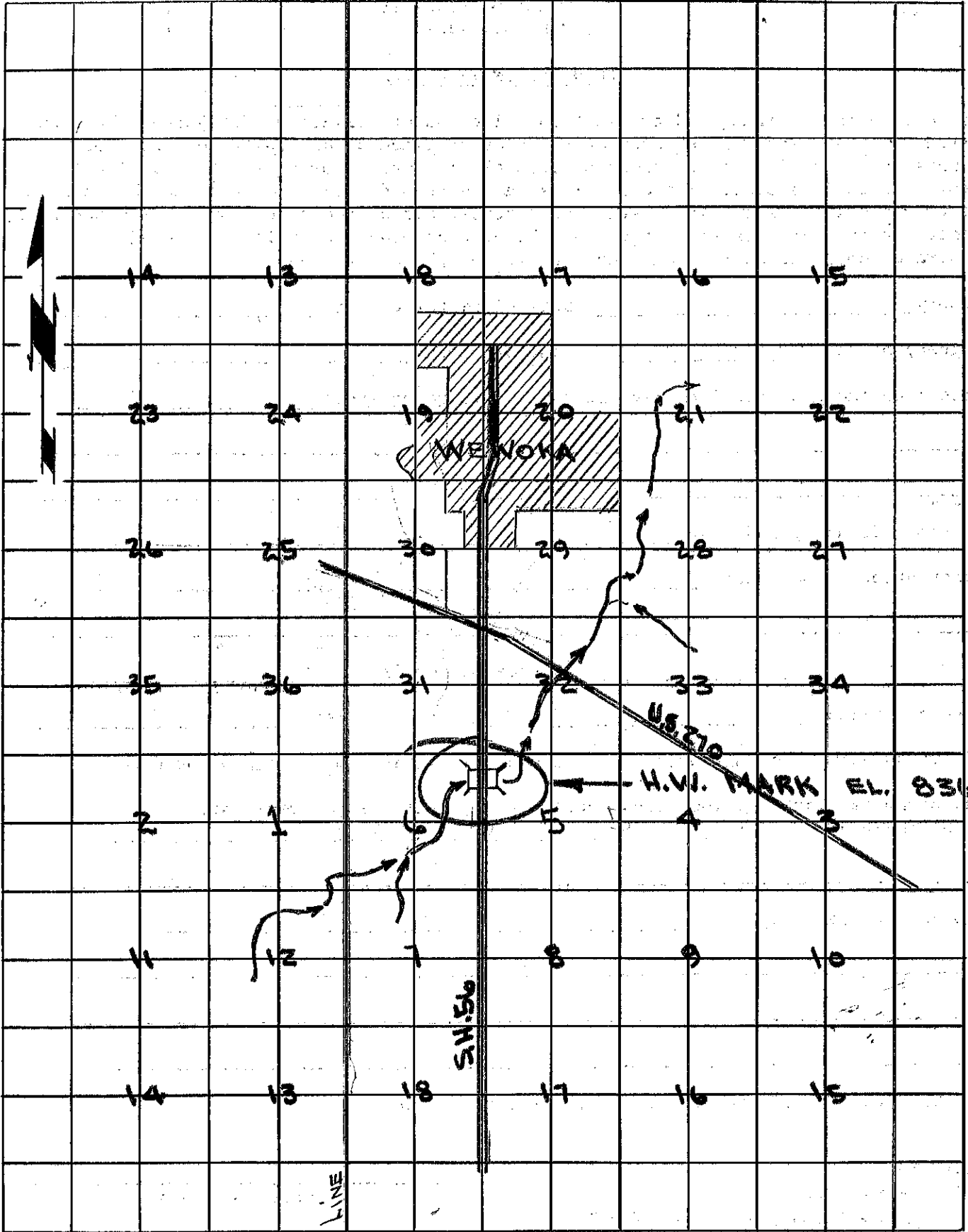

R-7-E

R-8-E

RANGE
LINE

Z-1-1

Z-1-1

OCT. 16, 1970

TO: WILLIAM W. VAUGHAN, SURVEY ENGINEER (ATT. OSCAR C. CURNUTT)
FROM: DEWAYNE WALDEN, LOCATION ENGINEER
SUBJECT: HIGHWATER INFORMATION ON A 20'RDY X 44' CONC. BRIDGE
ON S.H. 56, BETWEEN SECTIONS 5 & 6, T-7-N, R-8-E,
APPROX. 2 1/2 MILES SOUTH OF WEWOKA, OKLAHOMA.

IN RE: TELEPHONE CONVERSATION ON OCT. 16, 1970.

ON OCT. 7 & 8, 1970 HEAVEY RAIN IN THE AMOUNT OF 5.7" FELL DURING A 4 HOUR PERIOD IN THE WEWOKA AREA. THIS INFORMATION WAS RECORDED IN THE WEWOKA TIMES NEWSPAPER DATED OCT. 8, 1970 AND WAS CONFIRMED BY A PROPERTY OWNER NEAR ABOVE MENTIONED BRIDGE. THE PROPERTY OWNER WAS MR. IVEY, RT.#1, BOX 380, WEWOKA, OKLA.

ON OCT. 16, 1970 THIS SURVEY PARTY COMPLETED LEVEL INFORMATION ON THE BRIDGE STRUCTURE AND HIGHWATER. THIS LEVEL INFORMATION AS SHOWN BELOW WAS TAKEN FROM S.W.O. 2863(1) THIRD ORDER LEVEL LINE.

NOTE: NO HIGHWAY PLANS ON S.H. 56 WERE AVAILABLE IN THIS AREA.

Dewayne Walden
DEWAYNE WALDEN
LOCATION ENGINEER

