

STATE OF OKLAHOMA
DEPARTMENT OF HIGHWAYS
SURVEY DIVISION

FLOOD INFORMATION FORM

To be used in obtaining and transmitting flood water elevations for Survey Division office record files. This information to be obtained by all Chiefs of Party or others in their vicinity in times of unusual high water, or at any time available from a reliable source. The elevations can be recorded by level reading, by measurement from bridge floor, in relation to a house, above roadbed or any other dependable, clear manner that fits the situation, the highest order possible to be used. Separate report to be made on each crossing or place obtained.

County SEMINOLE Date highwater occurred OCT. 24, 1983

Highway number SH 99 A Name of stream TURKEY CREEK

Direction and distance from nearest town, village or store FROM THE INTERSECTION OF SH 99 & SH 99 A AT LITTLE OKLA, APPROX. 1.1 MILE WEST.

Section, Township and Range SECTION 8, T10N, R6E

Description of Location 3.3 FEET BELOW BRIDGE SEAT (UPSTREAM) AT EAST END OF BRIDGE

Elevation _____ Source of levels _____

Method obtained ENGRS. LEVEL & LEVEL ROD Date obtained 10-24-83

Did it appear to be normal medium extreme do not know

Was highwater mark obtained from actual water, drift, local resident, U. S. Engineers, etc.? DRIFT IN FENCES.

Explanatory Remarks 10.6 INCHES OF RAIN ON 10-20-83, ON TOP OF 2 INCHES FROM 10-17 TO 10-19-83, IN SHAWNEE OKLA., CAUSING FLOODING AND EVACUATION OF RESIDENTS ALONG NORTH CANADIAN RIVER.

Location to be shown on back of this sheet as a check.

Field Note: To be sent to
Survey Engineer

Jodie R. Pchacek
Chief of Party

12-8-83
Date

Location No. 1A

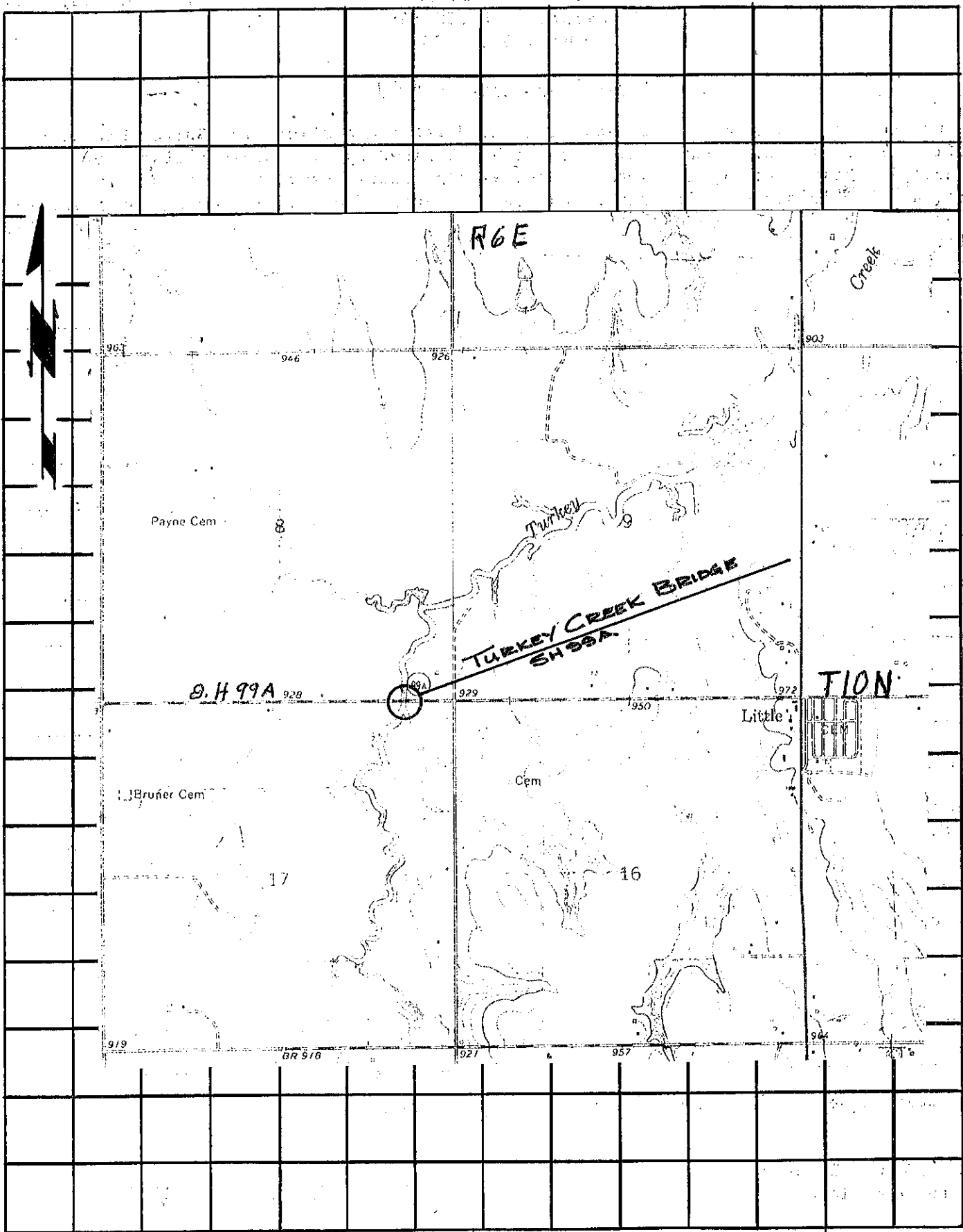

R6E

Creek

Payne Cem

8

TURKEY

TURKEY CREEK BRIDGE
SH 99A

S. H 99A

99A

TION

Bruñer Cem

17

Cem

16

Little

CEM

919

BR 916

927

957

944