

RECEIVED
JUL 12 1984
SURVEY DIVISION

STATE OF OKLAHOMA
DEPARTMENT OF HIGHWAYS
SURVEY DIVISION

Survey Division
Form No. 16
Rev. Sept. 10, 1961

FLOOD INFORMATION FORM

To be used in obtaining and transmitting flood water elevations for Survey Division office record files. This information to be obtained by all Chiefs of Party or others in their vicinity in times of unusual high water, or at any time available from a reliable source. The elevations can be recorded by level reading, by measurement from bridge floor, in relation to a house, above roadbed or any other dependable, clear manner that fits the situation, the highest order possible to be used. Separate report to be made on each crossing or place obtained.

County Rogers Date highwater occurred 5-27-84

Highway number S.H. 33 Name of stream Spunky Creek

Direction and distance from nearest town, village or store 1 mi. south & 1 mi. east of Catoosa, Ok.

Section, Township and Range 32, T-20-N R-15-E

Description of Location 0.9 mi. east of 193rd E. Ave. on S.H. 33

NOTE: THIS IS ON WAGONER & ROGERS CO. LINE.

Elevation 4.6' above S.W. Brdg. seat Source of levels _____

Method obtained Hand level & level rod Date obtained 5-29-84

Did it appear to be normal medium extreme do not know

Was highwater mark obtained from actual water, drift, local resident, U. S. Engineers, etc.? Drift

Explanatory Remarks Water was over SH 33 at this Bridge and for about 300' to the east. Location No. 18 on back of this sheet.

Location to be shown on back of this sheet as a check.

Field Note: To be sent to Survey Engineer

Henry E. Higginbotham
Location Engineer

May 31, 1984
Date

LOCATION NO. 2

**COMM.
DIST.
NO. 1**

86° ST N

76° SE N

66° ST N

56° ST N

46° ST N

36° ST N

APACHE
126° ST N

PINE
115° ST N

R
O
G
E
R
S

STATE OF ARIZONA
COUNTY OF COCHISE

18

11° ST

21° ST

T
19

31° ST

41° ST

51° ST

61° ST

71° ST

81° ST

T
18

91° ST

101° ST

111° ST

121° ST

131° ST

141° ST

C
O
C
H
I
S
E
C
O
U
N
T
Y

R
E
N
E

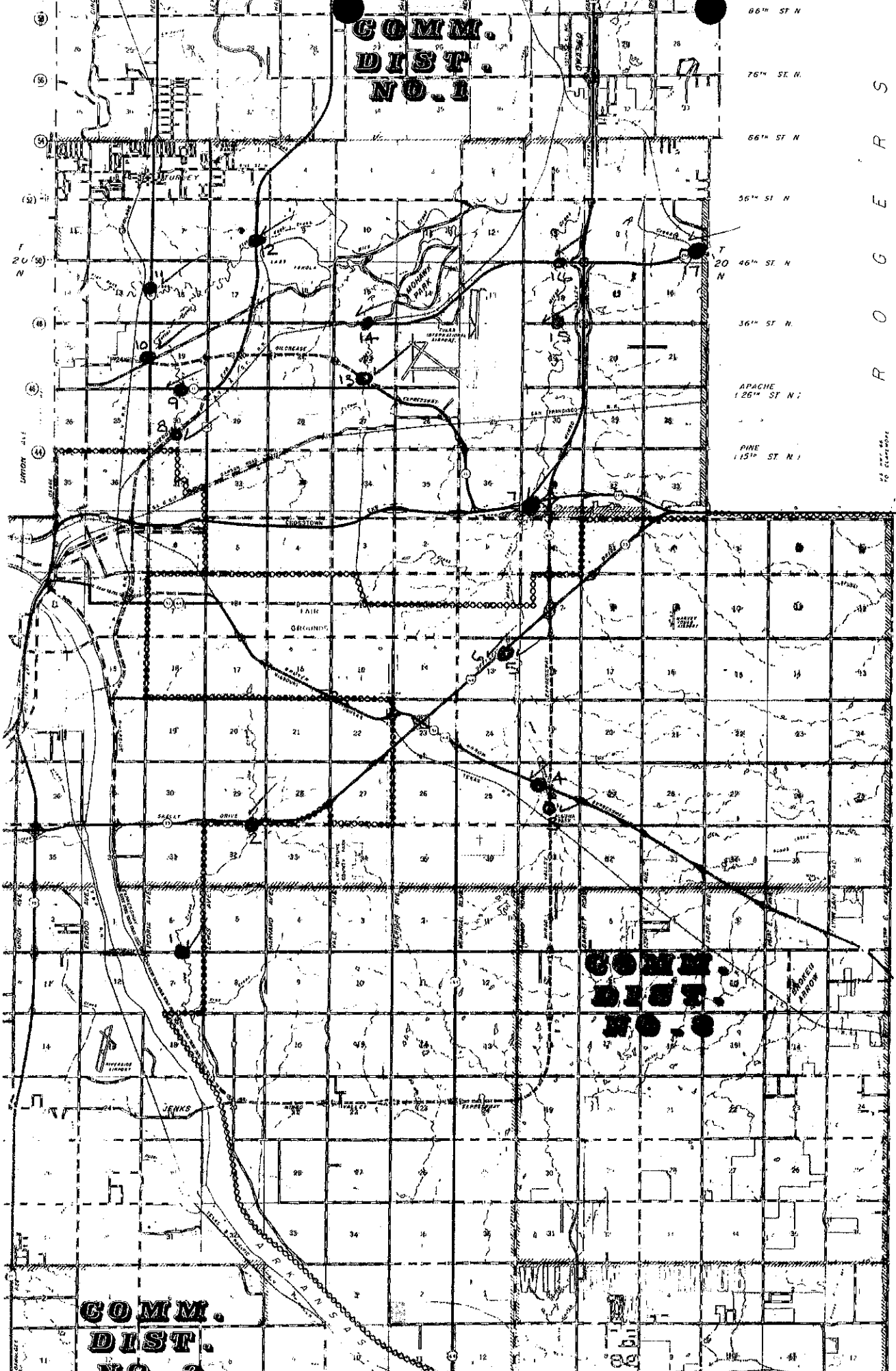

**COMM.
DIST.
NO. 2**