

LOCATION #4
STATE OF OKLAHOMA
DEPARTMENT OF HIGHWAYS
SURVEY DIVISION

FLOOD INFORMATION FORM

Survey Division

Form No. 16

Rev. Dec. 27, 1974

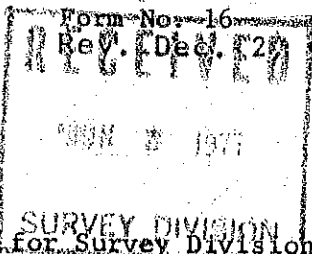

To be used in obtaining and transmitting flood water elevations for Survey Division office record files. This information to be obtained by all Chiefs of Party or others in their vicinity in times of unusual high water, or at any time available from a reliable source. The elevations can be recorded by level reading, by measurement from bridge floor, in relation to a house, above roadbed or any other dependable, clear manner that fits the situation, the highest order possible to be used. Separate report to be made on each crossing or place obtained.

County ROGER MILLS Date highwater occurred 5-17-77

Highway number SH 33 Name of stream WASHITA RIVER

Direction and distance from nearest town, village or store 3 MILES WEST OF HAMMON, OKLAHOMA

Section, Township and Range SECTIONS 4 & 9, T13N, R21W

Description of Location 5.3 FT. BELOW HUBGUARD LT. OF STA. 783+30

Elevation 1723.0 Source of levels F.A.P. # F-371(2) PREP 1/2 PLANS

Method obtained LEVEL Date obtained 5-19-77

Did it appear to be normal medium extreme do not know

Was highwater mark obtained from actual water, drift, local resident, U. S. Engineers, etc.? HIGHWATER MARK ON BRIDGE

Explanatory Remarks A 3" TO 4" RAIN FELL OVERNIGHT ON MAY 16, 1977.

THIS IS NOT EXTREME HIGHWATER.

Location to be shown on back of this sheet as a check.

Field Note: To be sent to
Survey Engineer

Walter Walden
Location Engineer

6-2-77
Date

Location No. 4

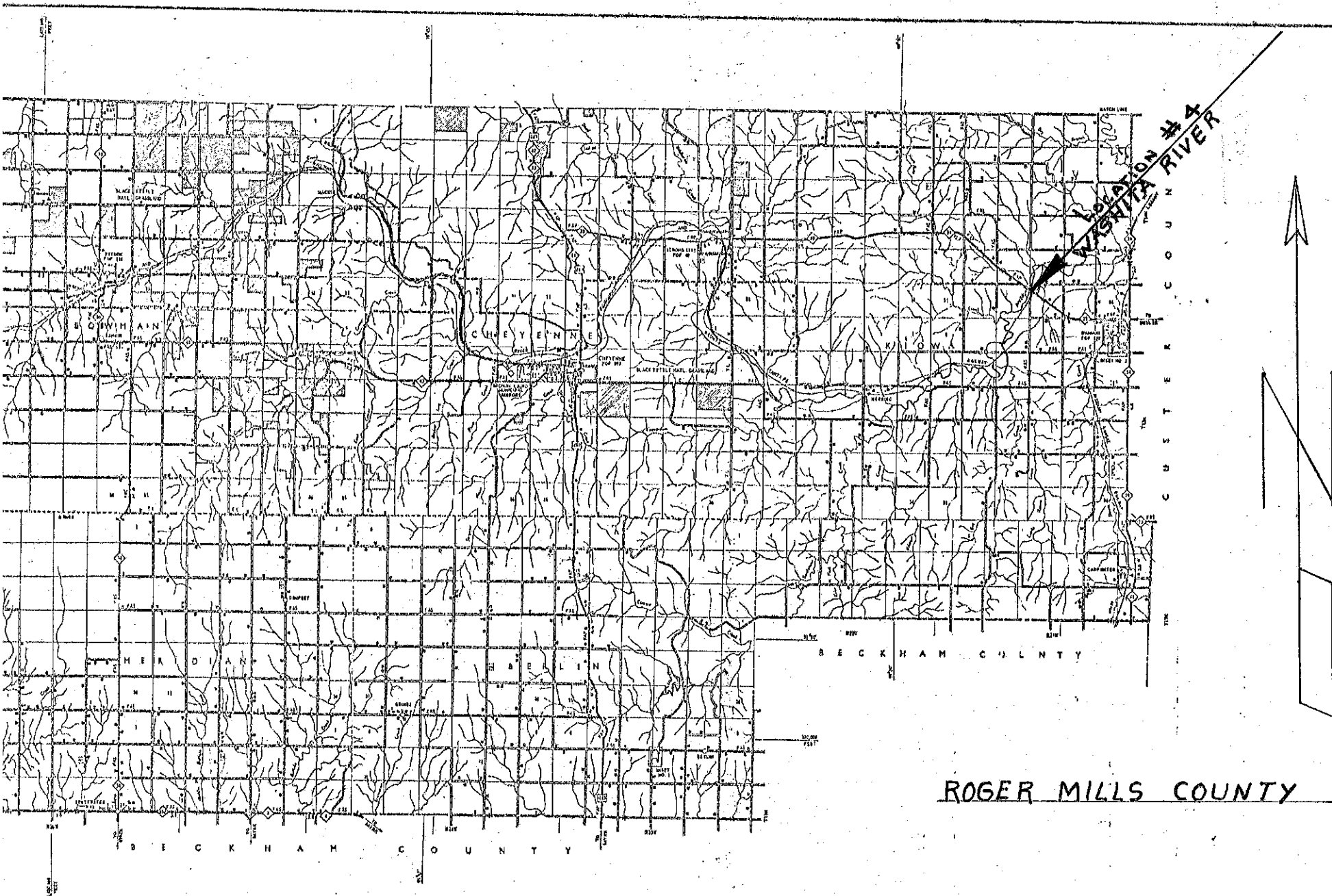

ROGER MILLS COUNTY

POPULATION FIGURES BASED ON 1970 CENSUS
 BOUNDARY FEATURES DERIVED FROM 1965 AERIAL PHOTOGRAPHY
 DATE OF REVISION
 1971
 REVISED BY
 T. L. W. W. C. E.
 ALL DATA SUBJECT TO CHANGE