

STATE OF OKLAHOMA
DEPARTMENT OF HIGHWAYS
SURVEY DIVISION

Survey Division
Form No. 16
Rev. Dec. 2, 1974

FLOOD INFORMATION FORM

To be used in obtaining and transmitting flood water elevations for Survey Division office record files. This information to be obtained by all Chiefs of Party or others in their vicinity in times of unusual high water, or at any time available from a reliable source. The elevations can be recorded by level reading, by measurement from bridge floor, in relation to a house, above roadbed or any other dependable, clear manner that fits the situation, the highest order possible to be used. Separate report to be made on each crossing or place obtained.

County ROGER MILLS Date highwater occurred MAY 9, 1993

Highway number S.H. 33 Name of stream WASHITA RIVER

Direction and distance from nearest town, village or store 0.5 MILE EAST OF
STRONG CITY, OKLAHOMA ALONG S.H. 33

Section, Township and Range SECTION 24 T-14-N, R-23-W

Description of Location DRIFT & H.W. MARK 8.0 BELOW BRIDGE SEAT

Elevation 1577.7 Source of levels S.A.P. NO. 829
S.H. 33 1932 PLANS

Method obtained HAND GUN Date obtained MAY 11, 1993

Did it appear to be normal medium extreme do not know

Was highwater mark obtained from actual water, drift, local resident,
U. S. Engineers, etc.? DRIFT & H.W. MARK

Explanatory Remarks 2.5 " RAIN FELL IN A 2 DAY PERIOD

Location to be shown on back of this sheet as a check.

Field Note: To be sent to
Survey Engineer

G. D. Stratten
PROFESSIONAL LAND SURVEYOR

Date

COPY TO BRIDGE

LOCATION No. 7 MAY 14 1993

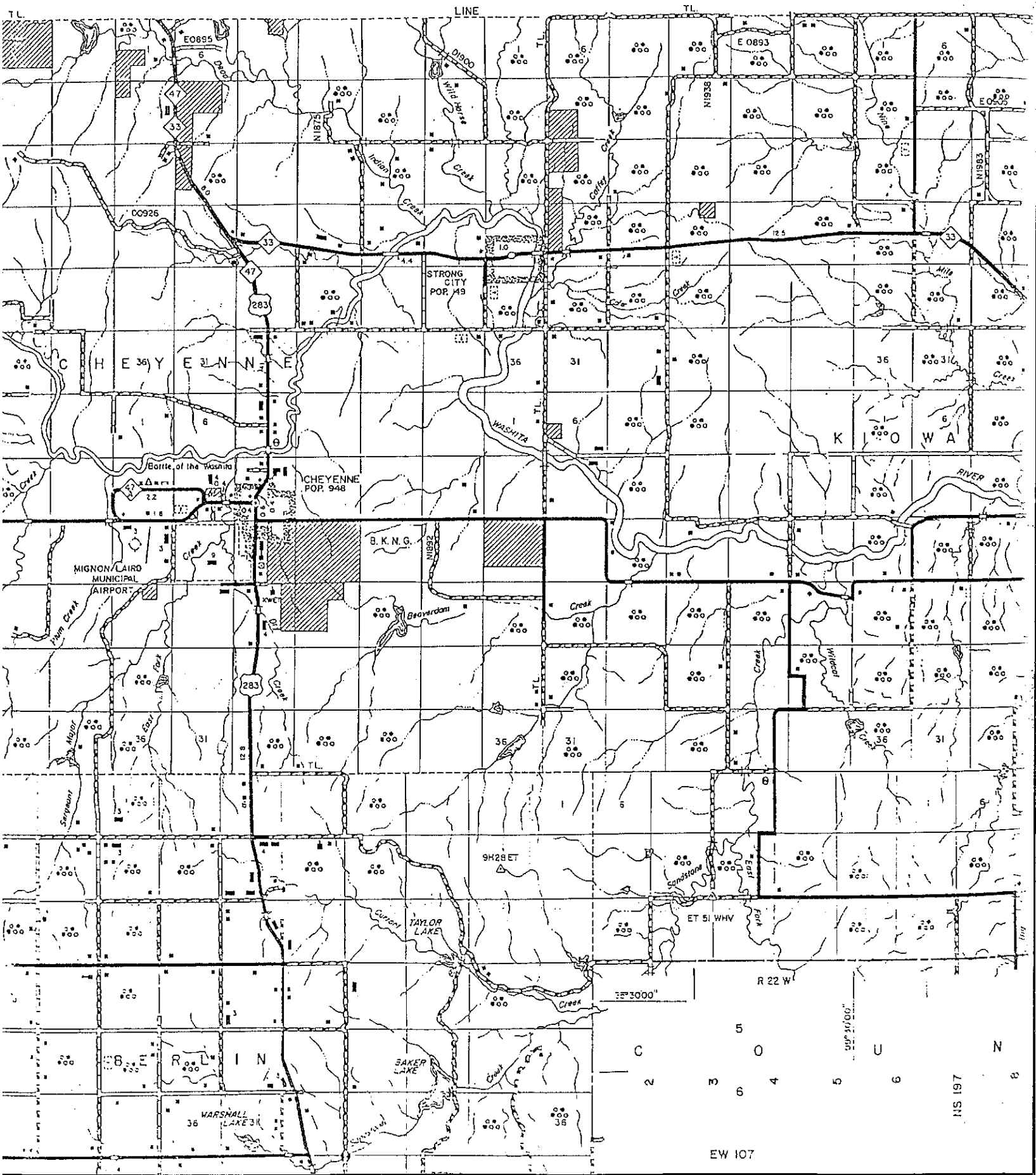

3

4

6

7

8

9

0

2

3

4

5

6

8

8