

STATE OF OKLAHOMA  
DEPARTMENT OF HIGHWAYS  
SURVEY DIVISION

FLOOD INFORMATION FORM

To be used in obtaining and transmitting flood water elevations for Survey Division office record files. This information to be obtained by all Chiefs of Party or others in their vicinity in times of unusual high water, or at any time available from a reliable source. The elevations can be recorded by level reading, by measurement from bridge floor, in relation to a house, above roadbed or any other dependable, clear manner that fits the situation, the highest order possible to be used. Separate report to be made on each crossing or place obtained.

County Pottawatomie Date highwater occurred May 13, 1968

Highway number Future US # 177 Name of stream Unknown

Direction and distance from nearest town, village or store 1.0 Miles West and 1/2 Mile South of Pearson or Jct SH # 59 and SH # 177. station 1477 + 17.0 on SWO 2360 (1) and FAP F-289(9) Plan Alignment - Future SH 177

Section, Township and Range West Side Section 19 T 7 N R 1 E

Description of Location Highwater Obtained at the Existing Wood Bridge on North and South Section Line Road, At the South End of Wood Bridge Floor, at station 1477 + 17.0 on FAP F-289(9) Plan Alignment On Future SH 177

Elevation 909.50 Source of levels Mean Sea Level USC&GS Obtained From SWO 2360 (1) & FAP F-289(9) Plan Align.

Method obtained Engineers Fennel Dumpy Level Date obtained May 20, 1968  
And By Field Survey

Did it appear to be  normal  medium  extreme  do not know

Was highwater mark obtained from actual water, drift, local resident, U. S. Engineers, etc.? Drift

Explanatory Remarks They were Approx. 6.0 Inches of Rain Fall in 2.0 Hours

Soil Conservation has Plans for a Flood Control Dam on this Stream.

Location to be shown on back of this sheet as a check.

Field Note: To be sent to  
Survey Engineer

Harold Furr  
Chief of Party

July 9, 1968  
Date  
Truett McCarty  
Location Engr.  
July 11th, 1968

**LOCATION NO. 1**

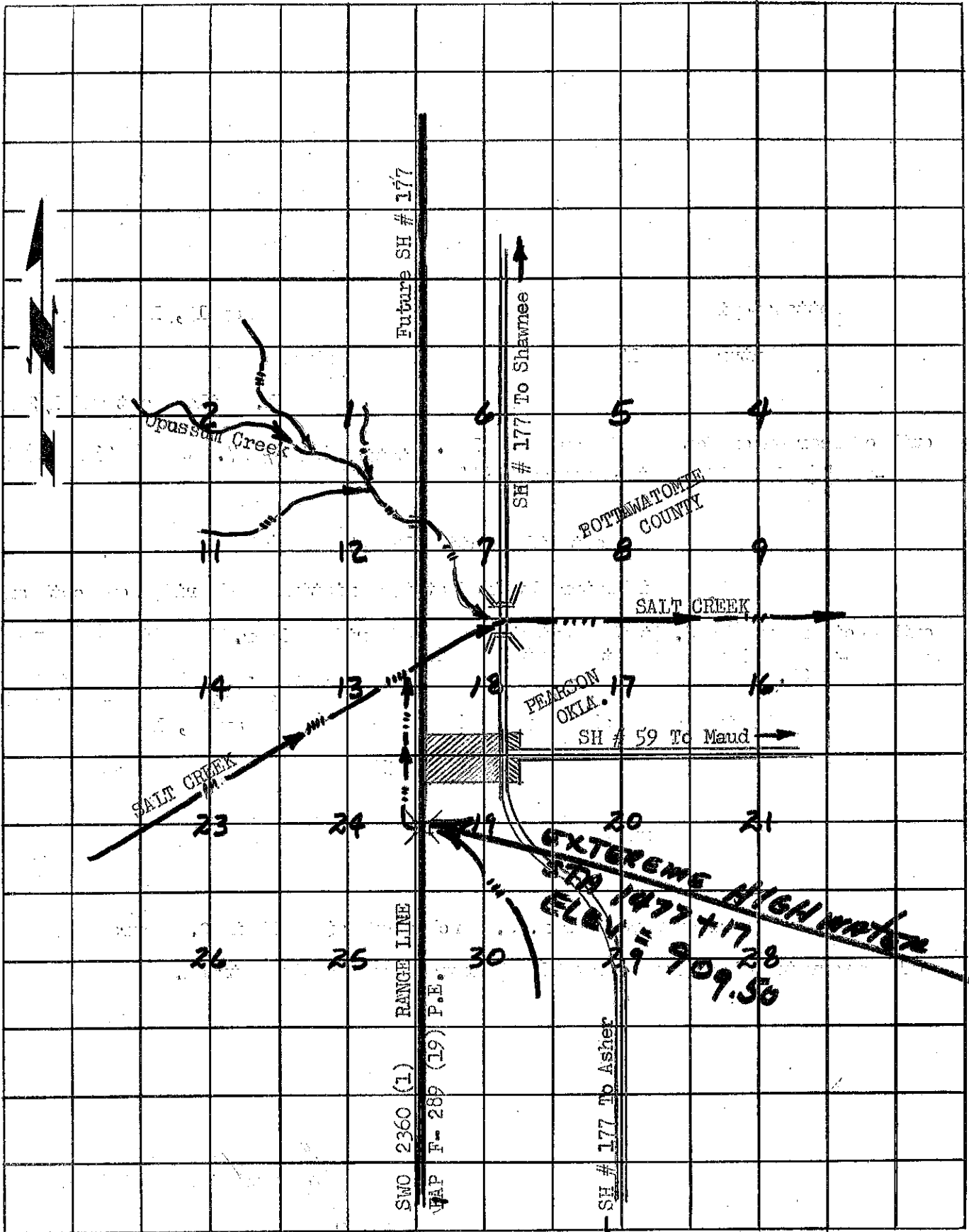

T 7 N

T 7 N

R 3 E

R 4 E