

STATE OF OKLAHOMA  
DEPARTMENT OF HIGHWAYS  
SURVEY DIVISION

FLOOD INFORMATION FORM

To be used in obtaining and transmitting flood water elevations for Survey Division office record files. This information to be obtained by all Chiefs of Party or others in their vicinity in times of unusual high water, or at any time available from a reliable source. The elevations can be recorded by level reading, by measurement from bridge floor, in relation to a house, above roadbed or any other dependable, clear manner that fits the situation, the highest order possible to be used. Separate report to be made on each crossing or place obtained.

County Pottawatomie Date highwater occurred May 13, 1968

Highway number Future ~~US~~ # 177 Name of stream Unkonwn

Direction and distance from nearest town, village or store 1 Mile West of Jet of

SH # 59 and ~~US~~ # 177 in Pearson. Station 1500 + 00 on SWO 2360 (1) Survey, FAP F-289(9)  
Plan Alignment On A Gravel Traveled County Road And Future SH 177

Section, Township and Range Top Section 19 T 7 N R 4 E

Description of Location Highwater Obtained at the Section Corner on Gravel Road,

N.W. Corner of Section 19 T7N R3-4E On Existing Gravel Traveled County Road And Future SH 177.

Elevation 901.10 Source of levels Mean Sea level USC&GS Obtained From  
SWO 2360 (1) Survey, FAP F-289(9) Plans

Method obtained Engr. Fennel Dumpy Level Date obtained July 9, 1968  
And By Field Survey.

Did it appear to be  normal  medium  extreme  do not know

Was highwater mark obtained from actual water, drift, local resident,  
U. S. Engineers, etc.? Drift

Explanatory Remarks Soil Conservation has Plan for a Flood Control Dam on this

Stream. Approx. 6.0 Inches of Rain Fall in 2 Hours

Location to be shown on back of this sheet as a check.

Field Note: To be sent to  
Survey Engineer

Harold Furr  
Chief of Party

July 9, 1968  
Date  
Truett McCarty  
Truett McCarty - Location Engr.  
July 11th, 1968 **LOCATION NO. 2**

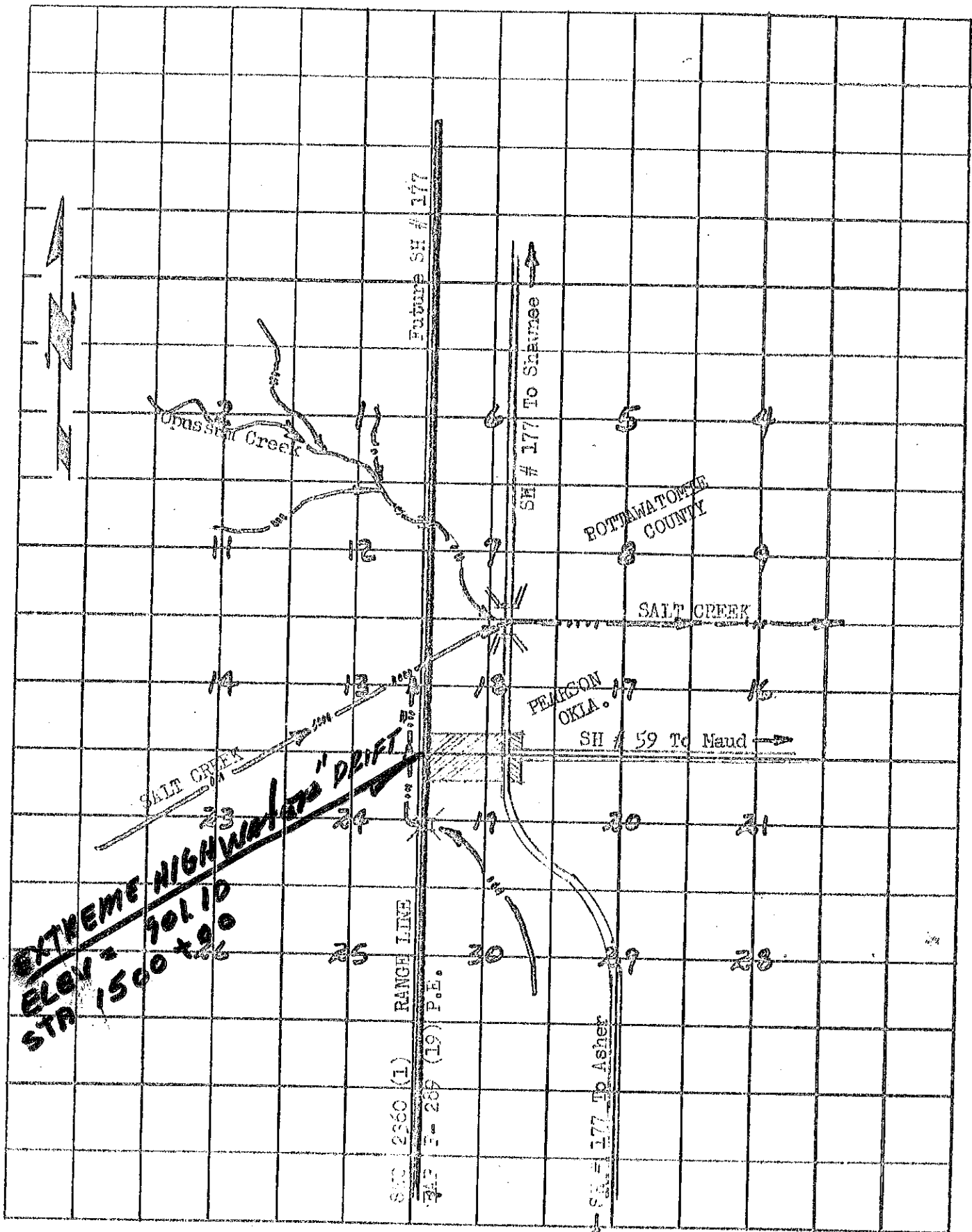

T 7 N

T 7 N

R 3 E

R 4 E