

STATE OF OKLAHOMA
DEPARTMENT OF HIGHWAYS
SURVEY DIVISION

Survey Division
Form No. 16
Rev. Sept. 10, 1961

FLOOD INFORMATION FORM

To be used in obtaining and transmitting flood water elevations for Survey Division office record files. This information to be obtained by all Chiefs of Party or others in their vicinity in times of unusual high water, or at any time available from a reliable source. The elevations can be recorded by level reading, by measurement from bridge floor, in relation to a house, above roadbed or any other dependable, clear manner that fits the situation, the highest order possible to be used. Separate report to be made on each crossing or place obtained.

County Pottawatomie Date highwater occurred May 13, 1968

Highway number Future US # 177 Name of stream Salt Creek

Direction and distance from nearest town, village or store 1.0 Miles West and 3/4 Miles North of Pearson, Station 1523 + 00 on SWO 2360 (1) Survey And FAP F-289(9) Plan Alignment On Future SH 177

Section, Township and Range West Side of Section 18 T 7 N R 4 E

Description of Location Approx. 600 Feet South of Salt Creek in E & W 1/4 Section Line Fence

Elevation 891.90 Source of levels Mean Sea Level USC&GS Obtained From AWO 2360 (1) Survey, FAP F-289(9) Plans

Method obtained Engr. Fennel Dumpy Level Date obtained July 9, 1968
And By Field Survey

Did it appear to be normal medium extreme do not know

Was highwater mark obtained from actual water, drift, local resident, U. S. Engineers, etc.? Drift Left Of Station 1523 + 00 ON FAP F-289(9) Plan Alignment.

Explanatory Remarks Due to the Flood Control Dam on Salt Creek the Water Didn't Get AS high as Before. Approx. 6.0 Inches of Rain Fall in 2 Hours.

Location to be shown on back of this sheet as a check.

Field Note: To be sent to
Survey Engineer

Harold Furr
Chief of Party

July 9, 1968
Date
Truett McCarty
Truett McCarty - Location Engr.
July 11th, 1968 LOCATION NO. 3

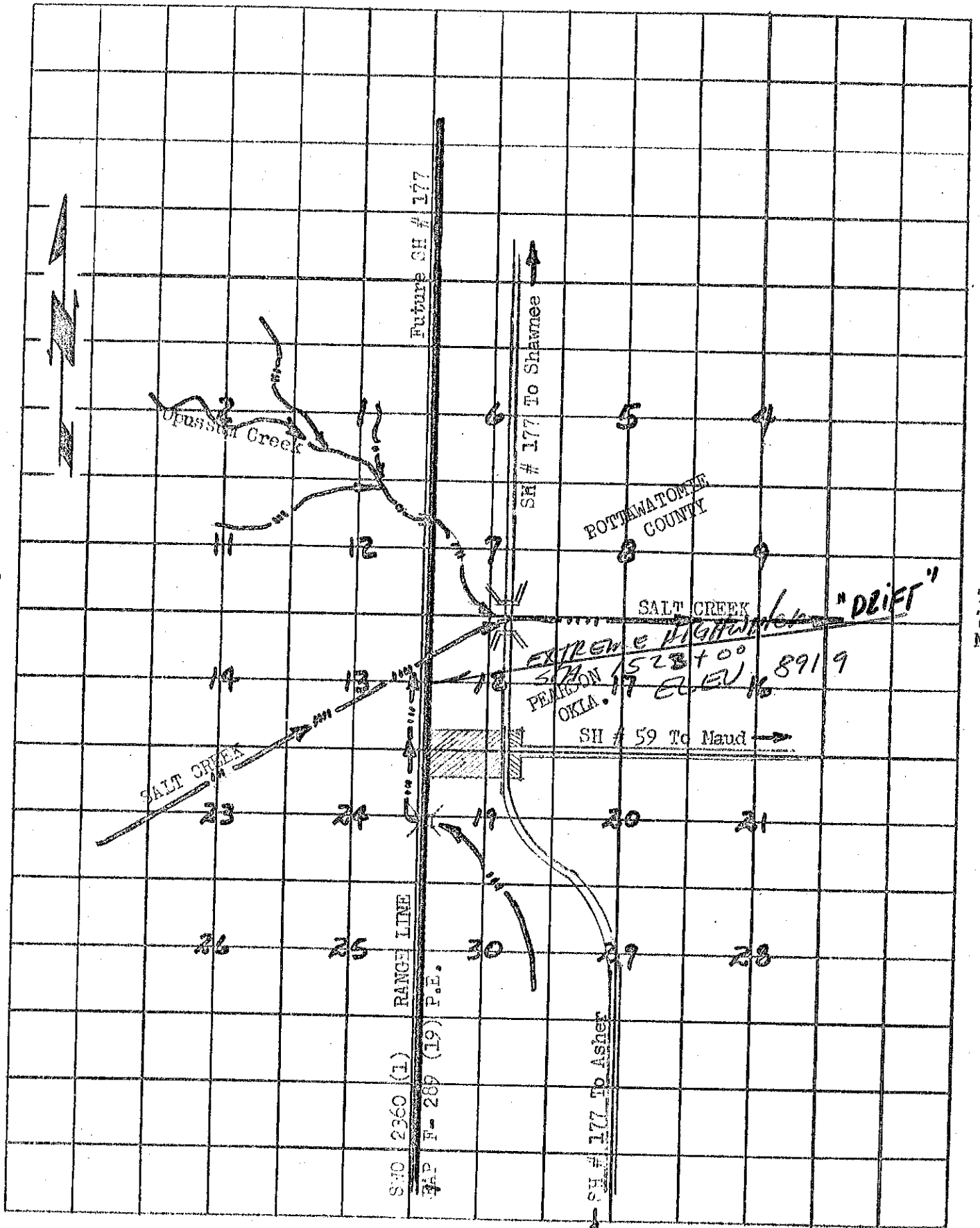

T 7 N

T 7 N

R 3 E

R 4 E