

STATE OF OKLAHOMA
DEPARTMENT OF HIGHWAYS
SURVEY DIVISION

Survey Division
Form No. 16
Rev. Sept. 10, 1961

FLOOD INFORMATION FORM

To be used in obtaining and transmitting flood water elevations for Survey Division office record files. This information to be obtained by all Chiefs of Party or others in their vicinity in times of unusual high water, or at any time available from a reliable source. The elevations can be recorded by level reading, by measurement from bridge floor, in relation to a house, above roadbed or any other dependable, clear manner that fits the situation, the highest order possible to be used. Separate report to be made on each crossing or place obtained.

County Pottawatomie Date highwater occurred May 13, 1968

Highway number Future US # 177 Name of stream Salt Creek

To Reach This Location Travel
Direction and distance from nearest town, village or store 2.0 Miles North and 3/4 Miles

West and 1.0 Miles South of Pearson. Station 1515 + 38 on SWO 2360 (1) Survey, Future SH 177

NOTE: This Location Is 1.5. Miles North/And 3/4 Miles West Of Pearson.

Section, Township and Range Bottom Section 7 T 7 N R 1 E

Description of Location Approx 600 Feet South of Section Corner, Section 7 T7N R3-1E

Elevation 891.00 Source of levels Mean Sea Level USC&GS Obtained From

Method obtained Engr. Fennel Dumpy Level Date obtained July 9, 1968
SW)O 2360(1) Survey

And By Field Survey.
Did it appear to be normal medium extreme do not know

Was highwater mark obtained from actual water, drift, local resident, U. S. Engineers, etc.? Drift and Ring on Tree

Explanatory Remarks 6.0 Inches of Rain Fall in 2 Hours. Due to the Flood Control Dam the Water Didn't Get As High as Before.

Location to be shown on back of this sheet as a check.

Field Note: To be sent to Survey Engineer

Paul Furr
Chief of Party
July 9, 1968
Date
Truett McCarty
Location Engr.
July 11th, 1968
LOCATION NO. 6

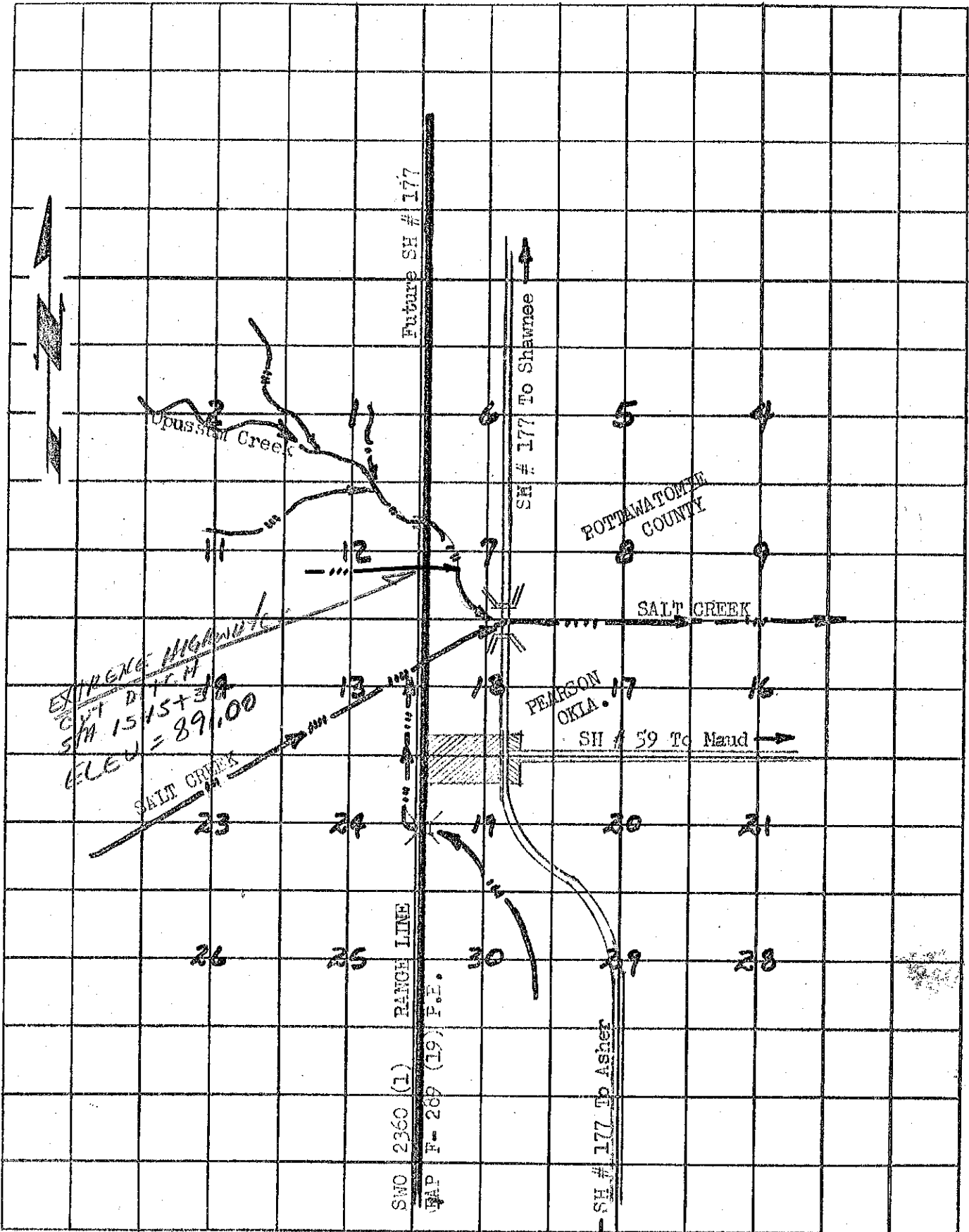

T 7 N

T 7 N

R 3 E

R 4 E