

SURVEY DIVISION	
✓ GHS	MAY 28 1968
WWV	6-17-68
WVM	6-17-68
GWP	
✓ OCC	6-24-68
GER	
SDD	
RDA	
HFJ	
GSS	

STATE OF OKLAHOMA
DEPARTMENT OF HIGHWAYS
SURVEY DIVISION

RECEIVED
Survey Division
Form No. 16
Rev. Sept. 10, 1961
MAY 27 1968
SURVEY DIVISION

FLOOD INFORMATION FORM

To be used in obtaining and transmitting flood water elevations for Survey Division office record files. This information to be obtained by all Chiefs of Party or others in their vicinity in times of unusual high water, or at any time available from a reliable source. The elevations can be recorded by level reading, by measurement from bridge floor, in relation to a house, above roadbed or any other dependable, clear manner that fits the situation, the highest order possible to be used. Separate report to be made on each crossing or place obtained.

County Pottawatomie ✓ Date highwater occurred May 13, 1968

Highway number US 177 Name of stream Little River

Direction and distance from nearest town, village or store Approx. 7.0 miles North of Pearson on SH 177

Section, Township and Range Section 7 T 8 N R 4 E

Description of Location Highwater Obtained At The Existing Bridge Across Little River on SH 177 Approx. 7.0 Miles North Of Pearson, Oklahoma.

Elevation N. A. Source of levels _____

Method obtained Eng. Level Date obtained May 20, 1968

Did it appear to be normal medium extreme do not know

Was highwater mark obtained from actual water, drift, local resident, U. S. Engineers, etc.? Drift

Explanatory Remarks Medium Highwater 8.6 Below the East End of the South East Wingwall on the existing Bridge. Approx. 7.0 miles North of Pearson.

Section 7 T 8 N R 4 E

Location to be shown on back of this sheet as a check.

Field Note: To be sent to Survey Engineer

David J. Turner
Chief of Party

May 20, 1968

Date LOCATION NO. 8

SWO 2360(V)
SAP 63(3) G.V.Dr
We are Parallel stream -

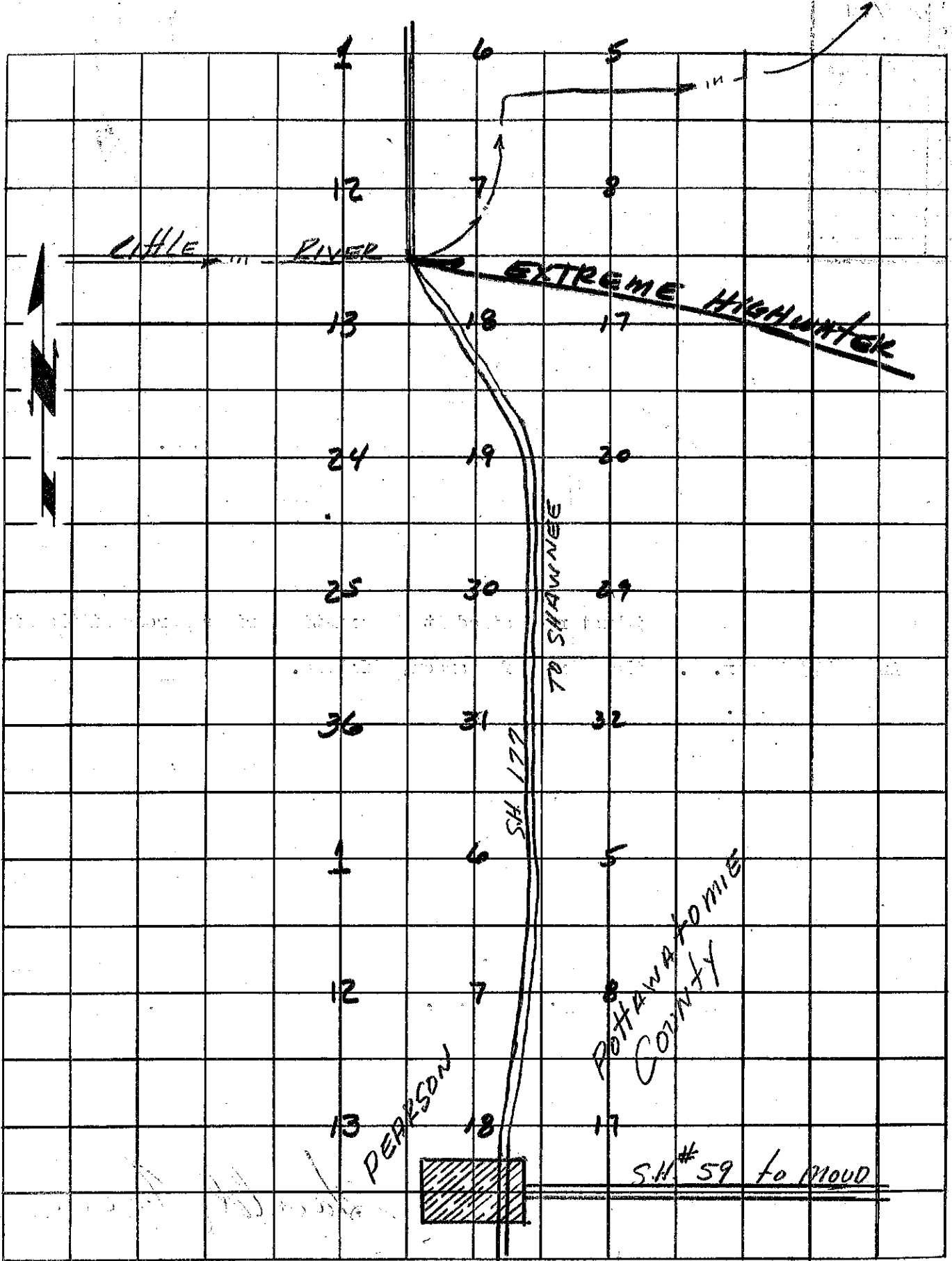

T
8
N

T
7
N

R 3 E

R 4 E

1 6 5
12 7 8
13 18 17
24 19 20
25 30 29
36 31 32
1 6 5
12 7 8
13 18 17

SHAWNEE
TO
SHAWNEE

SH 177

PEPPERSON

POTAWATOMIE
COUNTY

S.H. #59 to MOOD

