

STATE OF OKLAHOMA
DEPARTMENT OF HIGHWAYS
SURVEY DIVISION

FLOOD INFORMATION FORM

To be used in obtaining and transmitting flood water elevations for Survey Division office record files. This information to be obtained by all Chiefs of Party or others in their vicinity in times of unusual high water, or at any time available from a reliable source. The elevations can be recorded by level reading, by measurement from bridge floor, in relation to a house, above roadbed or any other dependable, clear manner that fits the situation, the highest order possible to be used. Separate report to be made on each crossing or place obtained.

County POTTAWATOMIE Date highwater occurred OCT 20, 1983

Highway number COUNTY ROAD Name of stream NORTH CANADIAN RIVER

Direction and distance from nearest town, village or store FROM THE INTERSECTION OF I-40 & SH 18 NORTH OF SHAWNEE OKLA. APPROX 1.5 MILES NORTH AND 2.0 MILES EAST.

Section, Township and Range SECTION 27, T-11-N, R-4-E

Description of Location 0.9 FEET BELOW TIMBER FLOOR AT WEST END OF BRIDGE

Elevation 943.5 Source of levels S.W.O. 3531(1) SURVEY

Method obtained ENGRS. LEVEL & LEVEL ROD Date obtained OCT 24, 1983

Did it appear to be normal medium extreme do not know

Was highwater mark obtained from actual water, drift, local resident, U. S. Engineers, etc.? DRIFTS ALONG SECTION LINE ROAD WEST OF BRIDGE

Explanatory Remarks WEST END OF EXISTING BRIDGE WASHED OUT, 10.6 INCHES OF RAIN ON 10-20-83, ON TOP OF 2 INCHES OF RAIN ON 10-17-TO 10-19-83, CAUSING FLOODING AND EVACUATION OF RESIDENTS.

NOTE: OKLA. CITY SET A 24 HOUR RECORD WITH 8.9 INCHES OF RAIN AT 4 P.M. ON 10-20-83.

Location to be shown on back of this sheet as a check.

Field Note: To be sent to
Survey Engineer

Jodie R. Pichauk
Chief of Party

12-8-83
Date

Copy to Bridge 12-22-83
SWP

LOCATION NO. 16

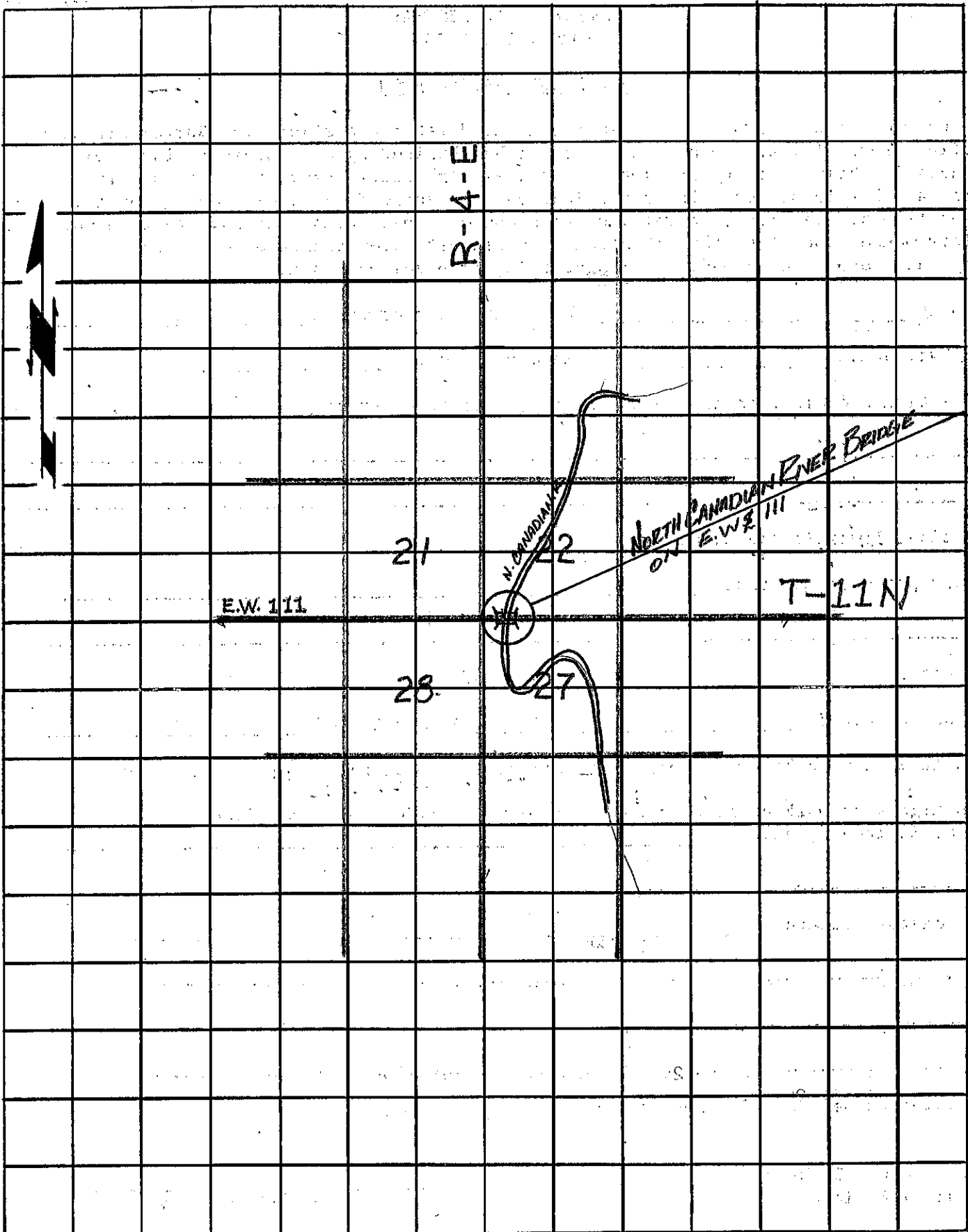

R-4-E



21

22

NORTH CANADIAN RIVER BRIDGE
ON E.W. III

E.W. 111

T-11N

28

27

N. CANADIAN

