

STATE OF OKLAHOMA
DEPARTMENT OF HIGHWAYS
SURVEY DIVISION

FLOOD INFORMATION FORM

To be used in obtaining and transmitting flood water elevations for Survey Division office record files. This information to be obtained by all Chiefs of Party or others in their vicinity in times of unusual high water, or at any time available from a reliable source. The elevations can be recorded by level reading, by measurement from bridge floor, in relation to a house, above roadbed or any other dependable, clear manner that fits the situation, the highest order possible to be used. Separate report to be made on each crossing or place obtained.

County PONTOTOC Date highwater occurred 5-3-90

Highway number S.H. 48 Name of stream SINCERE CREEK

Direction and distance from nearest town, village or store _____

APPROX. 5 3/4 MILES NORTH OF LULA

Section, Township and Range BETWEEN SECTIONS 26 & 27, T-4-N, R-8-E.

Description of Location AT STA. 27+81.50 ON F.A.S. -S-45(2) PLANS

Elevation 722.00 Source of levels F.A.S.-S-45(2) PLANS

Method obtained HAND LEVEL AND LEVEL ROD Date obtained 5-10-90

Did it appear to be normal medium extreme do not know

Was highwater mark obtained from actual water, drift, local resident, U. S. Engineers, etc.? _____

DRIFT

Explanatory Remarks HEAVY RAINS IN UPPER DRAINAGE AREA.

Location to be shown on back of this sheet as a check.

Field Note: To be sent to
Survey Engineer

MC: Bridge Division
(5-18-90)

John Wayne Garland
~~XXXXXXXXXXXX~~
PROF. LAND SURVEYOR
5-17-90
Date

Copy to Bridge Div. 7-11-90

Location No. 7

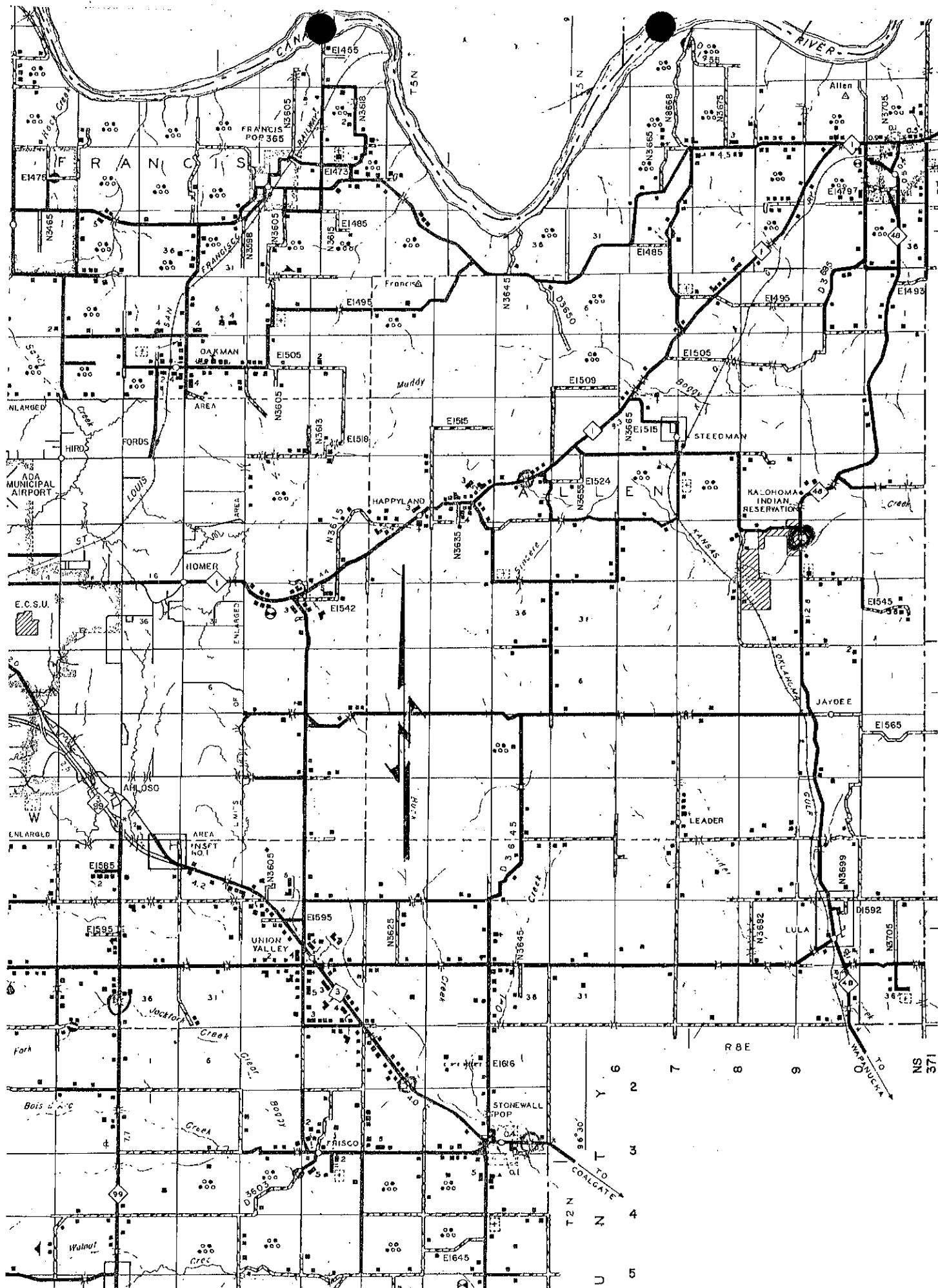

TO COALGATE
T 2 N
U 5
T 3 N
T 4 N
T 5 N
R 8 E
R 9 E
NS 371