

RECORDED
Plans & Survey Dept.
Form No. 16
Rev. July 10, 1947

STATE OF OKLAHOMA
DEPARTMENT OF HIGHWAYS SEP 29 1959
PLANS AND SURVEY DEPARTMENT

FLOOD INFORMATION FORM DEPARTMENT

To be used in obtaining and transmitting flood water elevations for Plans & Survey office record files. This information to be obtained by all Chiefs of Party in their vicinity in times of unusual high water, or at any time available from a reliable source. The elevations can be recorded by level reading, by measurement from bridge floor, in relation to a house, above roadbed or any other dependable, clear manner that fits the situation, the highest order possible to be used. Separate report to be made on each crossing or place obtained.

County Payne Date highwater occurred Sept. 25, 1959

Highway number SH 40 Name of stream Stillwater Creek

Direction and distance from nearest town, village or store Approx. 1/4 mile south of the south edge of Stillwater on SH 40.

Section, Township and Range Approx between Sections 23 & 26, T19N, R2E.

Description of Location At the bridge over Stillwater Creek on SH 40 about 1/4 mile south of the South edge of Stillwater, Okla.

Method obtained Hand Level

Elevation Down 5.9 from North Bridge Seat of Bridge
~~source of elevation~~

Was highwater mark obtained from actual water, drift, local resident, U. S. Engineers, etc? From water marks on bridge and drift

Explanatory Remarks This is not an extreme high water and the high water was considerable higher in about June of 1959. The high water mark from this earlier high water was still plainly visible on the bridge and was down 4.0 from the north bridge seat.

Location to be shown on back of this sheet as a check.

Field Note: To be sent to Engr. of Plans & Survey (1 copy).
Office Note: To be filed in Flood Information by Counties.

Carroll D. Son
Chief of Party
Carroll D. Son
Sept. 28, 1959
Date

LOCATION No. 4

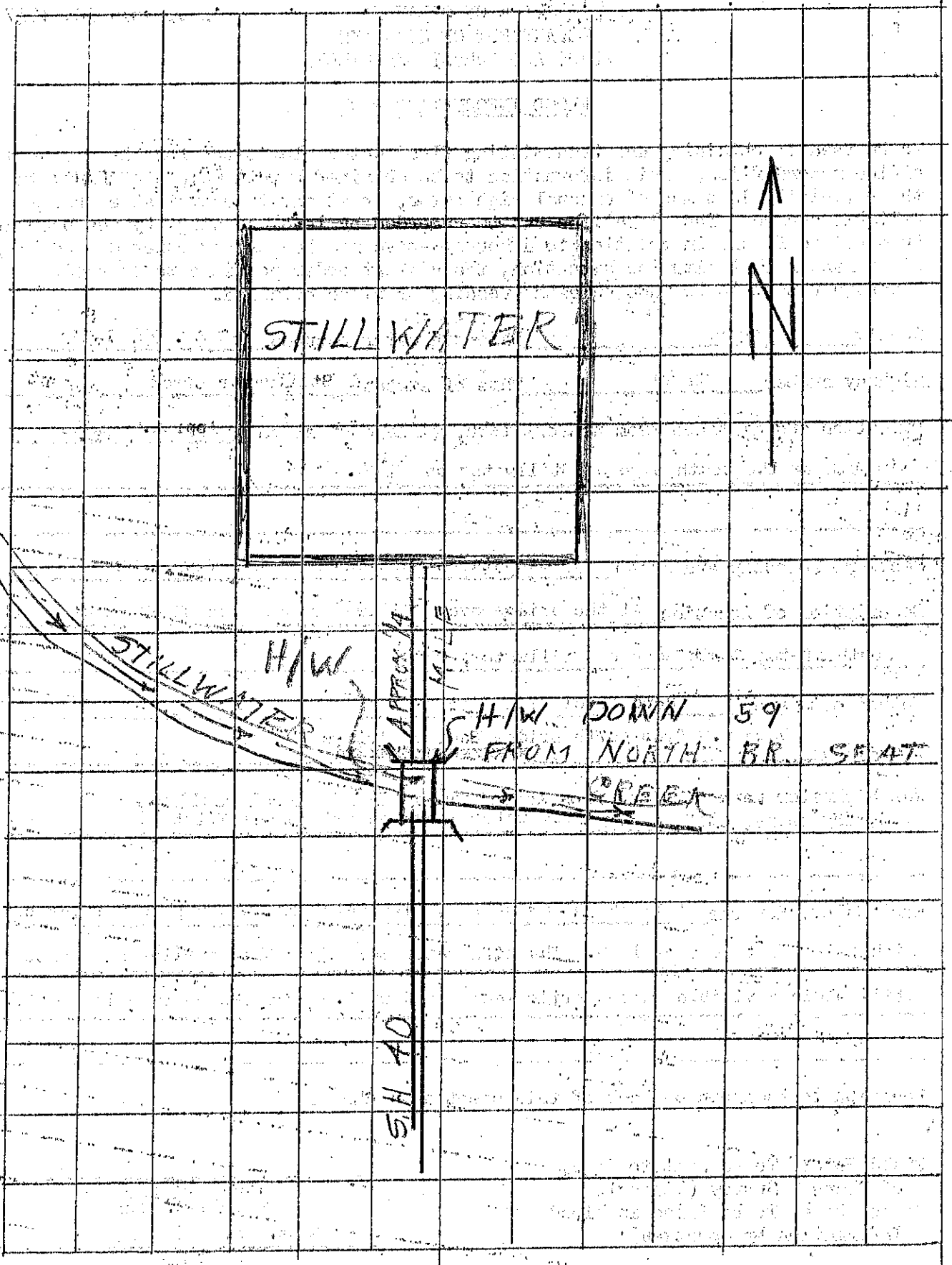

STILL WATER



STILLWATER

H/W

APPROX. 1/2 MILE

H/W DOWN 59 FROM NORTH BR. SE AT CREEK

S.H. 40